

BND STEALTH
MIG/MAG UNIVERSAL SYSTEM



Welding Tools for the Professional

A Smart Approach

Parker Torchology is shaped by people with vision, a passion for improvement and a belief in delivering the very best Welding and Cutting Torch Range in the World.

We expect a great deal from our products, so we ask a lot of ourselves and our engineers.

Our mantra: **Innovation, Technology, Performance.**



DNA

Design and Engineering excellence are at the core of everything we do.

Every torch we build is driven by our relentless pursuit of perfection.

Premium Features

At Parker Torchology we do things differently, we strive to solve your problems with the perfect product to suit your needs. We create smart product features encased in cutting-edge design to ensure you always have the best tools to hand.





Production

A fusion of precision production engineering, our bespoke processing techniques and a fanatical attention to detail ensures every welding torch we produce is worthy of the Parker Torchology name.

Testing, Testing, Testing

It takes patience to develop a new product, it's a lot more than a great idea.

Product development is an iterative process, trying something over and over, changing one small variable at a time.

We build endless prototypes and test pieces that undergo months of rigorous testing. Only once a product has passed up to 88 different test procedures, with every single part tested separately do we consider our latest designs ready for market.

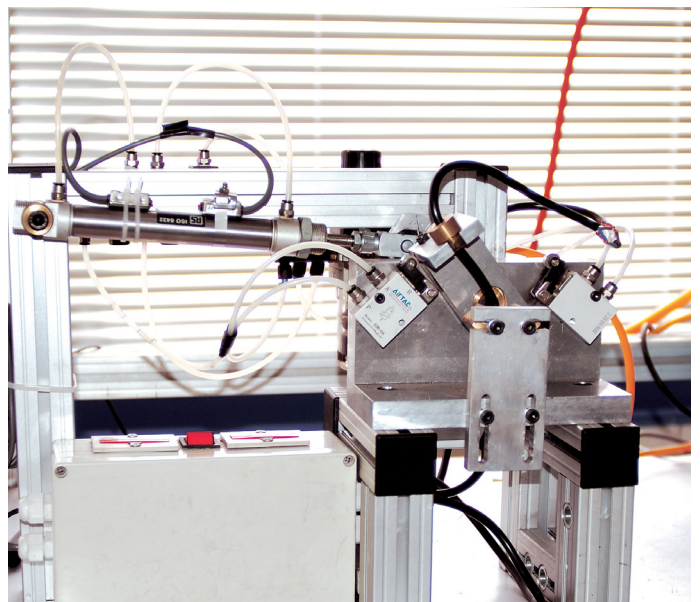

Partners

Our customers and business partners play a vital role in our development. With the core aim to strive together, we work with end-users, distributors and academic institutions alike.

As a result we share fundamental values in order to succeed in our respective market places, supporting economic growth and collaborative opportunities with others.

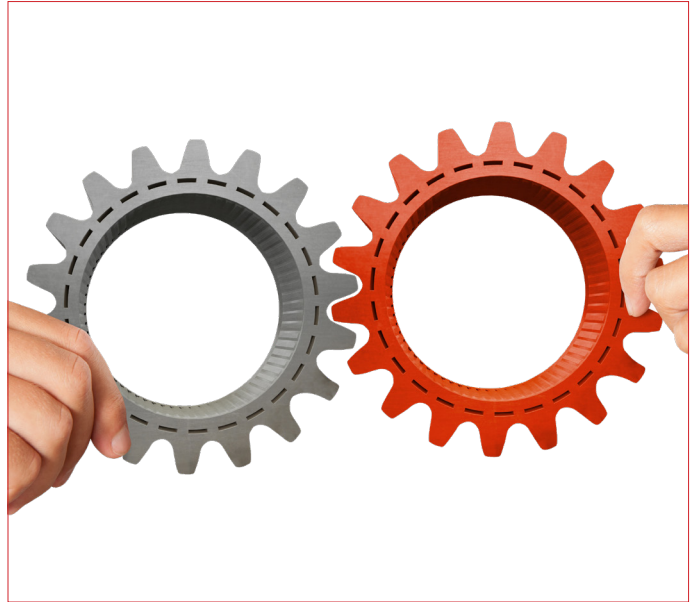

A Bright Future

Technology doesn't stand still, which is why we are constantly innovating to bring you the best products on the market.

Our strong vision and focused innovation strategy, not to mention our passion to revolutionize the industry, ensure that Parker Torchology is a byword for excellence.

We Talk Torches

Contents

BND Stealth Mig/Mag Torch Range Features Focus	6
BND Stealth Mig/Mag Torch Range Overview and Ratings	7

Torch Range

Air-Cooled

BN200	8
BN300	9
BN350	10
BN400	11

Wear Parts

Nozzles	12
Contact Tips	13
Diffusers	13
Liners	14

Rear-End Spare Parts	15
-----------------------------	----

Direct Plug Connector Kits	16
-----------------------------------	----

BND Mig/Mag Torch Range

Air-Cooled Features Focus

The traditional North American BND Series developed for high performance in heavy industrial environments.

Air-Cooled

Welding Tools for the Professional



100% Bernard® Compatibility Guaranteed

Quality Wear Parts

All wear parts are manufactured to the same specification as the original manufacturer ensuring reliability, longevity and superior performance

- Contact tips are manufactured from premium grade copper alloys; we don't sacrifice performance by using low end or recycled raw materials
- The correct specification of raw material type, surface finish, tensile strength and the coiling technology utilized to form the liner are all essential elements in achieving the correct manufacture of a liner

Superior Flexibility and Durability

Every detail has been considered to ensure the welder has the very best handling in all positions

- Improved balance and positionability with the addition of a knuckle joint which enables small movements of the handle and neck independently of the cable assembly

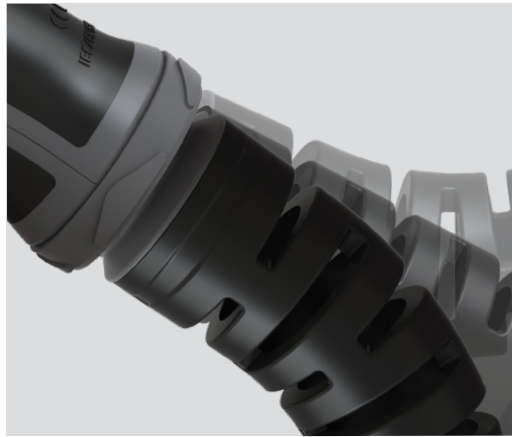

Terminations

A comprehensive range of USA style terminations ensures worldwide compatibility.



The Smart Way To Buy Welding and Cutting Tools

BND Stealth Mig/Mag Torch Range

Ratings: 150 Amp to 270 Amp, Mixed Gas M21



Model	BN200	BN300	BN350	BN400
Technical Data				
Cooling Method	Air-Cooled	Air-Cooled	Air-Cooled	Air-Cooled
Rating: CO ₂	180A	230A	260A	320A
Rating: Mixed Gas M21	150A	200A	230A	270A
Duty Cycle	60%	60%	60%	60%
Wire Size	0.8-1.2	0.8-1.2	0.8-1.2	0.8-1.2

	10ft	PST-BN200-10AD	PST-BN300-10AD	PST-BN350-10AD	PST-BN400-10AD
Order Codes	12ft	PST-BN200-12AD	PST-BN300-12AD	PST-BN350-12AD	PST-BN400-12AD
	15ft	PST-BN200-15AD	PST-BN300-15AD	PST-BN350-15AD	PST-BN400-15AD

BN200 Stealth Mig/Mag Torch Range

Rating: 180A CO₂, 150A mixed gas M21, EN60974-7 @ 60% duty cycle. 0.8 to 1.2mm / 0.023-0.045" wires

Air-Cooled Mig Welding Torch

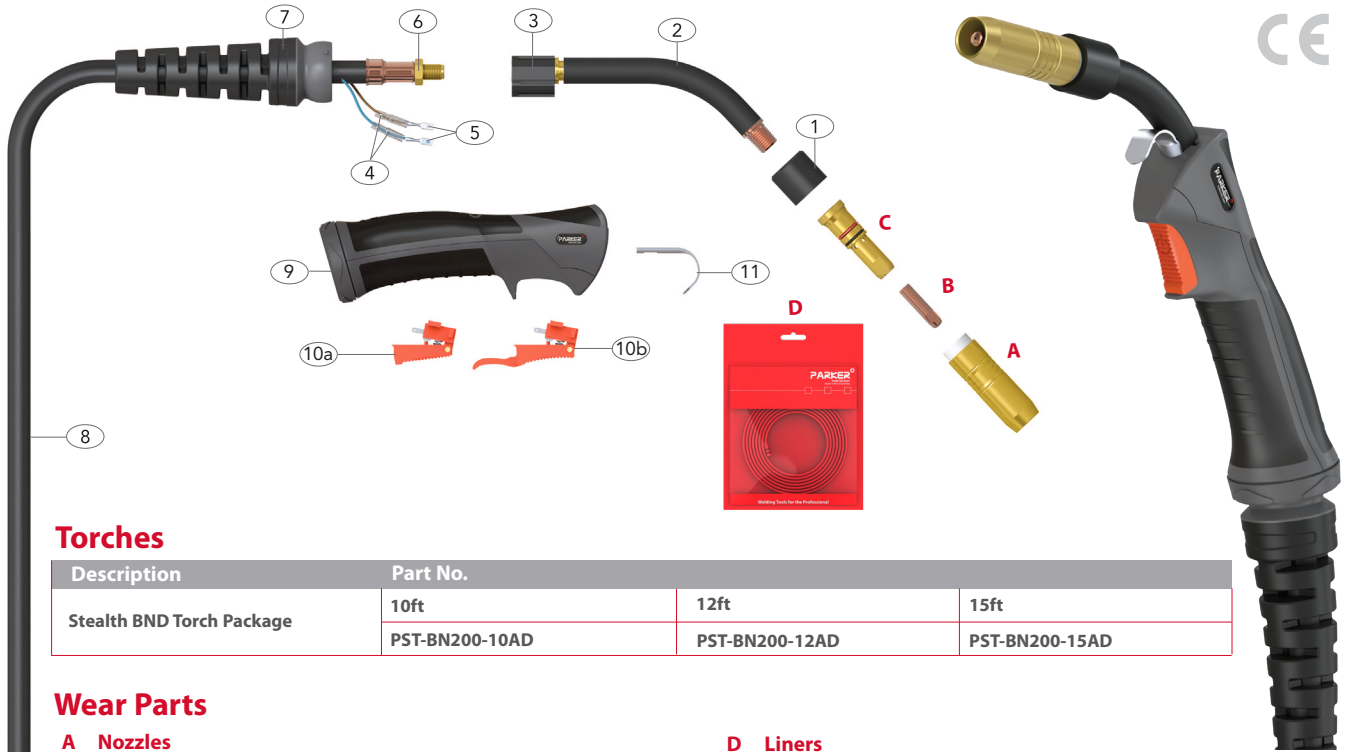

Torches

Description	Part No.		
Stealth BND Torch Package	10ft	12ft	15ft
	PST-BN200-10AD	PST-BN200-12AD	PST-BN200-15AD

Wear Parts

A Nozzles

Part No.	Description	Bore	Wall	Material
P4391	Conical Nozzle	16.0	2.85mm	Brass
*P4392	Tapered Nozzle	12.7	2.85mm	Brass
P4393	HD Conical Nozzle	16.0	2.85mm	Copper
P4295	Pipeline Nozzle	9.5	2.85mm	Brass

B Contact Tips

Part No.	Description	Material	Wire Size	
			mm	inch
P1588	Contact Tip	Ecu	0.8	0.030
P1589	Contact Tip	Ecu	0.9	0.035
P1590	Contact Tip	Ecu	1.2	0.045
P1596	Contact Tip	Ecu	1.0	0.040
P4281	Contact Tip	Ecu	0.9	0.035
P4282	Contact Tip	Ecu	1.2	0.045
P4285	Contact Tip	Ecu	0.8	0.030
P7488	Contact Tip	Ecu	0.8	0.030
P7489	Contact Tip	Ecu	0.9	0.035
*P7490	Contact Tip	Ecu	1.2	0.045
P7496	Contact Tip	Ecu	1.0	0.040

C Diffuser

Part No.	Description	Material
*P4335	Head Assembly	Brass

D Liners

Part No.	Description	Length	Wire Size	
			mm	inch
*PA43110	Steel Liner x 10ft	3.80mt	0.8-1.2	0.030-0.045
*PA43115	Steel Liner x 15ft	4.90mt	0.8-1.2	0.030-0.045
PA43125	Steel Liner x 15ft	8.10mt	0.8-1.2	0.030-0.045
PN43110	Steel Liner x 10ft	3.80mt	0.8-1.2	0.030-0.045
PN43115	Steel Liner x 15ft	4.90mt	0.8-1.2	0.030-0.045
PN43125	Steel Liner x 15ft	8.10mt	0.8-1.2	0.030-0.045

Spare Parts

Part No.	Description
1 P4323R	Rubber Cap
2 PLS-BN200	Swan Neck
3 PG1515	Ergo Handle Location Body
4 PB1521-C	Cable Terminal Cover
5 PB1521	Cable Terminal
6 PB1505	Lock Nut
7 PG8015	Handle Cable Support c/w Ball Joint
8 PSTH-8681TE	Cable Assembly x 10ft
PSTH-8682TE	Cable Assembly x 12ft
PSTH-8685TE	Cable Assembly x 15ft
9 SGB2514	Handle And Lock Nut Assembly
10a DGB2516	Standard Trigger Assembly
10b DGB2516L	Extended Trigger Assembly
11 PB2517	Hanger Hook

*Denotes torch package standard wear part set-up
For more information please refer to the following sections:
• Master Wear Parts Table Page 12-14
• Rear-End / Cable Parts Page 15

BN300 Stealth Mig/Mag Torch Range

Rating: 230A CO₂, 200A mixed gas M21, EN60974-7 @ 60% duty cycle. 0.8 to 1.2mm / 0.023-0.045" wires

Air-Cooled Mig Welding Torch

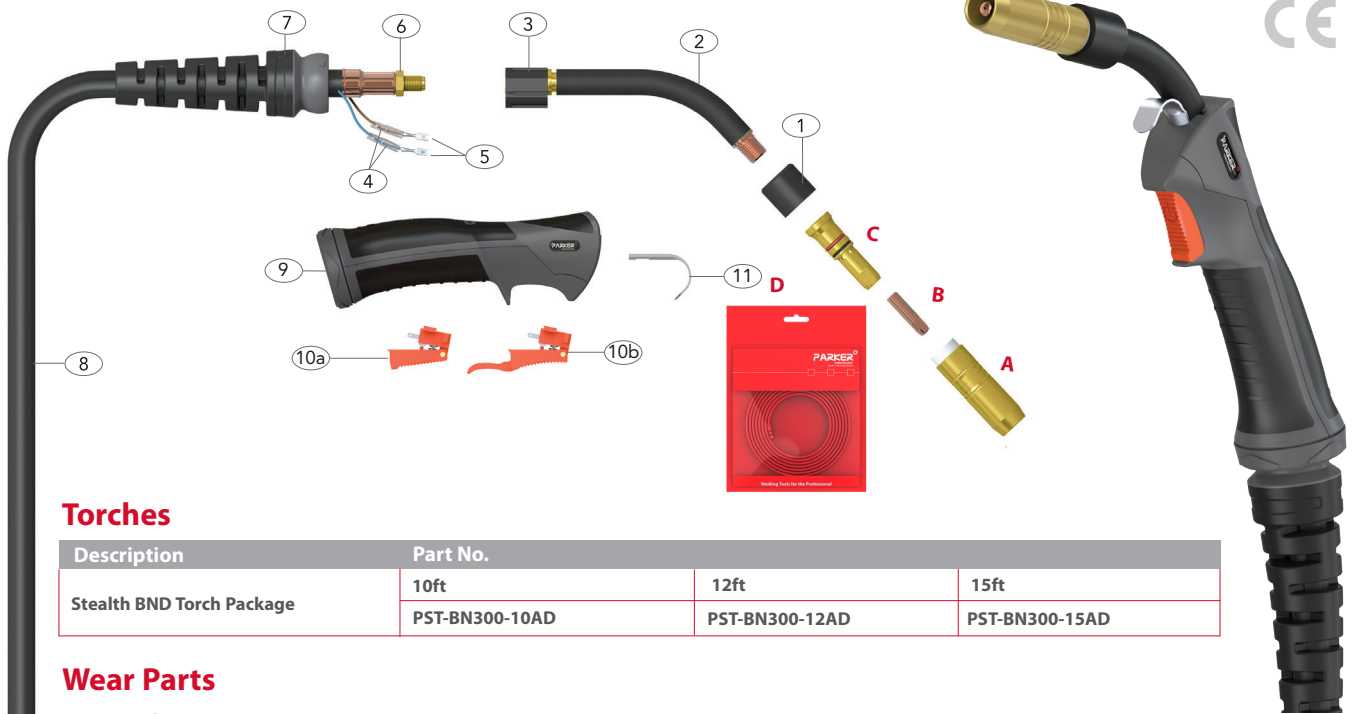

Torches

Description	Part No.		
Stealth BND Torch Package	10ft	12ft	15ft
	PST-BN300-10AD	PST-BN300-12AD	PST-BN300-15AD

Wear Parts

A Nozzles

Part No.	Description	Bore	Wall	Material
P4391	Conical Nozzle	16.0	2.85mm	Brass
*P4392	Tapered Nozzle	12.7	2.85mm	Brass
P4393	HD Conical Nozzle	16.0	2.85mm	Copper
P4295	Pipeline Nozzle	9.5	2.85mm	Brass

B Contact Tips

Part No.	Description	Material	Wire Size	
			mm	inch
P1588	Contact Tip	Ecu	0.8	0.030
P1589	Contact Tip	Ecu	0.9	0.035
P1590	Contact Tip	Ecu	1.2	0.045
P1596	Contact Tip	Ecu	1.0	0.040
P4281	Contact Tip	Ecu	0.9	0.035
P4282	Contact Tip	Ecu	1.2	0.045
P4285	Contact Tip	Ecu	0.8	0.030
P7488	Contact Tip	Ecu	0.8	0.030
P7489	Contact Tip	Ecu	0.9	0.035
*P7490	Contact Tip	Ecu	1.2	0.045
P7496	Contact Tip	Ecu	1.0	0.040

C Diffuser

Part No.	Description	Material
*P4335	Head Assembly	Brass

D Liners

Part No.	Description	Length	Wire Size	
			mm	inch
*PA43110	Steel Liner x 10ft	3.80mt	0.8-1.2	0.030-0.045
*PA43115	Steel Liner x 15ft	4.90mt	0.8-1.2	0.030-0.045
PA43125	Steel Liner x 15ft	8.10mt	0.8-1.2	0.030-0.045
PN43110	Steel Liner x 10ft	3.80mt	0.8-1.2	0.030-0.045
PN43115	Steel Liner x 15ft	4.90mt	0.8-1.2	0.030-0.045
PN43125	Steel Liner x 15ft	8.10mt	0.8-1.2	0.030-0.045

Spare Parts

Part No.	Description
1 P4323R	Rubber Cap
2 PLS-BN200	Swan Neck
3 PG1515	Ergo Handle Location Body
4 PB1521-C	Cable Terminal Cover
5 PB1521	Cable Terminal
6 PB1505	Lock Nut
7 PG8015	Handle Cable Support c/w Ball Joint
8 PSTH-4261TE	Cable Assembly x 10ft
PSTH-4262TE	Cable Assembly x 12ft
PSTH-4265TE	Cable Assembly x 15ft
9 SGB2514	Handle And Lock Nut Assembly
10a DGB2516	Standard Trigger Assembly
10b DGB2516L	Extended Trigger Assembly
11 PB2517	Hanger Hook

*Denotes torch package standard wear part set-up
For more information please refer to the following sections:
• Master Wear Parts Table Page 12-14
• Rear-End / Cable Parts Page 15

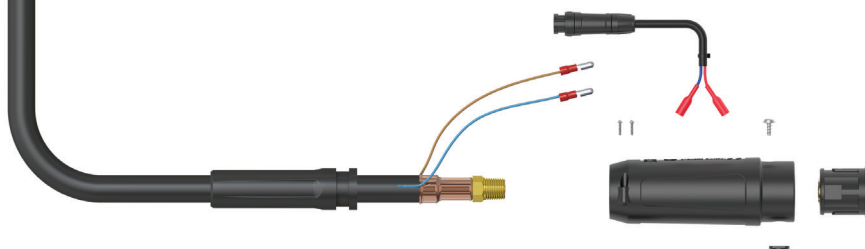

BN350 Stealth Mig/Mag Torch Range

Rating: 260A CO₂, 230A mixed gas M21, EN60974-7 @ 60% duty cycle. 0.8 to 1.2mm / 0.023-0.045" wires

Air-Cooled Mig Welding Torch

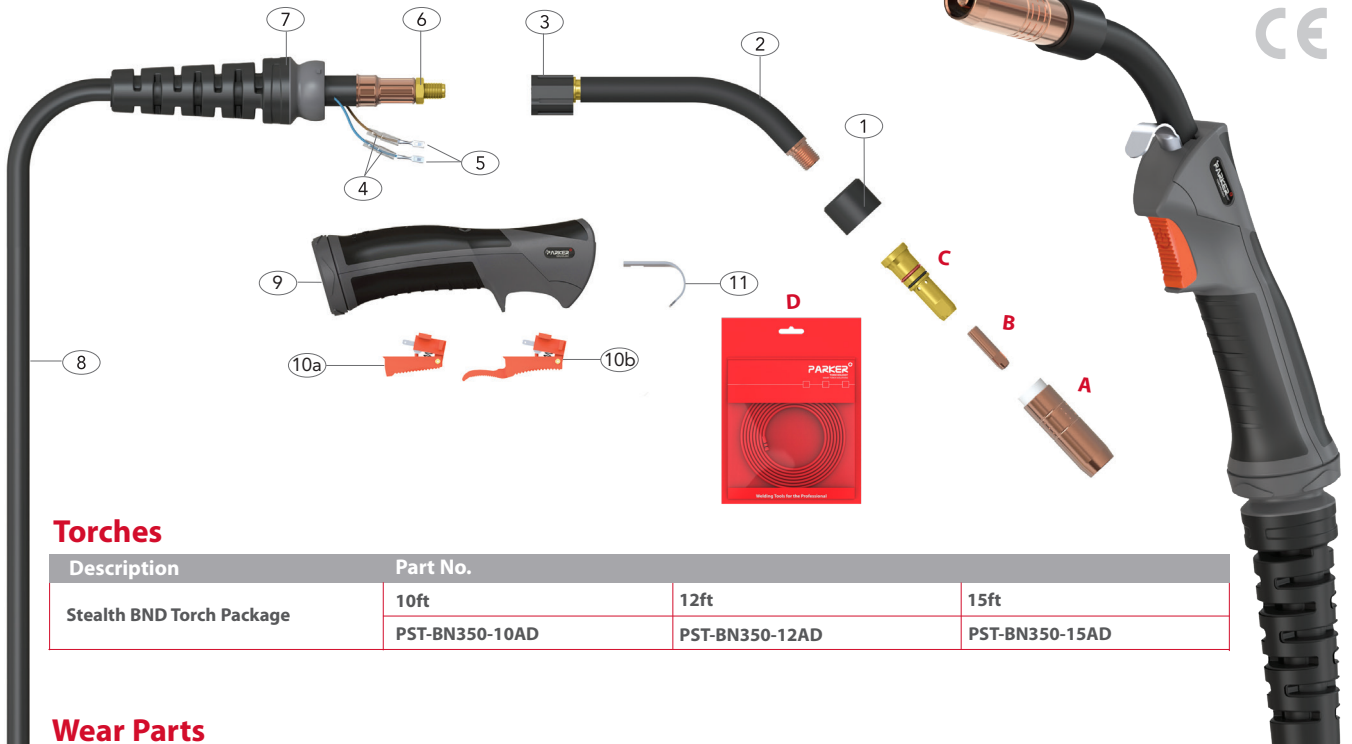

Torches

Description	Part No.		
Stealth BND Torch Package	10ft	12ft	15ft
	PST-BN350-10AD	PST-BN350-12AD	PST-BN350-15AD

Wear Parts

A Nozzles

Part No.	Description	Bore	Wall	Material
P4391	Conical Nozzle	16.0	2.85mm	Brass
*P4392	Tapered Nozzle	12.7	2.85mm	Brass
P4393	HD Conical Nozzle	16.0	2.85mm	Copper
P4295	Pipeline Nozzle	9.5	2.85mm	Brass

B Contact Tips

Part No.	Description	Material	Wire Size	
			mm	inch
P1588	Contact Tip	Ecu	0.8	0.030
P1589	Contact Tip	Ecu	0.9	0.035
P1590	Contact Tip	Ecu	1.2	0.045
P1596	Contact Tip	Ecu	1.0	0.040
P4281	Contact Tip	Ecu	0.9	0.035
P4282	Contact Tip	Ecu	1.2	0.045
P4285	Contact Tip	Ecu	0.8	0.030
P7488	Contact Tip	Ecu	0.8	0.030
P7489	Contact Tip	Ecu	0.9	0.035
*P7490	Contact Tip	Ecu	1.2	0.045
P7496	Contact Tip	Ecu	1.0	0.040

C Diffuser

Part No.	Description	Material
*P4335	Head Assembly	Brass

D Liners

Part No.	Description	Length	Wire Size	
			mm	inch
*PA43110	Steel Liner x 10ft	3.80mt	0.8-1.2	0.030-0.045
*PA43115	Steel Liner x 15ft	4.90mt	0.8-1.2	0.030-0.045
PA43125	Steel Liner x 15ft	8.10mt	0.8-1.2	0.030-0.045
PN43110	Steel Liner x 10ft	3.80mt	0.8-1.2	0.030-0.045
PN43115	Steel Liner x 15ft	4.90mt	0.8-1.2	0.030-0.045
PN43125	Steel Liner x 15ft	8.10mt	0.8-1.2	0.030-0.045

Spare Parts

Part No.	Description
1	P4323R Rubber Cap
2	PLS-BN300 Swan Neck
3	PG1515 Ergo Handle Location Body
4	PB1521-C Cable Terminal Cover
5	PB1521 Cable Terminal
6	PB1505 Lock Nut
7	PG8016 Handle Cable Support c/w Ball Joint
8	PSTH-4361TE Cable Assembly x 10ft
	PSTH-4362TE Cable Assembly x 12ft
	PSTH-4365TE Cable Assembly x 15ft
9	SGB2514 Handle And Lock Nut Assembly
10a	DGB2516 Standard Trigger Assembly
10b	DGB2516L Extended Trigger Assembly
11	PB2517 Hanger Hook

*Denotes torch package standard wear part set-up
For more information please refer to the following sections:
• Master Wear Parts Table Page 12-14
• Rear-End / Cable Parts Page 15

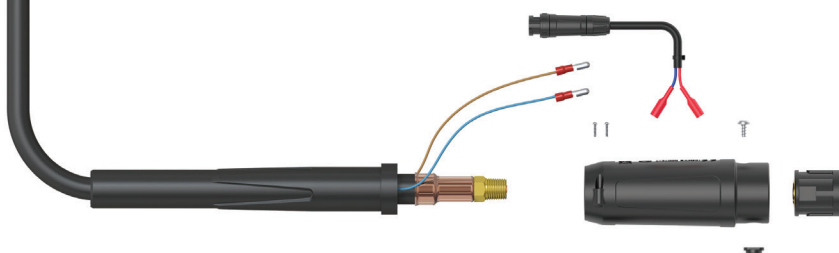

BN400 Stealth Mig/Mag Torch Range

Rating: 320A CO₂, 270A mixed gas M21, EN60974-7 @ 60% duty cycle. 0.8 to 1.2mm / 0.030-5/64" wires

Air-Cooled Mig Welding Torch

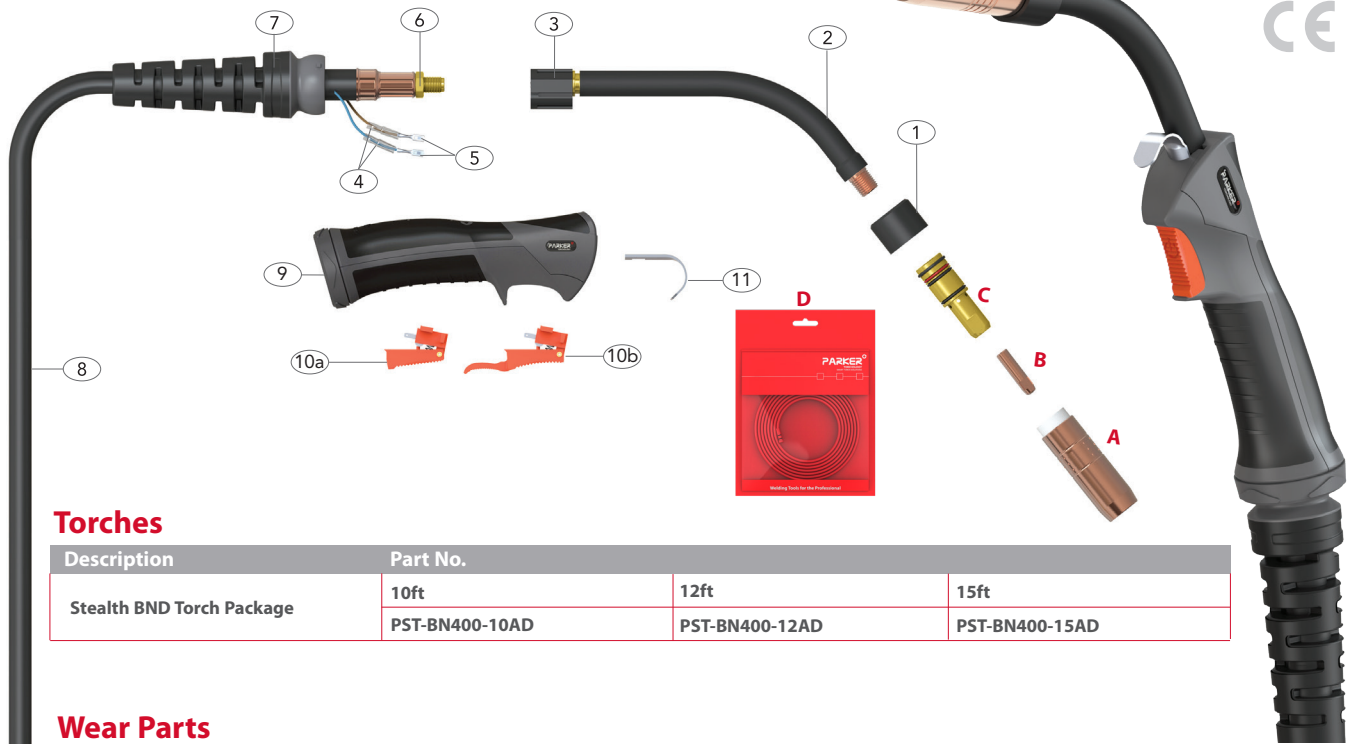

Torches

Description	Part No.		
Stealth BND Torch Package	10ft	12ft	15ft
	PST-BN400-10AD	PST-BN400-12AD	PST-BN400-15AD

Wear Parts

A Nozzles

Part No.	Description	Bore	Wall	Material
*P4491	Conical Nozzle	19.0	2.95mm	Brass
P4492	Tapered Nozzle	14.0	2.95mm	Brass
P4591	HD Conical Nozzle	16.0	2.85mm	Copper
P4592	HD Tapered Nozzle	9.5	2.85mm	Brass

B Contact Tips

Part No.	Description	Material	Wire Size	
			mm	inch
P1588	Contact Tip	Ecu	0.8	0.030
P1589	Contact Tip	Ecu	0.9	0.035
P1590	Contact Tip	Ecu	1.2	0.045
P1596	Contact Tip	Ecu	1.0	0.040
P4281	Contact Tip	Ecu	0.9	0.035
P4282	Contact Tip	Ecu	1.2	0.045
P4283	Contact Tip	Ecu	1.4	0.055
P4285	Contact Tip	Ecu	0.8	0.030
P7488	Contact Tip	Ecu	0.8	0.030
P7489	Contact Tip	Ecu	0.9	0.035
*P7490	Contact Tip	Ecu	1.2	0.045
P7496	Contact Tip	Ecu	1.0	0.040

C Diffuser

Part No.	Description	Material
*P4335	Head Assembly	Brass
*P4435	Head Assembly	Brass
*P4635	Head Assembly	Brass

D Liners

Part No.	Description	Length	Wire Size	
			mm	inch
*PA43110	Steel Liner x 10ft	3.80mt	0.8-1.2	0.030-0.045
*PA43115	Steel Liner x 15ft	4.90mt	0.8-1.2	0.030-0.045
PA43125	Steel Liner x 15ft	8.10mt	0.8-1.2	0.030-0.045
PN43110	Steel Liner x 10ft	3.80mt	0.8-1.2	0.030-0.045
PN43115	Steel Liner x 15ft	4.90mt	0.8-1.2	0.030-0.045
PN43125	Steel Liner x 15ft	8.10mt	0.8-1.2	0.030-0.045

Spare Parts

Part No.	Description
1	P4423R Rubber Cap
2	PLS-BN400 Swan Neck
3	PG1515 Ergo Handle Location Body
4	PB1521-C Cable Terminal Cover
5	PB1521 Cable Terminal
6	PB1505 Lock Nut
7	PG8016 Handle Cable Support c/w Ball Joint
8	PSTH-4461TE Cable Assembly x 10ft
	PSTH-4462TE Cable Assembly x 12ft
	PSTH-4465TE Cable Assembly x 15ft
9	SGB2514 Handle And Lock Nut Assembly
10a	DGB2516 Standard Trigger Assembly
10b	DGB2516L Extended Trigger Assembly
11	PB2517 Hanger Hook

*Denotes torch package standard wear part set-up
 For more information please refer to the following sections:
 • Master Wear Parts Table Page 12-14
 • Rear-End / Cable Parts Page 15

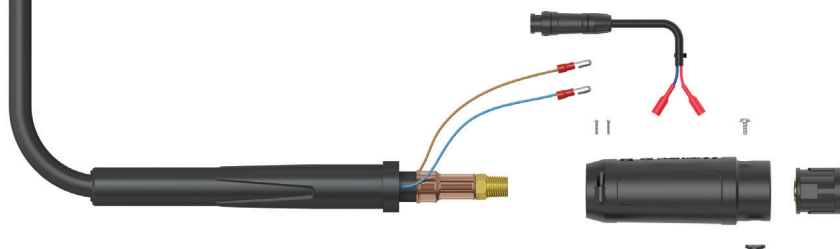

Nozzles

BN200/300/350

Part No.	Description	Bore	Wall	Material
P4391	Conical Nozzle	16.0	2.85mm	Brass
* P4392	Tapered Nozzle	12.7	2.85mm	Brass

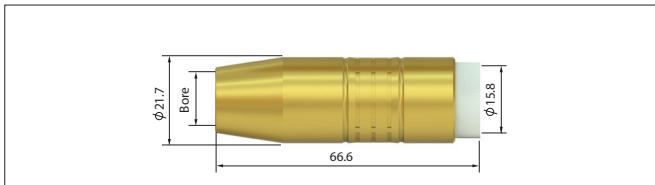

* P4393	HD Conical Nozzle	16.0	2.85mm	Copper
---------	-------------------	------	--------	--------

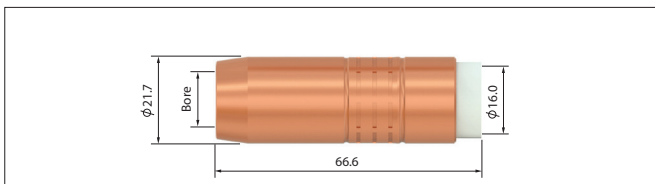

P4295	Pipeline Nozzle	9.50	2.85mm	Brass
-------	-----------------	------	--------	-------

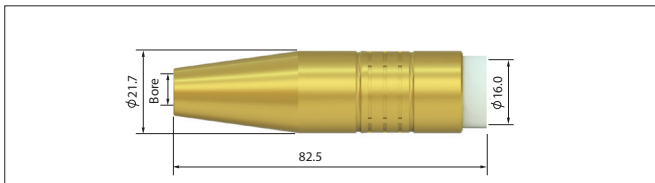

BN400

Part No.	Description	Bore	Wall	Material
P4491	Conical Nozzle	19.0	2.95mm	Brass
P4492	Tapered Nozzle	14.0	2.95mm	Brass

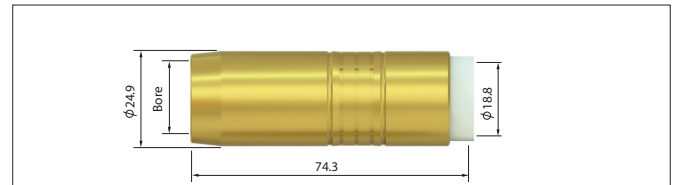

* P4591	HD Conical Nozzle	19.0	2.95mm	Copper
---------	-------------------	------	--------	--------

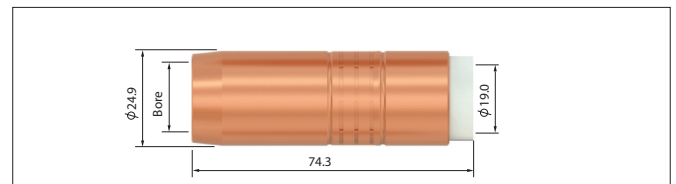

P4592	HD Conical Nozzle	14.0	2.95mm	Copper
-------	-------------------	------	--------	--------

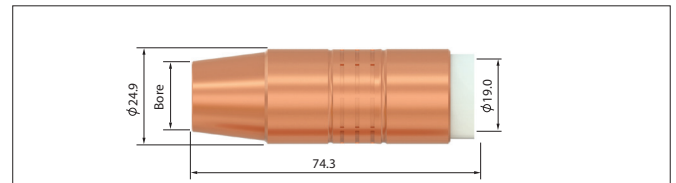

* Denotes torch package standard wear part set-up

Wear Parts

Contact Tips

BN200/300/350/400

Part No.	Description	Wire Size		Material
		MM	INCH	
P1588	Contact Tip	0.8	0.030	Ecu
P1589	Contact Tip	0.9	0.035	Ecu
P1590	Contact Tip	1.2	0.045	Ecu
P1596	Contact Tip	1.0	0.040	Ecu

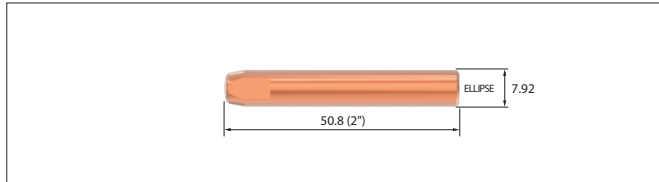

P4281	Contact Tip	0.9	0.035	Ecu
P4282	Contact Tip	1.2	0.045	Ecu
P4285	Contact Tip	0.8	0.030	Ecu

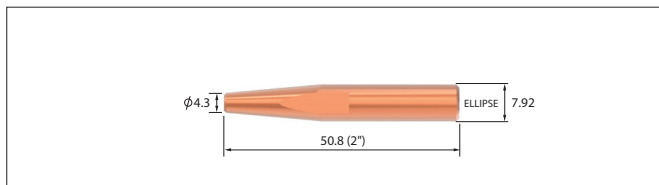

P7488	Contact Tip	0.8	0.030	Ecu
P7489	Contact Tip	0.9	0.035	Ecu
* P7490	Contact Tip	1.2	0.045	Ecu
P7496	Contact Tip	1.0	0.040	Ecu

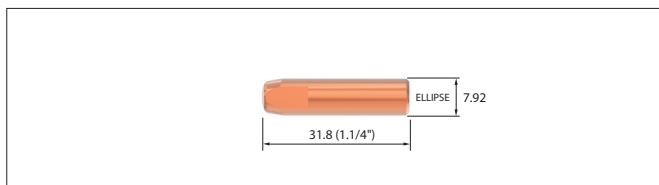

Diffuser

BN200/300/350

Part No.	Description	Bore	Material
* P4335	Head Assembly		Brass

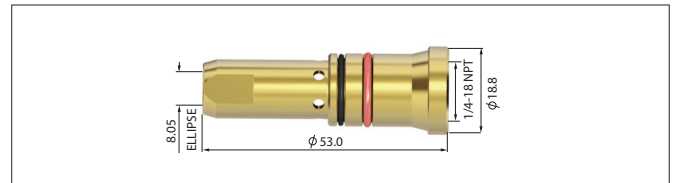

BN400

Part No.	Description	Bore	Material
* P4435	Head Assembly		Brass

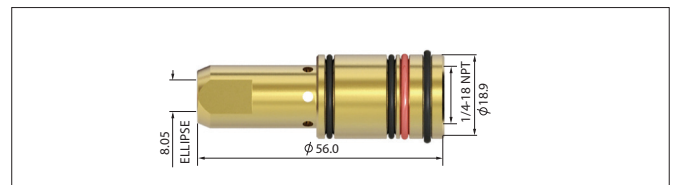

Part No.	Description	Bore	Material
P4635	Head Assembly		Brass

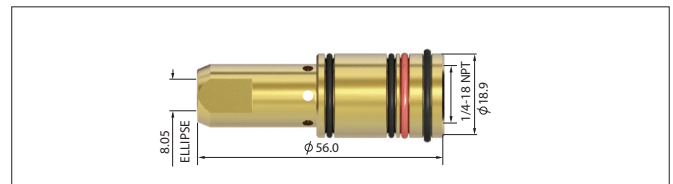

* Denotes torch package standard wear part set-up

Liner Options 0.6-0.8mm

BN200

Part No.	Description	Length	Nipple	Wire Size	
				MM	INCH
PA43010	Steel Liner X 10FT	3.80M	Brass Nipple	0.6-0.8	0.023-0.030
PA43015	Steel Liner X 15FT	4.90M	Brass Nipple	0.6-0.8	0.023-0.030



Liner Options 0.8-1.2mm

BN200/300/350/400

Part No.	Description	Length	Nipple	Wire Size	
				MM	INCH
* PA43110	Steel Liner X 10FT	3.80M	Brass Nipple	0.8-1.2	0.030-0.045
* PA43115	Steel Liner X 15FT	4.90M	Brass Nipple	0.8-1.2	0.030-0.045
PA43125	Steel Liner X 25FT	8.10M	Brass Nipple	0.8-1.2	0.030-0.045

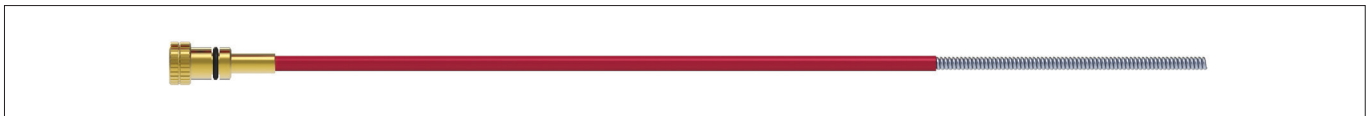

PN43110	Polyamide Liner X 10FT	3.80M	Brass Nipple	0.8-1.2	0.030-0.045
PN43115	Polyamide Liner X 15FT	4.90M	Brass Nipple	0.8-1.2	0.030-0.045
PN43125	Polyamide Liner X 25FT	8.10M	Brass Nipple	0.8-1.2	0.030-0.045

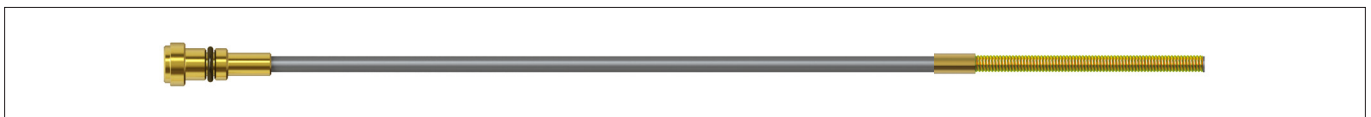

* Denotes torch package standard wear part set-up

Termination

BN200/300

Part No.	Description
1 PC2841	Cable Support
2 PG2503C	Cable End Lock Nut
3 SCPSP1-1	Gun Plug Housing Screw
4 SCP2578HL-S	Gun Plug Housing
5 PBL1541	Gun Plug Screw
6 PECEM5060-2	Hybrid Plug Body
7 PB1522	Cable Terminal Male
8 PQF-SW	Male Switch Wire Plug
9 SCP2578-SP1	Housing Stopper

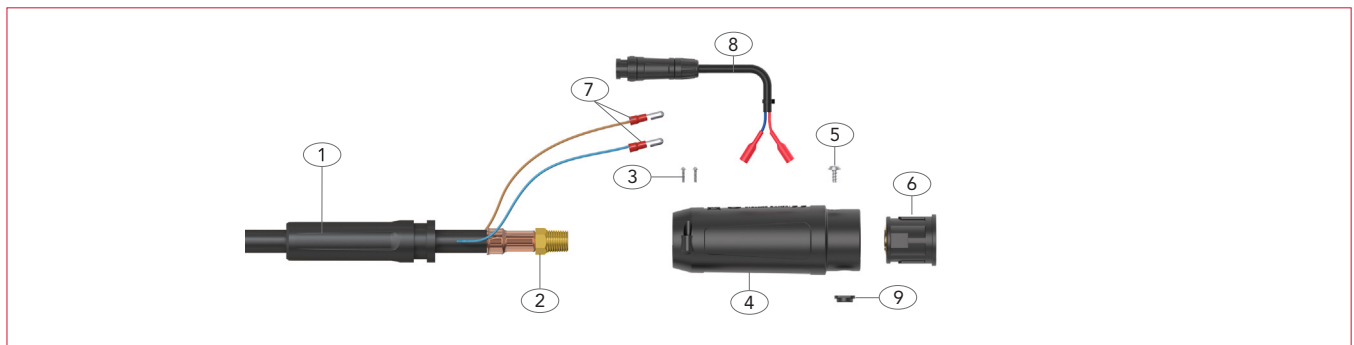

BN350/400

Part No.	Description
1 PPA3541	Cable Support
2 PG2503C	Cable End Lock Nut
3 SCPSP1-1	Gun Plug Housing Screw
4 SCP2578HL-L	Gun Plug Housing
5 PBL1541	Gun Plug Screw
6 PECEM5060-2	Hybrid Plug Body TWC 1-4
7 PB1522	Cable Terminal Male
8 PQF-SW	Male Switch Wire Plug
9 SCP2578-SP1	Housing Stopper

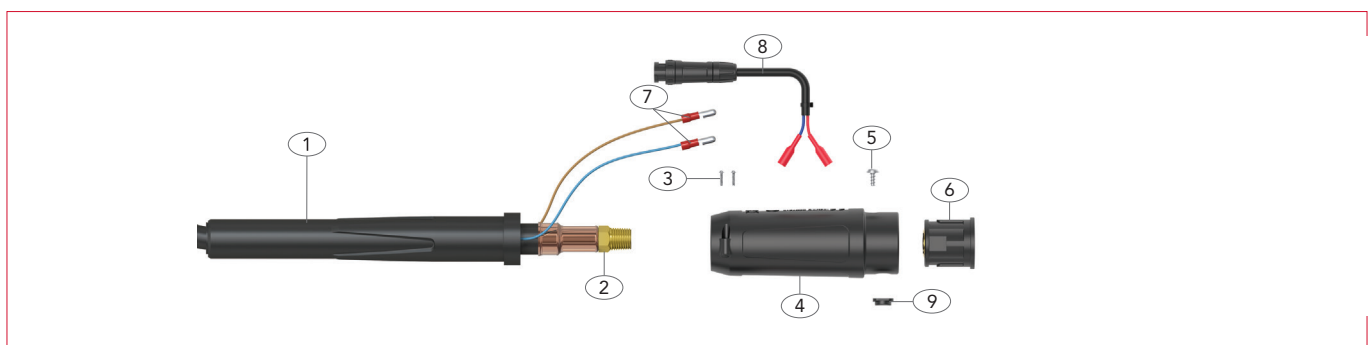

Tweco® Universal Kit

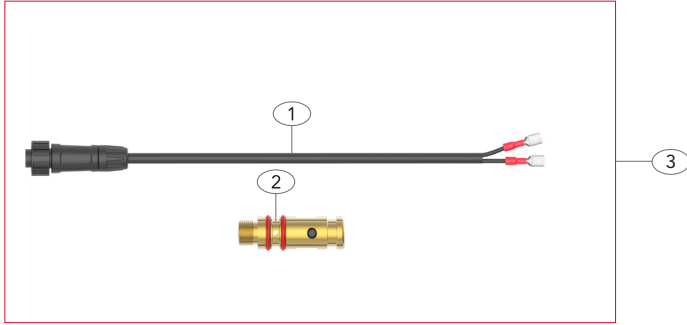

Direct Plug Connector

Part No.	Description
1	PECEL1575-SW-Q Quick Fit Switch Wire Assembly
2	PECET5060-1 Tweco® 1-4 Power Pin
3	PECET5060K-Q Quick Fit Connector Kit Complete

Miller® Universal Kit

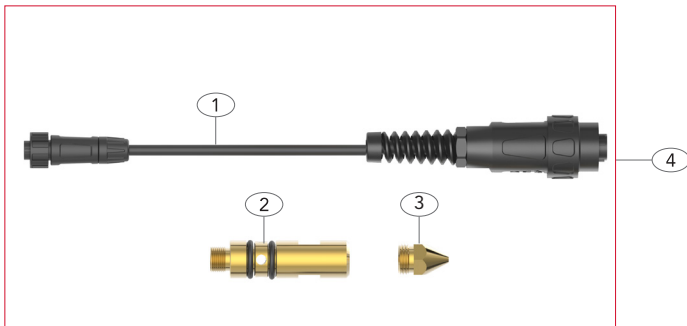

Direct Plug Connector

Part No.	Description
1	PECEM1575-SW-Q Quick Fit Miller® Plug Assembly
2	PECEM5060-1 Miller® Power Pin
3	PML1570 Wire Guide 0.35"-1/16" PML1571 Wire Guide 5/16"-3/32"(Option)
4	PECEM5060K-Q Quick Fit Connector Kit Complete

Lincoln® Universal Kit

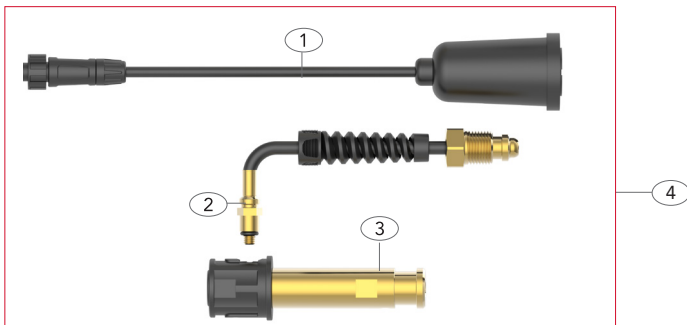

Direct Plug Connector

Part No.	Description
1	PM16725-Q Quick Fit Lincoln® Plug Assembly
2	PECEL1575-G Lincoln® Gas Tube Assembly
3	PECEL5060 Lincoln® Power Pin
4	PECEL5060K-Q Quick Fit Connector Kit Complete



Universal Set-up Guide
A simple step by step guide

LPW Universal Kit

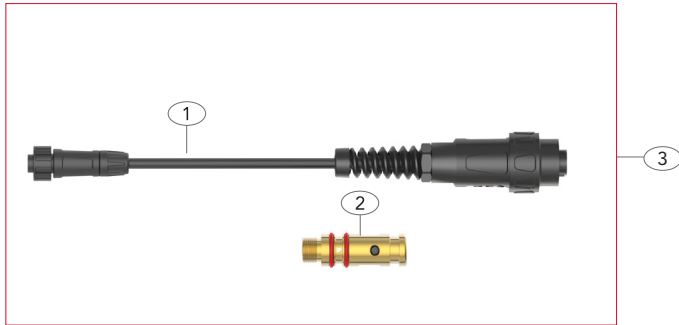

Direct Plug Connector

Part No.	Description
1	PECEM1575-SW-Q Quick Fit Miller® Plug Assembly
2	PECET5060-1 Tweco® 1-4 Power Pin
3	PECEW5060K-Q Quick Fit Connector Kit Complete

LPB Universal Kit

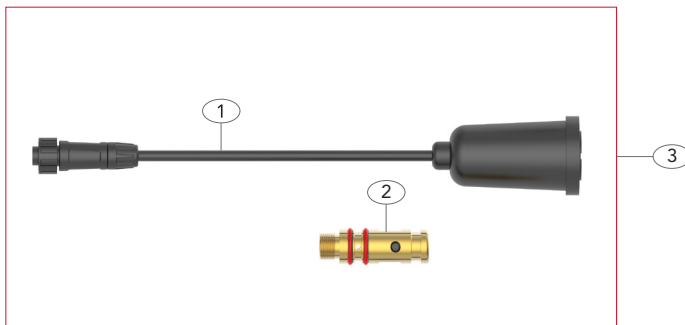

Direct Plug Connector

Part No.	Description
1	PM16725-Q Quick Fit Lincoln® Plug Assembly
2	PECET5060-1 Tweco® 1-4 Power Pin
3	PECEB5060K-Q Quick Fit Connector Kit Complete

Euro Universal Kit

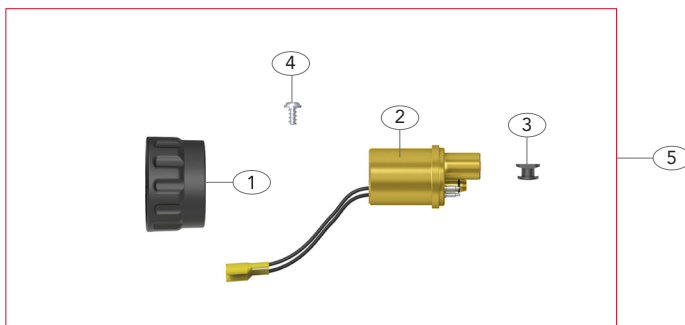

Direct Plug Connector

Part No.	Description
1	PC1519-S Gun Plug Nut
2	P5060 Gun Plug Body
3	SCP2578-SP2 Housing Stopper
4	PB1526 Gun Plug Screw
5	P5060K-Q Quick Fit Connector Kit Complete



Universal Set-up Guide
A simple step by step guide



JINAN UNIARC WELDING TECHNOLOGY CO., LTD
13A Zhangjin Comprehensive Bonded Zone
33688, Jing Shi Dong Road
Jinan Area of China (Shandong) Pilot Free Trade Zone
Jinan 250102, P.R. China

Tel: +86 531 88239823

Website: [www.uniarc\(torchology.com](http://www.uniarc(torchology.com)

Email: [info@uniarc\(torchology.com](mailto:info@uniarc(torchology.com)

MPP010 / V.2024.02