

**TWC STEALTH**  
MIG/MAG UNIVERSAL SYSTEM



**Welding Tools for the Professional**

## A Smart Approach

Parker Torchology is shaped by people with vision, a passion for improvement and a belief in delivering the very best Welding and Cutting Torch Range in the World.

We expect a great deal from our products, so we ask a lot of ourselves and our engineers.

Our mantra: **Innovation, Technology, Performance.**



## DNA

Design and Engineering excellence are at the core of everything we do.

Every torch we build is driven by our relentless pursuit of perfection.

## Premium Features

At Parker Torchology we do things differently, we strive to solve your problems with the perfect product to suit your needs. We create smart product features encased in cutting-edge design to ensure you always have the best tools to hand.





## Production

A fusion of precision production engineering, our bespoke processing techniques and a fanatical attention to detail ensures every welding torch we produce is worthy of the Parker Torchology name.

## Testing, Testing, Testing

It takes patience to develop a new product, it's a lot more than a great idea.

Product development is an iterative process, trying something over and over, changing one small variable at a time.

We build endless prototypes and test pieces that undergo months of rigorous testing. Only once a product has passed up to 88 different test procedures, with every single part tested separately do we consider our latest designs ready for market.

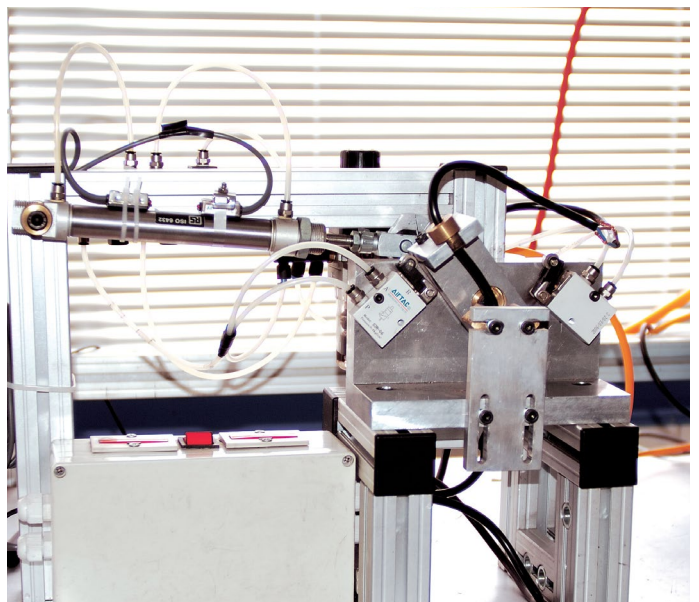



## Partners

Our customers and business partners play a vital role in our development. With the core aim to strive together, we work with end-users, distributors and academic institutions alike.

As a result we share fundamental values in order to succeed in our respective market places, supporting economic growth and collaborative opportunities with others.

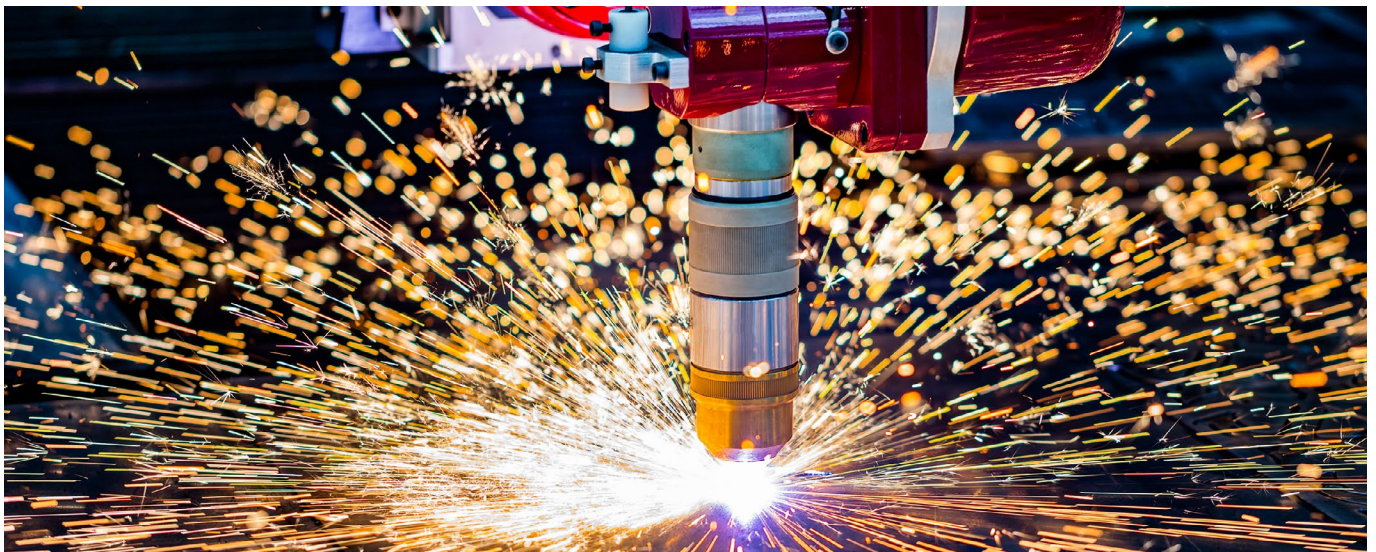
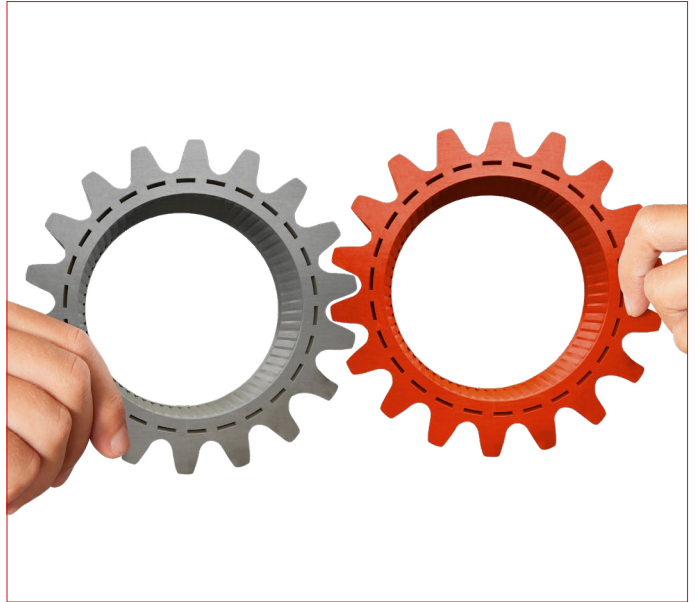

## A Bright Future

Technology doesn't stand still, which is why we are constantly innovating to bring you the best products on the market.

Our strong vision and focused innovation strategy, not to mention our passion to revolutionize the industry, ensure that Parker Torchology is a byword for excellence.

**We Talk Torches**

## Contents

TWC Stealth Mig/Mag Torch Range Features Focus	6
------------------------------------------------	---

TWC Stealth Mig/Mag Torch Range Overview and Ratings	7
------------------------------------------------------	---

---

### Torch Range

<b>PST-TW 180</b>	8
-------------------	---

<b>PST-TW 200</b>	9
-------------------	---

<b>PST-TW 300</b>	10
-------------------	----

<b>PST-TW 400</b>	11
-------------------	----

---

### Wear Parts

Nozzles	12
---------	----

Contact Tips	13
--------------	----

Diffusers	13
-----------	----

Liners	14
--------	----

---

<b>Rear-End Spare Parts</b>	15
-----------------------------	----

<b>Direct Plug Connector Kits</b>	16
-----------------------------------	----

**Air-Cooled**

# TWC Mig/Mag Torch Range

## Air-Cooled Features Focus

The traditional North American TWC Series developed for high performance in heavy industrial environments.

**Air-Cooled**

## Welding Tools for the Professional



100% Tweco® Compatibility Guaranteed

### Quality Wear Parts

All wear parts are manufactured to the same specification as the original manufacturer ensuring reliability, longevity and superior performance

- Contact tips are manufactured from premium grade copper alloys; we don't sacrifice performance by using low end or recycled raw materials
- Standard and high-performance options are available for tip adaptors, diffusers and swan necks
- The correct specification of raw material type, surface finish, tensile strength and the coiling technology utilized to form the liner are all essential elements in achieving the correct manufacture of a liner

### Superior Flexibility and Durability

Every detail has been considered to ensure the welder has the very best handling in all positions

- Improved balance and positionability with the addition of a knuckle joint which enables small movements of the handle and neck independently of the cable assembly
- Cable sets offer the ultimate in heat and abrasion resistance, fused by an electron beam process that maximizes flexibility and enhances durability



### Terminations

A comprehensive range of USA style terminations ensures worldwide compatibility.



## The Smart Way To Buy Welding and Cutting Tools

## TWC Stealth Mig/Mag Torch Range

Ratings: 150 Amp to 400 Amp, Mixed Gas M21



Model	PST-TW180	PST-TW200	PST-TW300	PST-TW400
<b>Technical Data</b>				
Cooling Method	Air-Cooled	Air-Cooled	Air-Cooled	Air-Cooled
Rating: CO <sub>2</sub>	180A	230A	260A	320A
Rating: Mixed Gas M21	150A	200A	230A	270A
Duty Cycle	60%	60%	60%	60%
Wire Size	0.6-1.0	0.8-1.2	0.8-1.2	0.8-1.2

<b>Order Codes</b>	<b>10ft</b>	PST-TW180-10AD PST-TW180-MT2-10AD	PST-TW200-10AD PST-TW200-MT2-10AD	PST-TW300-10AD PST-TW300-MT2-10AD	PST-TW400-10AD PST-TW400-MT2-10AD
	<b>12ft</b>	PST-TW180-12AD PST-TW180-MT2-12AD	PST-TW200-12AD PST-TW200-MT2-12AD	PST-TW300-12AD PST-TW300-MT2-12AD	PST-TW400-12AD PST-TW400-MT2-12AD
	<b>15ft</b>	PST-TW180-15AD PST-TW180-MT2-15AD	PST-TW200-15AD PST-TW200-MT2-15AD	PST-TW300-15AD PST-TW300-MT2-15AD	PST-TW400-15AD PST-TW400-MT2-15AD

# PST-TW180 Stealth Mig/Mag Torch Range

Rating: 180A CO<sub>2</sub> 150A mixed gas M21, EN60974-7 @ 60% duty cycle. 0.6 to 1.0mm / 0.023-0.039" wires

Air-Cooled Mig Welding Torch

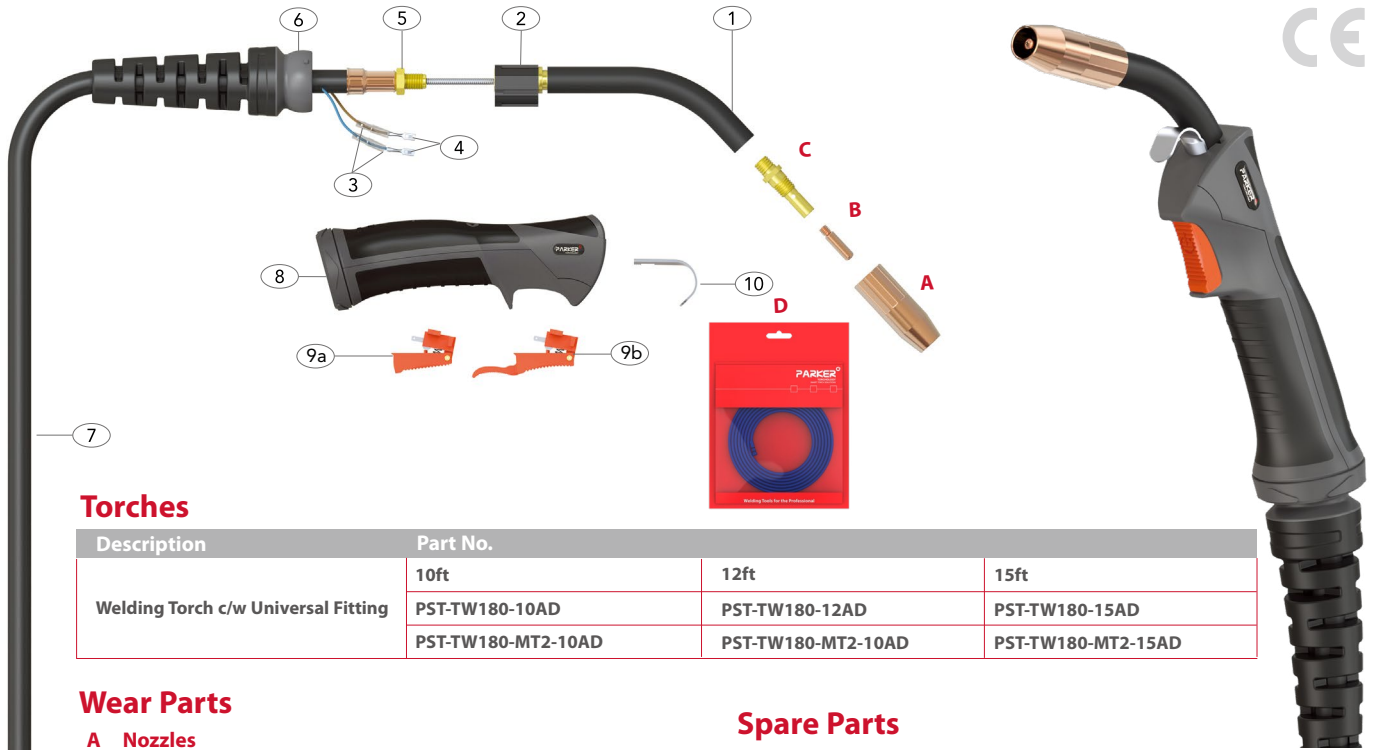

## Torches

Description	Part No.		
	10ft	12ft	15ft
Welding Torch c/w Universal Fitting	PST-TW180-10AD	PST-TW180-12AD	PST-TW180-15AD
	PST-TW180-MT2-10AD	PST-TW180-MT2-10AD	PST-TW180-MT2-15AD

## Wear Parts

### A Nozzles

Part No.	Description	Bore	Wall	Material
P21-37	Nozzle Self Insulated	9.5	1.60mm	Copper
*P21-50	Nozzle Self Insulated	12.7	1.60mm	Copper
P21-62	Nozzle Self Insulated	15.9	1.60mm	Copper

### B Contact Tips

Part No.	Description	Material	Wire Size	
			mm	inch
P11-23	Contact Tip	Ecu	0.6	0.023
*P11-30	Contact Tip	Ecu	0.8	0.030
P11-35	Contact Tip	Ecu	0.9	0.035
P11-40	Contact Tip	Ecu	1.0	0.040
P11-45	Contact Tip	Ecu	1.2	0.045

### C Diffuser

Part No.	Description	Material
*P51	Diffuser	Brass

### D Liners

Part No.	Description	Length	Wire Size	
			mm	inch
*PA42-3035-15	Steel Liner x 15ft	4.90mt	0.8-0.9	0.030-0.035
PA42-3035-25	Steel Liner x 25ft	8.10mt	0.8-0.9	0.030-0.035
PA42-4045-15	Steel Liner x 15ft	4.90mt	1.0-1.2	0.040-0.045
PA42-4045-25	Steel Liner x 25ft	8.10mt	1.0-1.2	0.040-0.045
P42N-4045-15	Polyamide Liner x 15ft	4.90mt	1.0-1.2	0.040-0.045
P42N-4045-25	Polyamide Liner x 25ft	8.10mt	1.0-1.2	0.040-0.045

## Spare Parts

Part No.	Description
1	PLS-TW1 Swan Neck Assembly
2	PG1515 Ergo Handle Location Body
3	PB1521-C Cable Terminal Cover
4	PB1521 Cable Terminal
5	PB1505 Lock Nut
6	PG8015 Handle Cable Support c/w Ball Joint
7	PSTH180-10E Cable Assembly x 10ft
	PSTH180-12E Cable Assembly x 12ft
	PSTH180-15E Cable Assembly x 15ft
8	SGB2514 Handle And Lock Nut Assembly
9a	DGB2516 Standard Trigger Assembly
9b	DGB2516L Extended Trigger Assembly
10	PB2517 Hanger Hook

\*All Registered Trademarks listed are the property of their respective manufacturer. Reference to the original manufacturer is for reference only.

\*Denotes torch package standard wear part set-up  
For more information please refer to the following sections:  
•Master Wear Parts Table Page 12-14  
•Rear-End / Cable Parts Page 15-17



# PST-TW200 Stealth Mig/Mag Torch Range

Rating: 230A CO<sub>2</sub> 200A mixed gas M21, EN60974-7 @ 60% duty cycle. 0.8 to 1.2mm / 0.023-0.045" wires

Air-Cooled Mig Welding Torch

**PARKER**  
TORCHOLOGY  
SMART TORCH SOLUTIONS

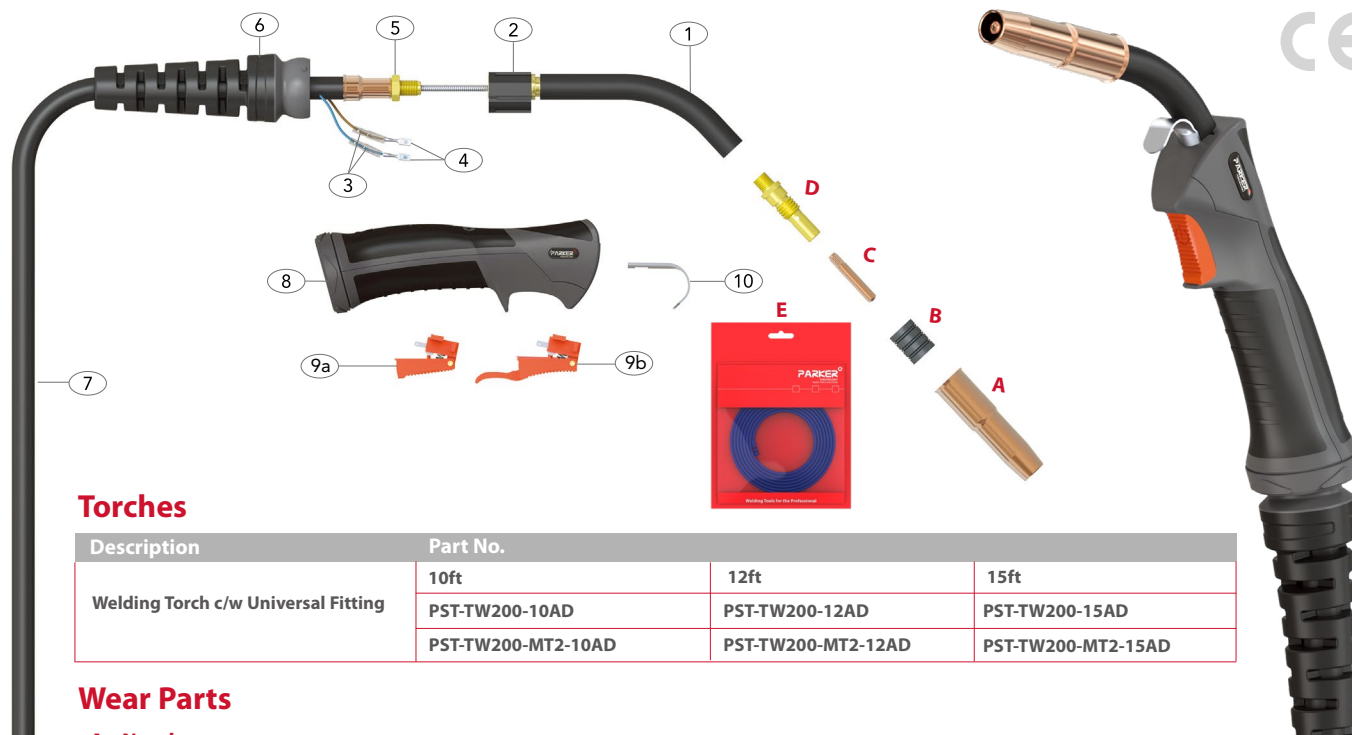

## Torches

Description	Part No.		
Welding Torch c/w Universal Fitting	10ft	12ft	15ft
	PST-TW200-10AD	PST-TW200-12AD	PST-TW200-15AD
	PST-TW200-MT2-10AD	PST-TW200-MT2-12AD	PST-TW200-MT2-15AD

## Wear Parts

### A Nozzles

Part No.	Description	Bore	Wall	Material
*P22-50	Nozzle Self Insulated	12.8	1.25mm	Copper
P22-62	Nozzle Self Insulated	16.0	1.25mm	Copper

### B Nozzles Insulator

Part No.	Description
*P32	Nozzle Insulator

### C Contact Tips

Part No.	Description	Material	Wire Size	
			mm	inch
*P14-30	Contact Tip	Ecu	0.8	0.030
P14-40	Contact Tip	Ecu	1.0	0.040
P14-45	Contact Tip	Ecu	1.2	0.045
P14H-30	Contact Tip	Ecu	0.8	0.030
P14H-40	Contact Tip	Ecu	1.0	0.040
P14H-45	Contact Tip	Ecu	1.2	0.045

### D Diffuser

Part No.	Description	Material
P52	Diffuser	Brass

### E Liners

Part No.	Description	Length	Wire Size	
			mm	inch
*PA42-3035-15	Steel Liner x 15ft	4.90mt	0.8-0.9	0.030-0.035
PA42-3035-25	Steel Liner x 25ft	8.10mt	0.8-0.9	0.030-0.035
PA42-4045-15	Steel Liner x 15ft	4.90mt	1.0-1.2	0.040-0.045
PA42-4045-25	Steel Liner x 25ft	8.10mt	1.0-1.2	0.040-0.045
P42N-4045-15	Polyamide Liner x 15ft	4.90mt	1.0-1.2	0.040-0.045
P42N-4045-25	Polyamide Liner x 25ft	8.10mt	1.0-1.2	0.040-0.045

## Spare Parts

Part No.	Description
1	PLS-TW2 Swan Neck Assembly
2	PG1515 Ergo Handle Location Body
3	PB1521-C Cable Terminal Cover
4	PB1521 Cable Terminal
5	PB1505 Lock Nut
6	PG8015 Handle Cable Support c/w Ball Joint
7	PSTH200-10E Cable Assembly x 10ft
	PSTH200-12E Cable Assembly x 12ft
	PSTH200-15E Cable Assembly x 15ft
8	SGB2514 Handle And Lock Nut Assembly
9a	DGB2516 Standard Trigger Assembly
9b	DGB2516L Extended Trigger Assembly
10	PB2517 Hanger Hook

\*Denotes torch package standard wear part set-up  
For more information please refer to the following sections:  
• Master Wear Parts Table Page 12-14  
• Rear-End / Cable Parts Page 15-17

# PST-TW300 Stealth Mig/Mag Torch Range

Rating: 260A CO<sub>2</sub> 230A mixed gas M21, EN60974-7 @ 60% duty cycle. 0.8 to 1.2mm / 0.023-0.045" wires

Air-Cooled Mig Welding Torch

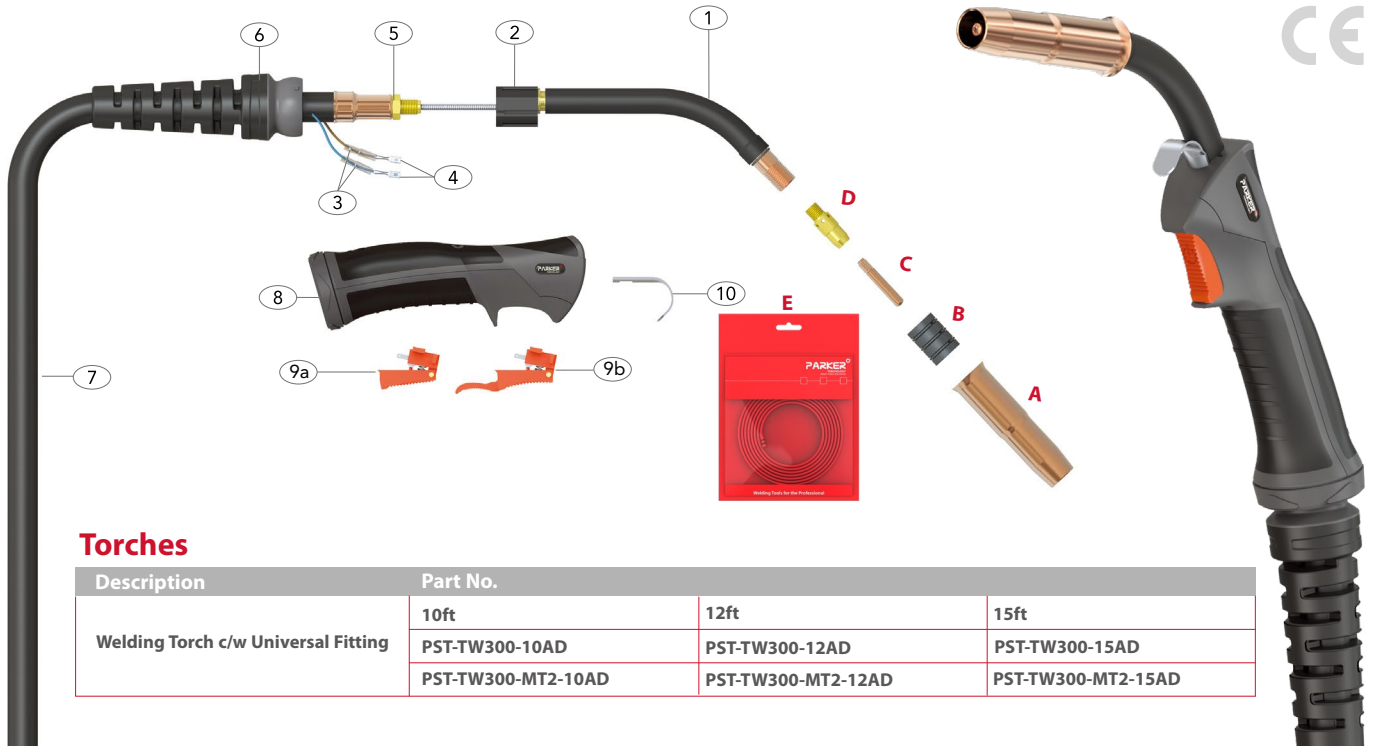

## Torches

Description	Part No.		
Welding Torch c/w Universal Fitting	10ft	12ft	15ft
	PST-TW300-10AD	PST-TW300-12AD	PST-TW300-15AD
	PST-TW300-MT2-10AD	PST-TW300-MT2-12AD	PST-TW300-MT2-15AD

## Wear Parts

### A Nozzles

Part No.	Description	Bore	Wall	Material
P24A-50	Nozzle Self Insulated	12.8	1.60mm	Copper
*P24A-62	Nozzle Self Insulated	16.0	1.60mm	Copper
P24A-75	Nozzle Self Insulated	19.0	1.60mm	Copper

### B Nozzles Insulator

Part No.	Description
*P34A	Nozzle Insulator

### C Contact Tips

Part No.	Description	Material	Wire Size	
			mm	inch
P14-30	Contact Tip	Ecu	0.8	0.030
P14-35	Contact Tip	Ecu	0.9	0.035
P14-40	Contact Tip	Ecu	1.0	0.040
P14-45	Contact Tip	Ecu	1.2	0.045
P14H-30	Contact Tip	Ecu	0.8	0.030
P14H-35	Contact Tip	Ecu	0.9	0.035
P14H-40	Contact Tip	Ecu	1.0	0.040
P14H-45	Contact Tip	Ecu	1.2	0.045

### D Diffuser

Part No.	Description	Material
*P54A	Diffuser	Brass

### E Liners

Part No.	Description	Length	Wire Size	
			mm	inch
*PA44-3545-15	Steel Liner x 15ft	4.90mt	0.9-1.2	0.035-0.045
PA44-3545-15	Steel Liner x 25ft	8.10mt	0.9-1.2	0.035-0.045
P42N-4045-15	Polyamide Liner x 15ft	4.90mt	1.0-1.2	0.040-0.045
P42N-4045-25	Polyamide Liner x 25ft	8.10mt	1.0-1.2	0.040-0.045

## Spare Parts

Part No.	Description
1	PLS-TW3 Swan Neck Assembly
2	PG1515 Ergo Handle Location Body
3	PB1521-C Cable Terminal Cover
4	PB1521 Cable Terminal
5	PB1505 Lock Nut
6	PG8016 Handle Cable Support c/w Ball Joint
7	PSTH300-10E Cable Assembly x 10ft
	PSTH300-12E Cable Assembly x 12ft
	PSTH300-15E Cable Assembly x 15ft
8	SGB2514 Handle And Lock Nut Assembly
9a	DGB2516 Standard Trigger Assembly
9b	DGB2516L Extended Trigger Assembly
10	PB2517 Hanger Hook

\*Denotes torch package standard wear part set-up  
For more information please refer to the following sections:  
• Master Wear Parts Table Page 12-14  
• Rear-End / Cable Parts Page 15-17

# PST-TW400 Stealth Mig/Mag Torch Range

Rating: 320A CO<sub>2</sub> 270A mixed gas M21, EN60974-7 @ 60% duty cycle. 0.8 to 1.2mm / 0.030-5/64" wires  
Air-Cooled Mig Welding Torch

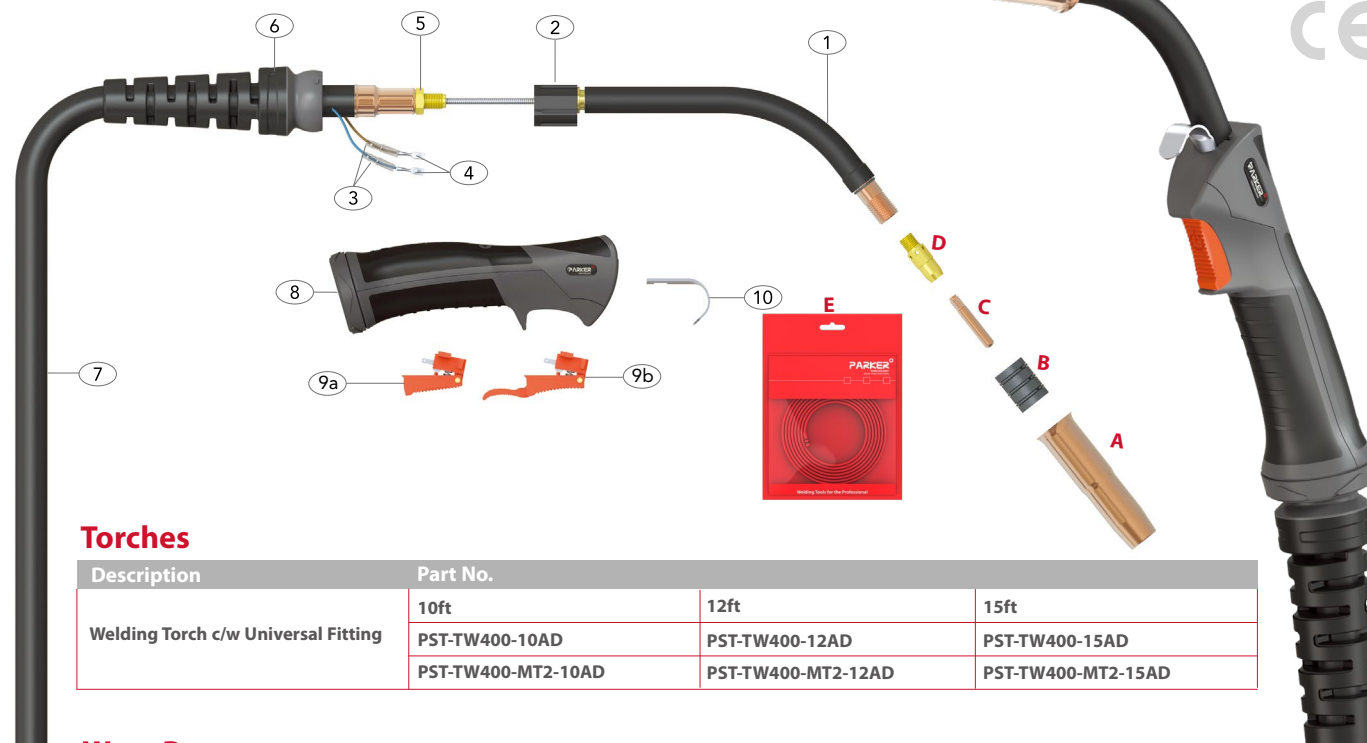

## Torches

Description	Part No.		
Welding Torch c/w Universal Fitting	10ft	12ft	15ft
	PST-TW400-10AD	PST-TW400-12AD	PST-TW400-15AD
	PST-TW400-MT2-10AD	PST-TW400-MT2-12AD	PST-TW400-MT2-15AD

## Wear Parts

### A Nozzles

Part No.	Description	Bore	Wall	Material
P24A-50	Nozzle Self Insulated	12.8	1.60mm	Copper
*P24A-62	Nozzle Self Insulated	16.0	1.60mm	Copper
P24A-75	Nozzle Self Insulated	19.0	1.60mm	Copper

### B Nozzles Insulator

Part No.	Description
*P34A	Nozzle Insulator

### C Contact Tips

Part No.	Description	Material	Wire Size	
			mm	inch
P14-30	Contact Tip	Ecu	0.8	0.030
P14-35	Contact Tip	Ecu	0.9	0.035
P14-40	Contact Tip	Ecu	1.0	0.040
P14-45	Contact Tip	Ecu	1.2	0.045
P14H-30	Contact Tip	Ecu	0.8	0.030
P14H-35	Contact Tip	Ecu	0.9	0.035
P14H-40	Contact Tip	Ecu	1.0	0.040
P14H-45	Contact Tip	Ecu	1.2	0.045

### D Diffuser

Part No.	Description	Material
P54A	Diffuser	Brass

### E Liners

Part No.	Description	Length	Wire Size	
			mm	inch
*PA44-3545-15	Steel Liner x 15ft	4.90mt	0.9-1.2	0.035-0.045
PA44-3545-15	Steel Liner x 25ft	8.10mt	0.9-1.2	0.035-0.045
*P42N-4045-15	Polyamide Liner x 15ft	4.90mt	1.0-1.2	0.040-0.045
P42N-4045-25	Polyamide Liner x 25ft	8.10mt	1.0-1.2	0.040-0.045

## Spare Parts

Part No.	Description
1	PLS-TW4 Swan Neck Assembly
2	PG1515 Ergo Handle Location Body
3	PB1521-C Cable Terminal Cover
4	PB1521 Cable Terminal
5	PB1505 Lock Nut
6	PG8016 Handle Cable Support c/w Ball Joint
7	PSTH400-10E Cable Assembly x 10ft
	PSTH400-12E Cable Assembly x 12ft
	PSTH400-15E Cable Assembly x 15ft
8	SGB2514 Handle And Lock Nut Assembly
9a	DGB2516 Standard Trigger Assembly
9b	DGB2516L Extended Trigger Assembly
10	PB2517 Hanger Hook

\*Denotes torch package standard wear part set-up  
For more information please refer to the following sections:  
• Master Wear Parts Table Page 12-14  
• Rear-End / Cable Parts Page 15-17

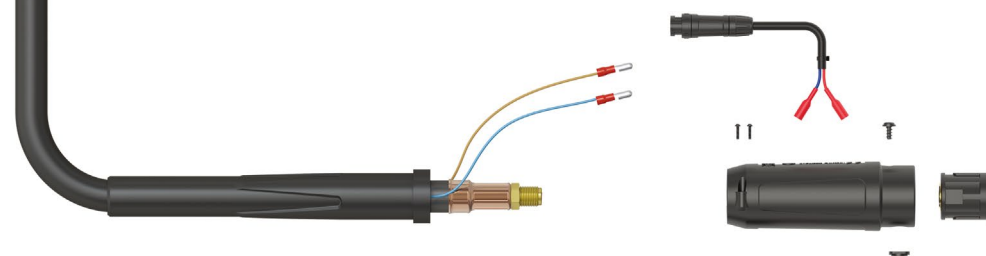

## Nozzles

### TW 180

Part No.	Description	Bore	Wall	Material
P21-37	Nozzle Self Insulated	9.5	1.60mm	Copper
*P21-50	Nozzle Self Insulated	12.7	1.60mm	Copper
P21-62	Nozzle Self Insulated	15.9	1.60mm	Copper

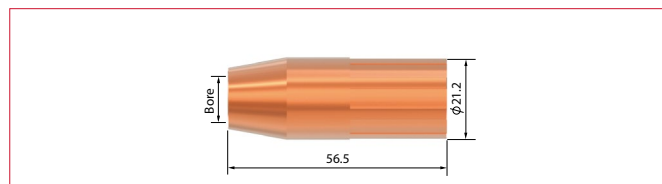

### TW 200

Part No.	Description	Bore	Wall	Material
*P22-50	Nozzle Adjustable	12.8	1.25mm	Copper
P22-62	Nozzle Adjustable	16.0	1.25mm	Copper

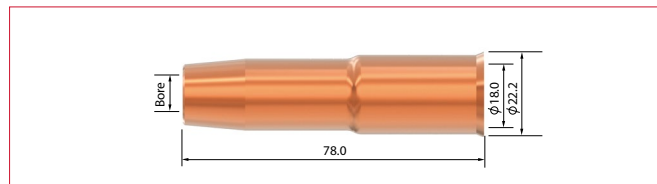

### TW 300/400

Part No.	Description	Bore	Wall	Material
P24A-50	Nozzle Adjustable	12.8	1.25mm	Copper
*P24A-62	Nozzle Adjustable	16.0	1.25mm	Copper
P24A-75	Nozzle Adjustable	19.0	1.25mm	Copper

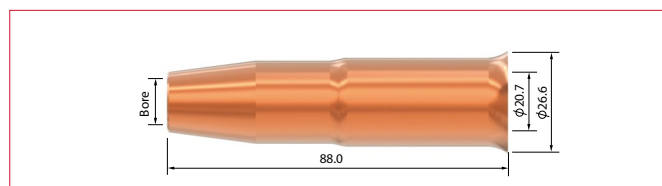

\* Denotes torch package standard wear part set-up



## Wear Parts

### Contact Tips

#### TW 180

Part No.	Description	Wire Size		Material
		mm	Inch	
P11-23	Contact Tip	0.6	0.023	Ecu
*P11-30	Contact Tip	0.8	0.030	Ecu
P11-35	Contact Tip	0.9	0.035	Ecu
P11-40	Contact Tip	1.0	0.040	Ecu

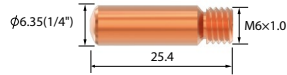

#### TW 200/300/400

Part No.	Description	Wire Size		Material
		mm	Inch	
*P14-30	Contact Tip	0.8	0.030	Ecu
P14-35	Contact Tip	0.9	0.035	Ecu
*P14-40	Contact Tip	1.0	0.040	Ecu
*P14-45	Contact Tip	1.2	0.045	Ecu

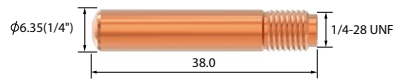

P14H-30	Contact Tip	0.8	0.030	Ecu
P14H-35	Contact Tip	0.9	0.035	Ecu
P14H-40	Contact Tip	1.0	0.040	Ecu
P14H-45	Contact Tip	1.2	0.045	Ecu

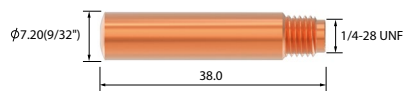

### Diffuser

#### TW 180

Part No.	Description	Material
*P51	Diffuser	Brass

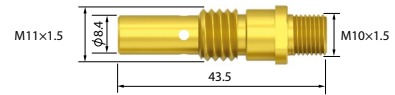

#### TW 200

Part No.	Description	Material
*P52	Diffuser	Brass

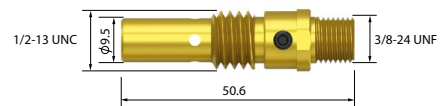

#### TW 300/400

Part No.	Description	Material
*P54A	Diffuser	Brass



\* Denotes torch package standard wear part set-up

## Liner Options 0.8-0.9mm

### TW 180/200

Part No.	Description	Length	Nipple	Wire Size	
				mm	inch
P42-3035-15	Steel Liner x 15ft	4.90mt	Brass Nipple	0.8-0.9	0.030-0.035
P42-3035-25	Steel Liner x 25ft	8.10mt	Brass Nipple	0.8-0.9	0.030-0.035



## Liner Options 0.9-1.2mm

### TW 180/200

Part No.	Description	Length	Nipple	Wire Size	
				mm	inch
PA42-4045-15	Steel Liner x 15ft	4.90mt	Brass Nipple	1.0-1.2	0.040-0.045
PA42-4045-25	Steel Liner x 25ft	8.10mt	Brass Nipple	1.0-1.2	0.040-0.045



### TW 180/200/300/400

Part No.	Description	Length	Nipple	Wire Size	
				mm	inch
P42N-4045-15	Polyamide Liner x 15ft	4.90mt	Brass Nipple	1.0-1.2	0.040-0.045
P42N-4045-25	Polyamide Liner x 25ft	8.10mt	Brass Nipple	1.0-1.2	0.040-0.045



### TW 300/400

Part No.	Description	Length	Nipple	Wire Size	
				mm	inch
*PA44-3545-15	Steel Liner x 15ft	4.90mt	Brass Nipple	0.9-1.2	0.035-0.045
PA44-3545-25	Steel Liner x 25ft	8.10mt	Brass Nipple	0.9-1.2	0.035-0.045



\* Denotes torch package standard wear part set-up

### TW 180/200

Part No.	Description
1 PC2841	Cable Support
2 PXL1542	Cable End Lock Nut
3 SCPSP1-1	Gun Plug Housing Screw
4 SCP2578HL-S	Gun Plug Housing
5 PBL1541	Gun Plug Screw
6 PECM1575-2	Hybrid Plug Body TWC 1-4
7 PB1522	Cable Terminal Male
8 PQF-SW	Male Switch Wire Plug
9 SCP2578-SP1	Housing Stopper

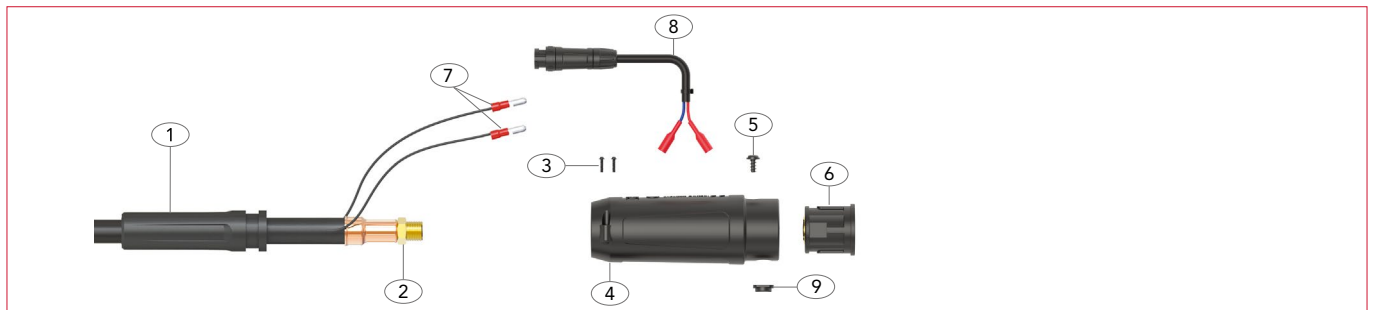

### TW 300/400

Part No.	Description
1 PA3541	Cable Support
2 PXL1542	Cable End Lock Nut
3 SCPSP1-1	Gun Plug Housing Screw
4 SCP2578HL-L	Gun Plug Housing
5 PBL1541	Gun Plug Screw
6 PECM1575-2	Hybrid Plug Body TWC 1-4
7 PB1522	Cable Terminal Male
8 PQF-SW	Male Switch Wire Plug
9 SCP2578-SP1	Housing Stopper

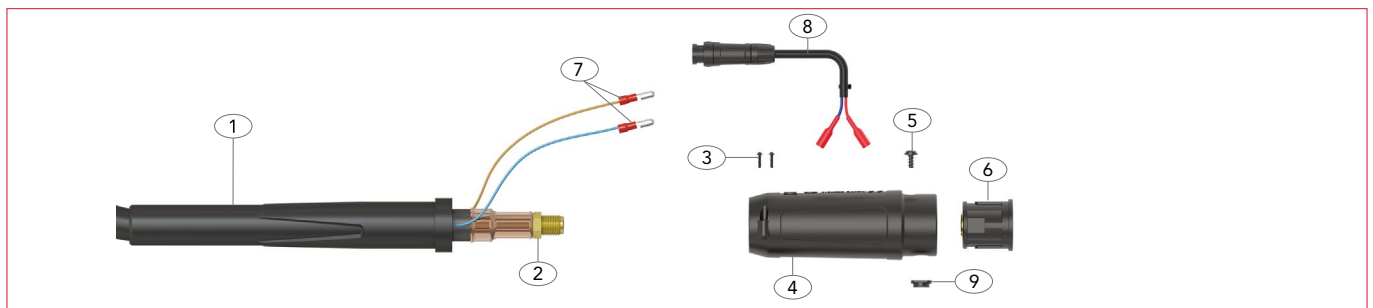

### Tweco® 1-4 Universal Kit

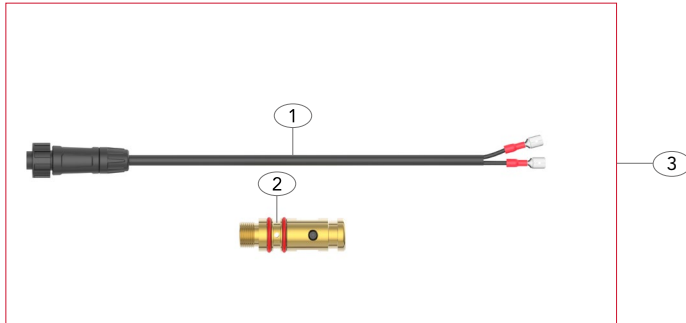

#### Direct Plug Connector

Part No.	Description
1 PECEL1575-SW-Q	Quick Fit Switch Wire Assembly
2 PECET1575-1	Tweco® 1-4 Power Pin
3 PECET1575K-Q	Quick Fit Connector Kit Complete

### Miller® - TWC 1-4 Universal Kit

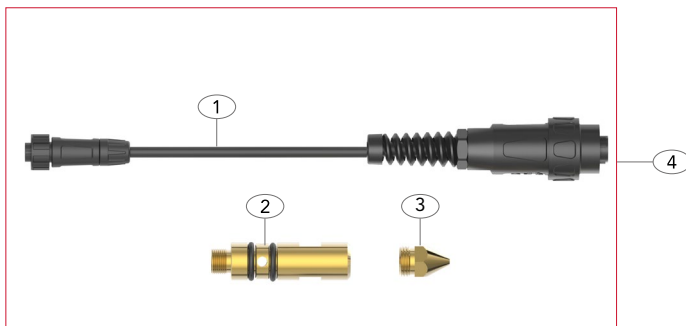

#### Direct Plug Connector

Part No.	Description
1 PECEM1575-SW-Q	Quick Fit Miller® Plug Assembly
2 PECEM1575-1	Miller® Power Pin
3 PML1570	Wire Guide 0.35"-1/16"
PML1571	Wire Guide 5/16"-3/32"(Option)
4 PECEM1575K-Q	Quick Fit Connector Kit Complete

### Lincoln® - TWC 1-4 Universal Kit

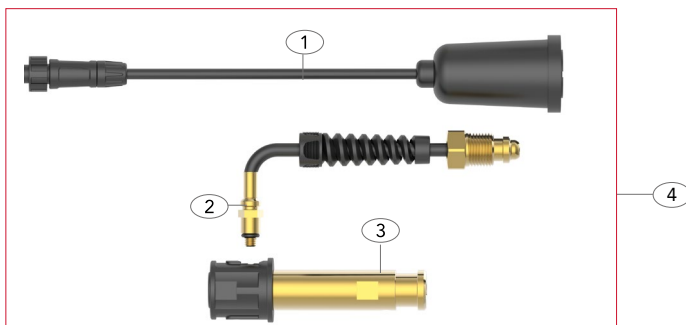

#### Direct Plug Connector

Part No.	Description
1 PM16725-Q	Quick Fit Lincoln® Plug Assembly
2 PECEL1575-G	Lincoln® Gas Tube Assembly
3 PECEL1575	Lincoln® Power Pin
4 PECEL1575K-Q	Quick Fit Connector Kit Complete

### LPW-TWC 1-4 Universal Kit

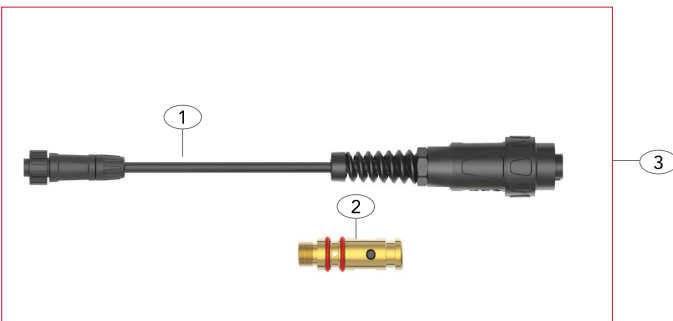

#### Direct Plug Connector

Part No.	Description
1 PECEM1575-SW-Q	Quick Fit Miller® Plug Assembly
2 PECET1575-1	Tweco® 1-4 Power Pin
3 PECEW1575K-Q	Quick Fit Connector Kit Complete



# Universal Kits Connector Kits

## LPB-TWC 1-4 Universal Kit

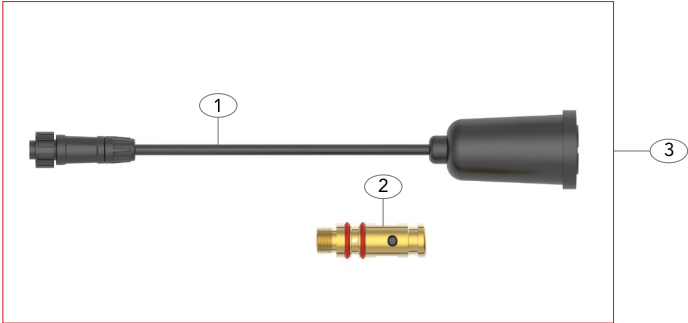

### Direct Plug Connector

Part No.	Description
1 PM16725-Q	Quick Fit Lincoln® Plug Assembly
2 PECET1575-1	Tweco® 1-4 Power Pin
3 PECEB1575K-Q	Quick Fit Connector Kit Complete

## Euro Connector Kits TWC No.2 Universal Kit

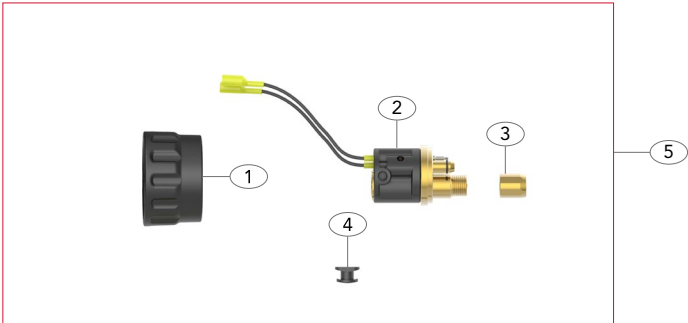

### Direct Plug Connector

Part No.	Description
1 PC1519-S	Gun Plug Nut
2 PC17EX-1	Gun Plug Body
3 PXL1826	Liner Retaining Nut
4 SCP2578-SP2	Housing Stopper
5 PC174EX-1-KIT-QS	Quick Fit Connector Kit Complete

\* Denotes torch package standard wear part set-up



**Universal Set-up Guide**  
A simple step by step guide



**JINAN UNIARC WELDING TECHNOLOGY CO., LTD**

13A Zhangjin Comprehensive Bonded Zone  
33688, Jing Shi Dong Road  
Jinan Area of China (Shandong) Pilot Free Trade Zone  
Jinan 250102, P.R. China

**Tel:** +86 531 88239823

**Website:** [www.uniarctorchology.com](http://www.uniarctorchology.com)

**Email:** [info@uniarctorchology.com](mailto:info@uniarctorchology.com)

MPP010 / V.2024.01