

MMB 501W Suregrip Multi-Mig/Mag Torch Range

Rating: 500A CO₂, 450A mixed gas, EN60974-7 @ 100% duty cycle. 1.0 to 1.6mm wires

Liquid-Cooled Mig Welding Torch

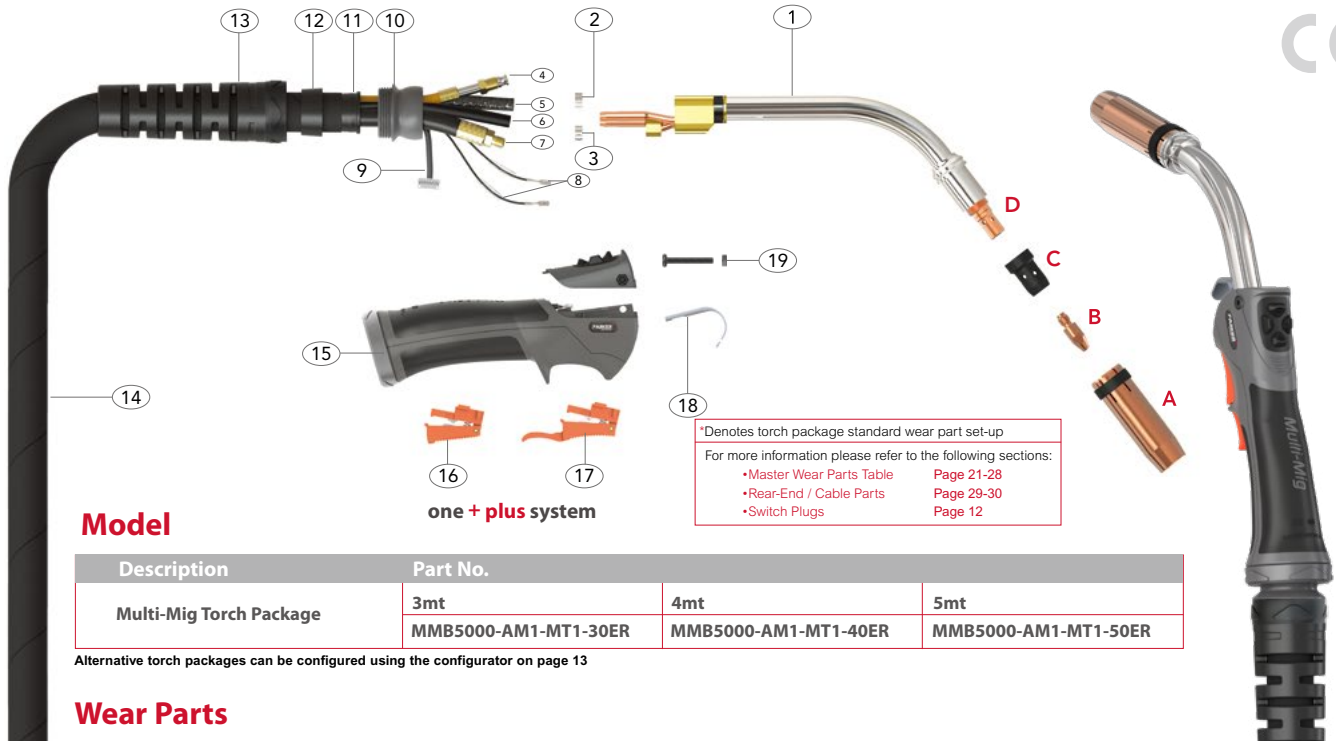

Model

Description	Part No.		
	3mt	4mt	5mt
Multi-Mig Torch Package	MMB5000-AM1-MT1-30ER	MMB5000-AM1-MT1-40ER	MMB5000-AM1-MT1-50ER

Alternative torch packages can be configured using the configurator on page 13

Wear Parts

A Nozzles

Part No.	Description	Bore	Wall	Material
PB5027	Cylindrical Nozzle	19.0	2.50mm	Cu
*PB5028	Conical Nozzle	16.0	2.50mm	Cu
PB5028HD	Conical Nozzle	16.0	3.20mm	Cu
PB5029	Tapered Nozzle	14.0	2.50mm	Cu

B Contact Tips

Part No.	Description	Material	Wire Size	
			mm	Inch
PB4014-10	Contact Tip	Cu	1.0	0.040"
PB4014-12	Contact Tip	Cu	1.2	0.045"
PB4014-16	Contact Tip	Cu	1.6	0.063"
*PB4015-12	Contact Tip	CuCrZr	1.2	0.045"
PB4015-16	Contact Tip	CuCrZr	1.6	0.063"

C Diffusers

Part No.	Description	Colour	Material
PB5005B	Diffuser	Black	DMC3
PB5005C	Diffuser	White	Ceramic
PB5005W	Diffuser	White	DMC3
*PB5005H	Diffuser-High Performance	Black	HPP

D Tip Adaptors

Part No.	Description	Material
PB5001	Tip Adaptor	Brass
*PB5001C	Tip Adaptor	CuCrZr

E Liner

Part No.	Description	Length	Wire Size
			mm
*PB5033-30	Steel Liner x 3mt	3.5mt	1.0-1.2
*PB5033-40	Steel Liner x 4mt	4.5mt	1.0-1.2
*PB5033-50	Steel Liner x 5mt	5.5mt	1.0-1.2

Spare Parts

Part No.	Description
1	PG5002 Swan Neck Assembly
2	P15400020 Hose Clamp 8.7mm
3	P15400023 Hose Clamp 10.0mm
10	PPG3208-1 Ball Joint
11	PT8010 Canvas cover Retainer Small
12	PG3235 Sheath Block
13	PGN3208-P Cable Support
14	PM5006-30 Canvas Cover Assembly x 3mt
	PM5006-40 Canvas Cover Assembly x 4mt
	PM5006-50 Canvas Cover Assembly x 5mt
15	PMT2514-KJ Multi-Mig Handle Kit
16	PDMN2516M Standard Trigger Assembly
17	PDMN2516LM Extended Trigger Assembly
18	PB2517 Hanger Hook
19	PDMNS Module Retaining Screw

Cable Parts

Description	Part No.		
	3mt	4mt	5mt
4 Outer Liner Assembly	PS5008-30	PS5008-40	PS5008-50
5 Gas Hose Assembly	PS5013-30	PS5013-40	PS5013-50
6 Water Inlet Hose Assembly	PS5012-30	PS5012-40	PS5012-50
7 Power Cable Assembly	PS5015-30	PS5015-40	PS5015-50
8 Switch Lead Assembly	PS5010-30	PS5010-40	PS5010-50
9 Control Wire Assembly	PMSWLN3	PMSWLN4	PMSWLN5
20 Water Outlet Hose	PS5017	PS5017	PS5017