

MMB 401W Suregrip Multi-Mig/Mag Torch Range

Rating: 400A CO₂, 350A mixed gas, EN60974-7 @ 100% duty cycle. 0.8 to 1.2mm wires

Liquid-Cooled Mig Welding Torch

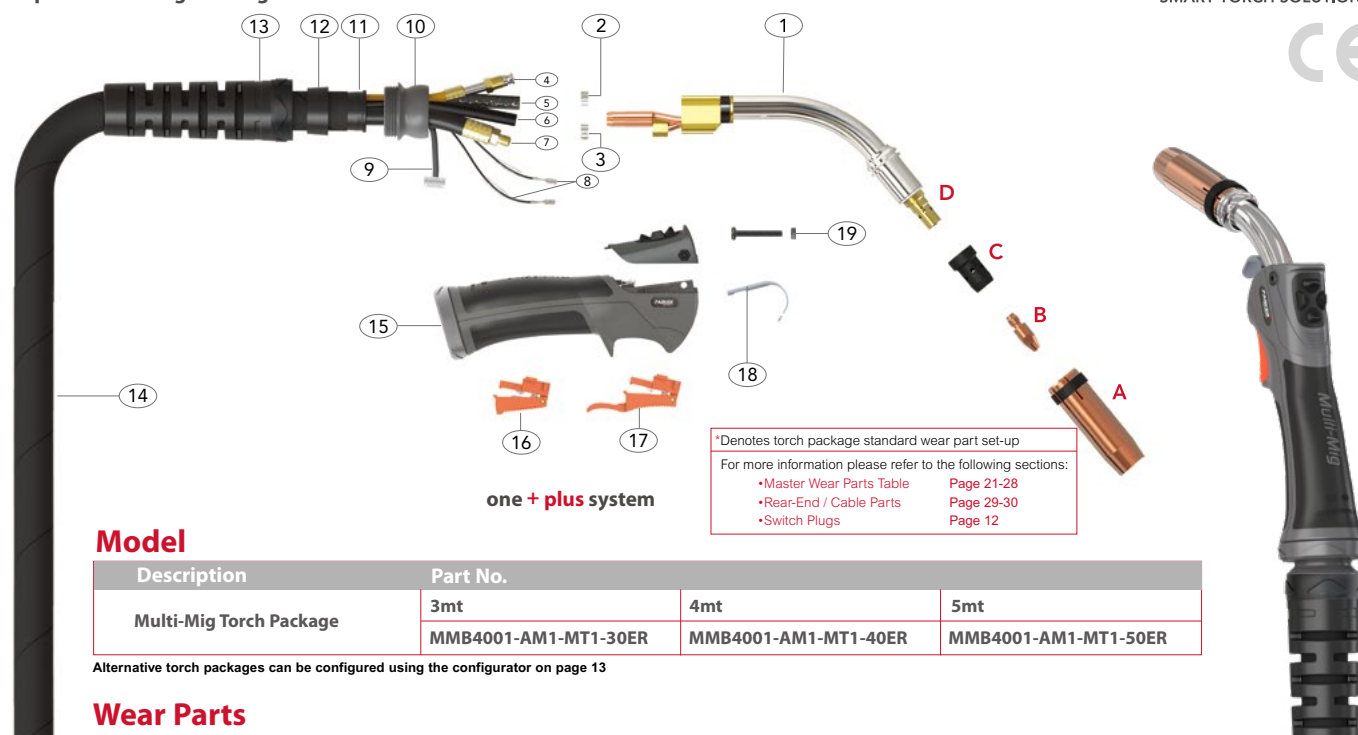

*Denotes torch package standard wear part set-up
For more information please refer to the following sections:
• Master Wear Parts Table Page 21-28
• Rear-End / Cable Parts Page 29-30
• Switch Plugs Page 12

Model

Description	Part No.		
Multi-Mig Torch Package	3mt	4mt	5mt
	MMB4001-AM1-MT1-30ER	MMB4001-AM1-MT1-40ER	MMB4001-AM1-MT1-50ER

Alternative torch packages can be configured using the configurator on page 13

Wear Parts

A Nozzles

Part No.	Description	Bore	Wall	Material
PB5027	Cylindrical Nozzle	19.0	2.50mm	Cu
*PB5028	Conical Nozzle	16.0	2.50mm	Cu
PB5028HD	Conical Nozzle	16.0	3.20mm	Cu
PB5029	Tapered Nozzle	14.0	2.50mm	Cu

B Contact Tips

Part No.	Description	Material	Wire Size
			mm Inch
PB4014-08	Contact Tip	Cu	0.8 0.030"
PB4014-10	Contact Tip	Cu	1.0 0.040"
*PB4014-12	Contact Tip	Cu	1.2 0.045"

C Diffusers

Part No.	Description	Colour	Material
*PB5005B	Diffuser	Black	DMC3
PB5005W	Diffuser	White	DMC3

D Tip Adaptors

Part No.	Description	Material
*PB5001	Tip Adaptor	Brass
PB5001C	Tip Adaptor	CuCrZr

E Liner

Part No.	Description	Length	Wire Size
			mm
*PB5033-30	Steel Liner x 3mt	3.5mt	1.0-1.2
*PB5033-40	Steel Liner x 4mt	4.5mt	1.0-1.2
*PB5033-50	Steel Liner x 5mt	5.5mt	1.0-1.2

Spare Parts

Part No.	Description
1	PG4011 Swan Neck Assembly
2	P15400020 Hose Clamp 8.7mm
3	P15400023 Hose Clamp 10.0mm
10	PPG3208-1 Ball Joint
11	PT8010 Canvas cover Retainer Small
12	PG3235 Sheath Block
13	PGN3208-P Cable Support
14	PM4006-30 Canvas Cover Assembly x 3mt
	PM4006-40 Canvas Cover Assembly x 4mt
	PM4006-50 Canvas Cover Assembly x 5mt
15	PMT2514-KJ Multi-Mig Handle Kit
16	PDMN2516M Standard Trigger Assembly
17	PDMN2516LM Extended Trigger Assembly
18	PB2517 Hanger Hook
19	PDMNS Module Retaining Screw

Cable Parts

Description	Part No.			
	3mt	4mt	5mt	
4	Outer Liner Assembly	PS5008-30	PS5008-40	PS5008-50
5	Gas Hose Assembly	PS5013-30	PS5013-40	PS5013-50
6	Water Inlet Hose Assembly	PS5012-30	PS5012-40	PS5012-50
7	Power Cable Assembly	PS4015-30	PS4015-40	PS4015-50
8	Switch Lead Assembly	PS5010-30	PS5010-40	PS5010-50
9	Control Wire Assembly	PMSWLN3	PMSWLN4	PMSWLN5
20	Water Outlet Hose	PS5017	PS5017	PS5017

