

MMB 260A Suregrip Multi-Mig/Mag Torch Range

Rating: 270A CO₂, 240A mixed gas, EN60974-7 @ 60% duty cycle. 0.8 to 1.2mm wires

Air-Cooled Mig Welding Torch

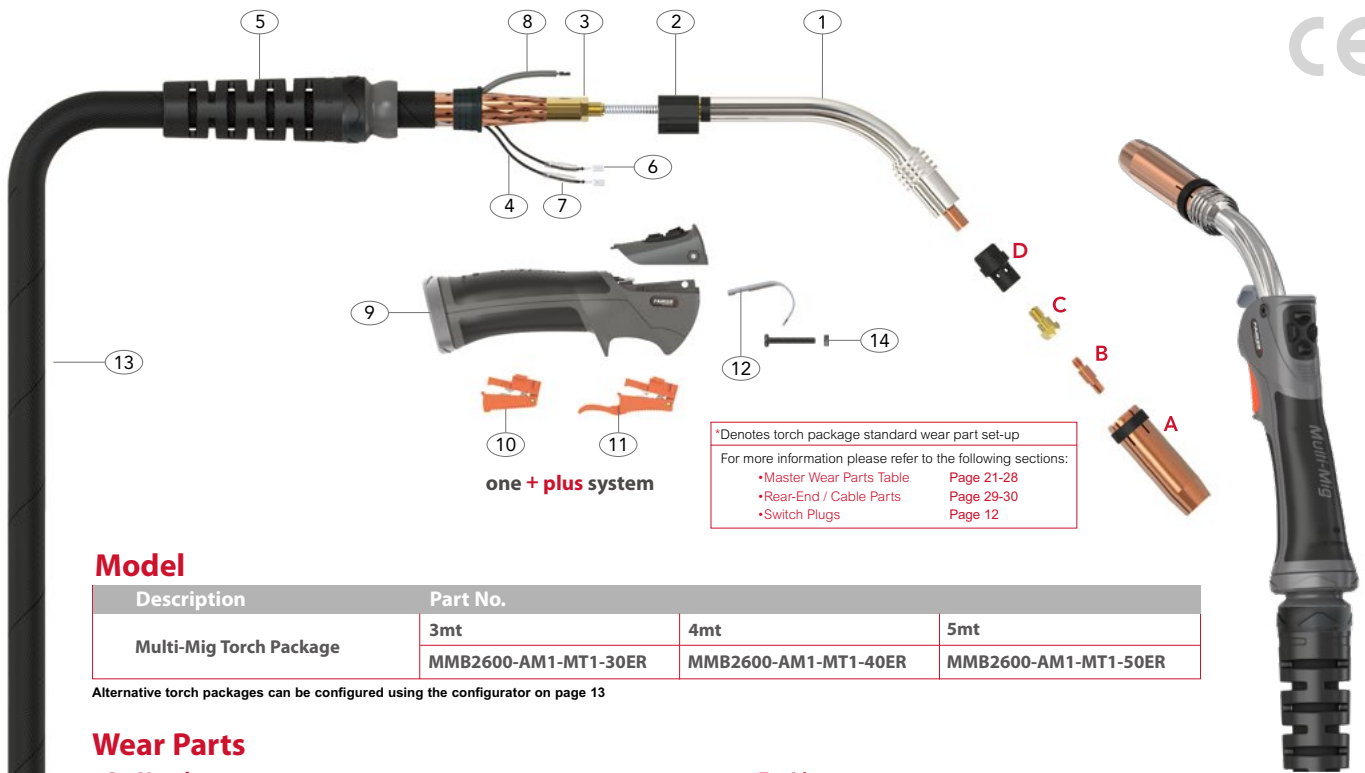

*Denotes torch package standard wear part set-up
 For more information please refer to the following sections:
 •Master Wear Parts Table Page 21-28
 •Rear-End / Cable Parts Page 29-30
 •Switch Plugs Page 12

one + plus system

Model

Description	Part No.		
	3mt	4mt	5mt
Multi-Mig Torch Package	MMB2600-AM1-MT1-30ER	MMB2600-AM1-MT1-40ER	MMB2600-AM1-MT1-50ER

Alternative torch packages can be configured using the configurator on page 13

Wear Parts

A Nozzles

Part No.	Description	Bore	Wall	Material
PB5027	Cylindrical Nozzle	19.0	2.25mm	Cu
*PB5028	Conical Nozzle	16.0	2.25mm	Cu
PB5028HD	Conical Nozzle	16.0	3.20mm	Cu
PB5029	Tapered Nozzle	14.0	2.25mm	Cu

B Contact Tips

Part No.	Description	Material	Wire Size	
			mm	Inch
PB2504-08	Contact Tip	Cu	0.8	0.030"
PB2504-10	Contact Tip	Cu	1.0	0.040"
*PB2504-12	Contact Tip	Cu	1.2	0.045"
PB2504-12A	Contact Tip	Cu	1.2	0.045"
PB2505-08	Contact Tip	CuCrZr	0.8	0.030"
PB2505-10	Contact Tip	CuCrZr	1.0	0.040"
PB2505-12	Contact Tip	CuCrZr	1.2	0.045"
PB2505-12A	Contact Tip	CuCrZr	1.2	0.045"

C Tip Adaptors

Part No.	Description	Material
*PB2612	Tip Adaptor	Brass
PB2612M8	Tip Adaptor	Brass

D Diffusers

Part No.	Description	Colour	Material
*PB2605B	Diffuser	Black	DM3
PB2605W	Diffuser	White	DM3

E Liner

Part No.	Description	Length	Wire Size
			mm
*PB2524-30	Steel Liner x 3mt	3.4mt	1.0-1.2
*PB2524-40	Steel Liner x 4mt	4.4mt	1.0-1.2
*PB2524-50	Steel Liner x 5mt	5.4mt	1.0-1.2

Spare Parts

Part No.	Description
1	PG2601 Swan Neck Assembly
2	PG1515 Ergo Handle Location Body
3	PB1505 Lock Nut
4	PS5010-30 Switch Lead Assembly x 3mt
	PS5010-40 Switch Lead Assembly x 4mt
	PS5010-50 Switch Lead Assembly x 5mt
5	PG3208 Handle Cable Support
6	PB1521 Cable Terminal
7	PB1521-C Cable Terminal Cover
8	PMSWLN3 Control Wire Assembly x 3mt
	PMSWLN4 Control Wire Assembly x 4mt
	PMSWLN5 Control Wire Assembly x 5mt
9	PMT2514-KJ Multi-Mig Handle Kit
10	PDMN2516M Standard Trigger Assembly
11	PDMN2516LM Extended Trigger Assembly
12	PB2517 Hanger Hook
13	PM2603-30 Canvas Cover Assembly x 3mt
	PM2603-40 Canvas Cover Assembly x 4mt
	PM2603-50 Canvas Cover Assembly x 5mt
14	PDMNS Module Retaining Screw

