

DURAGRIP SPOOL-ON
MIG/MAG SERIES

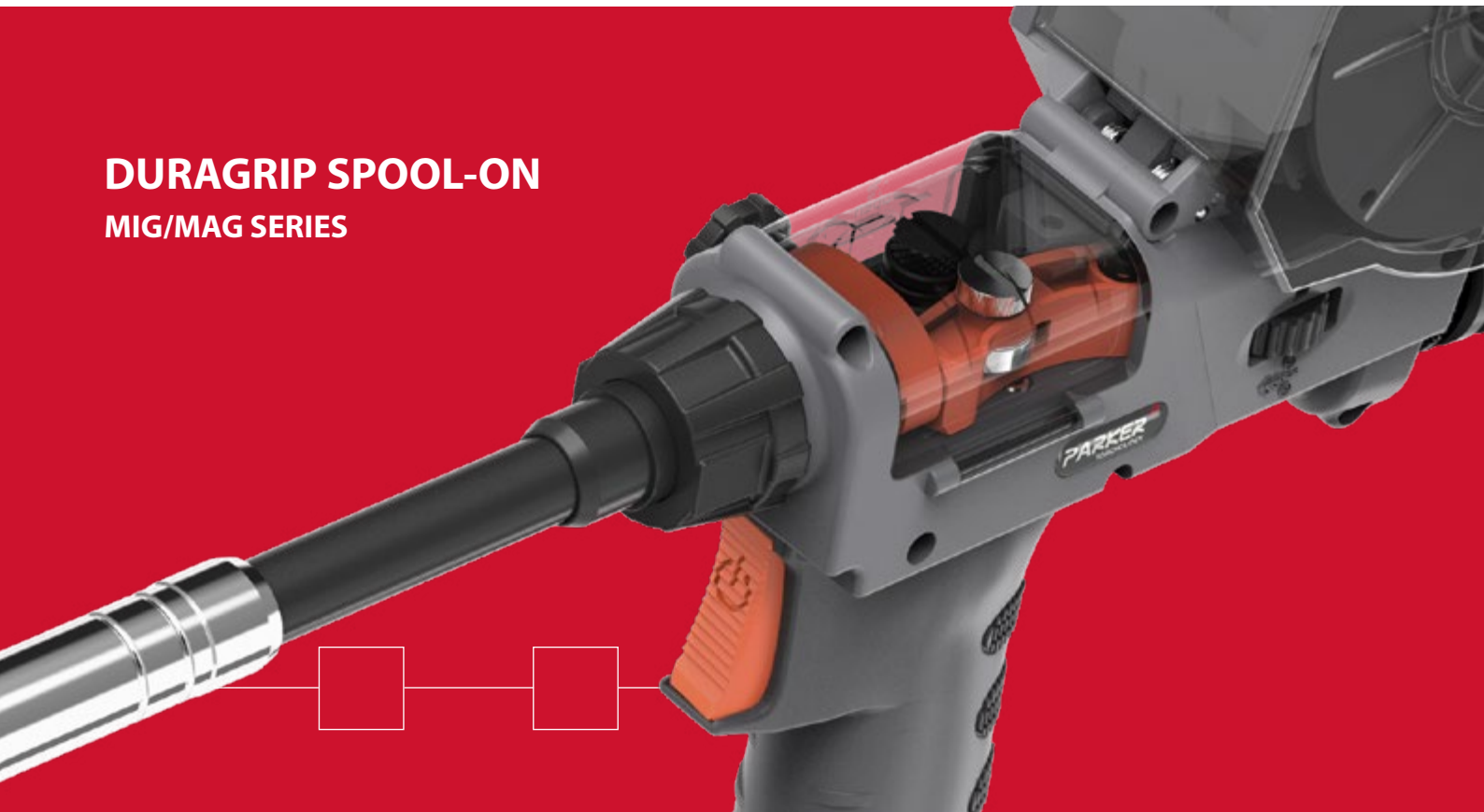

Welding Tools for the Professional

A Smart Approach

Parker Torchology is shaped by people with vision, a passion for improvement and a belief in delivering the very best Welding and Cutting Torch Range in the World.

We expect a great deal from our products, so we ask a lot of ourselves and our engineers.

Our mantra: **Innovation, Technology, Performance.**



DNA

Design and Engineering excellence are at the core of everything we do.

Every torch we build is driven by our relentless pursuit of perfection.

Premium Features

At Parker Torchology we do things differently, we strive to solve your problems with the perfect product to suit your needs. We create smart product features encased in cutting-edge design to ensure you always have the best tools to hand.





Production

A fusion of precision production engineering, our bespoke processing techniques and a fanatical attention to detail ensures every welding torch we produce is worthy of the Parker Torchology name.

Testing, Testing, Testing

It takes patience to develop a new product, it's a lot more than a great idea.

Product development is an iterative process, trying something over and over, changing one small variable at a time.

We build endless prototypes and test pieces that undergo months of rigorous testing. Only once a product has passed up to 88 different test procedures, with every single part tested separately do we consider our latest designs ready for market.

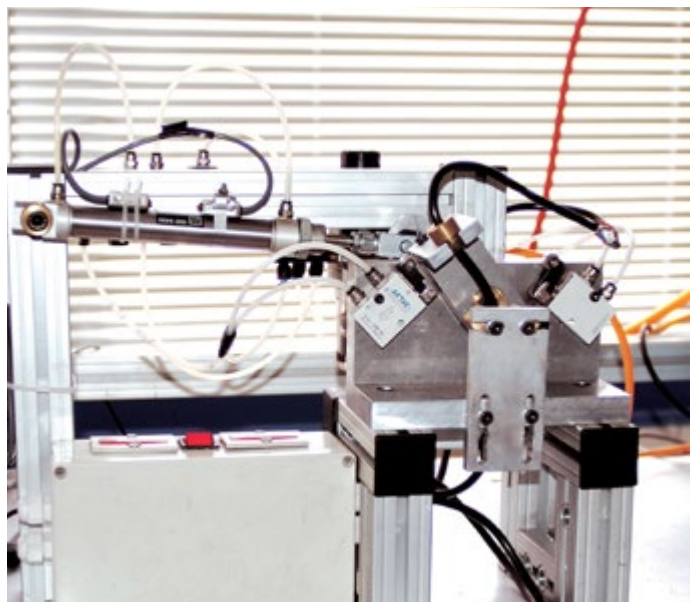

Partners

Our customers and business partners play a vital role in our development. With the core aim to strive together, we work with end-users, distributors and academic institutions alike.

As a result we share fundamental values in order to succeed in our respective market places, supporting economic growth and collaborative opportunities with others.

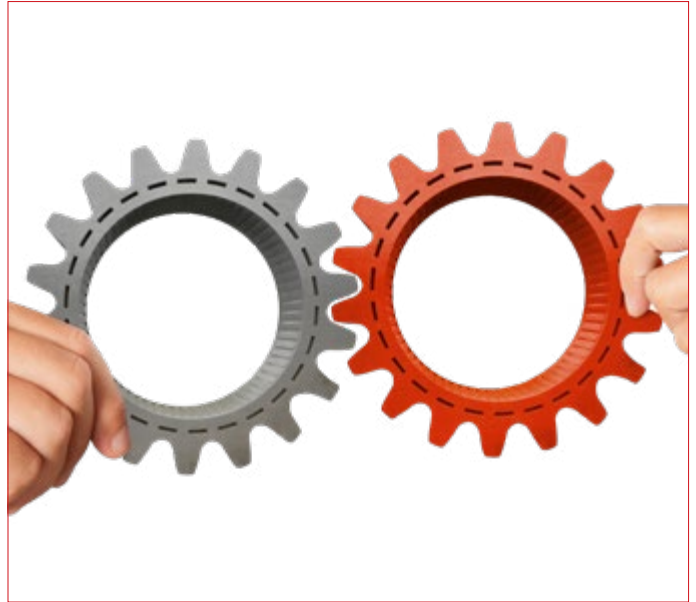

A Bright Future

Technology doesn't stand still, which is why we are constantly innovating to bring you the best products on the market.

Our strong vision and focused innovation strategy, not to mention our passion to revolutionize the industry, ensure that Parker Torchology is a byword for excellence.

We Talk Torches

Contents

Duragrip Spool-On Mig/Mag Torch Range Features Focus	6
Duragrip Spool-On Mig/Mag Torch Range Overview and Ratings	8
Spool-On Mig/Mag Specification Information	
Torch Package Configurator	9

Torch Range

Duragrip Spool-On Mig/Mag DSP 150A	10
Duragrip Spool-On Mig/Mag DSP 240A	12
Duragrip Spool-On Mig/Mag DSP 250A	14
Duragrip Spool-On Mig/Mag DSP 360A	16

Air-Cooled

Wear Parts

Nozzles	18
Contact Tips	19
Tip Adaptors	20
Diffusers	20

Rear-End Spare Parts	21
-----------------------------	----

Duragrip Spool-On Mig/Mag Gun Range

Air-Cooled Features Focus

Air-Cooled

Spool-on guns are compact in design and offer a cost effective solution for low deposition Mig welding and precise control of soft wires.

A Cost Effective Solution for Long Distance and Low Deposition Welding



100% Binzel® Wear Parts Compatibility Guaranteed

Quality Wear Parts

All wear parts are manufactured to exacting specifications ensuring reliability, longevity and superior performance

- The same wear parts are utilized as standard BZL ranges minimizing stock handling
- Contact tips are manufactured using high quality copper alloys
- High-performance tip adaptors, diffusers and swan necks

Ergonomics – For Comfort and Handleability

Every detail has been considered to ensure the welder has the very best handling

- Improved balance and positionability resulting in reduced welder fatigue
- A knuckle joint enables small movements of the handle independently of the cable assembly
- Variable speed control at the handle



Infinately Adjustable Wire Tension

- A unique lever action wire retainer and brake system holds all soft wire spools in place at the correct brake tension
- A further secondary brake system is integrated into the spool holder for independent adjustment of larger steel wires on all torches over 200 Amp

Features Focus

Welding Tools for the Professional



Precision and Visibility

- Precise and constant wire feed
- Contact pressure of the feed rollers regulated directly on the handle
- Transparent window for quick and easy reference to all moving parts
- Rapid access for wire changes
- 24V or 42V Feed Motors

Flexibility and Durability

- A unique Duraflex Ultralite cable system has been developed with all torch supply elements integrated into the cable



Terminations

- Terminations available in Euro and direct plug options
- The Euro body has been redesigned to improve gas seal integrity in Argon applications
- Our spring pins – often copied,, can't be beaten

The Smart Way To Buy Welding and Cutting Tools



Duragrip Spool-On Mig/Mag Torch Range

Ratings: 180 Amp to 300 Amp, Mixed Gas



Model	DSP 150A	DSP 240A	DSP 250A	DSP 360A
Technical Data				
Cooling Method	Air-Cooled	Air-Cooled	Air-Cooled	Air-Cooled
Rating: CO ₂	180A	220A	230A	300A
Rating: Mixed Gas	150A	200A	200A	270A
Duty Cycle	35%	35%	35%	35%
Wire Size: AL	0.8-1.0	0.8-1.2	0.8-1.2	0.8-1.2
Wire Size: Steel	0.8-1.0	0.8-1.0	0.8-1.0	0.8-1.0
Motor Voltage	24V and 42V	24V and 42V	24V and 42V	24V and 42V
Motor Life	1000 Hours	1000 Hours	1000 Hours	1000 Hours
Order Codes				
24V	DSP150A-24-P1-60ER	DSP240A-24-P1-60ER	DSP250A-24-P1-60ER	DSP360A-24-P1-60ER
42V	DSP150A-42-P1-60ER	DSP240A-42-P1-60ER	DSP250A-42-P1-60ER	DSP360A-42-P1-60ER

Duragrip Spool-On Mig/Mag Torch Range

Torch Package Configurator

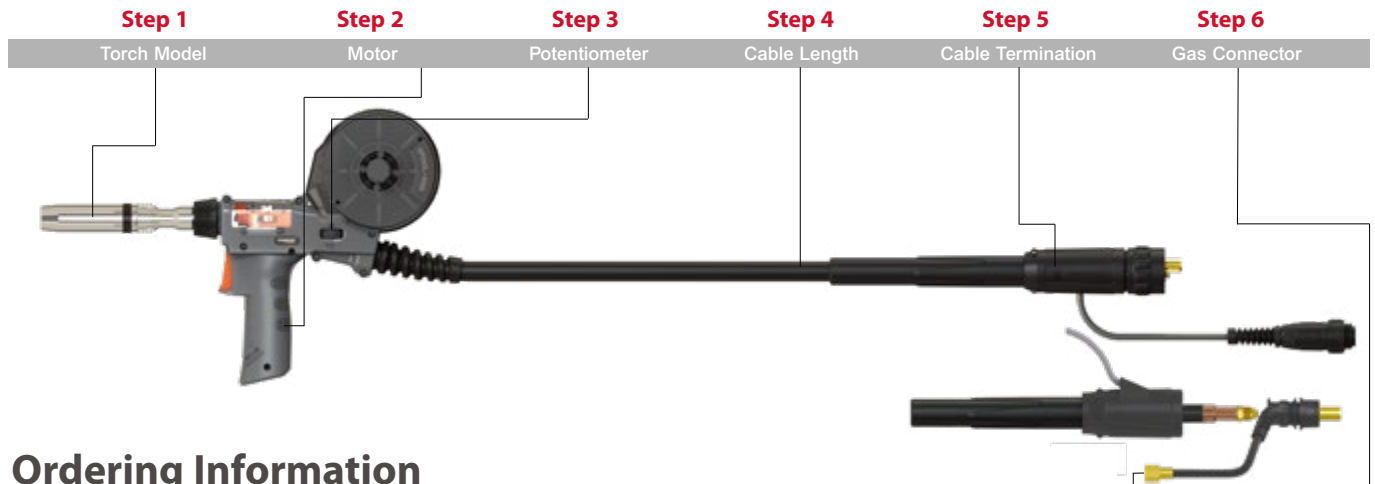

Ordering Information

Torch package part numbering is configured using the simple 6 stage system outlined below:

1. Select the correct model of torch
2. Select the motor voltage required
3. Select the potentiometer value if required
4. Select the length of cable required
5. Select the cable termination required
6. Select the gas connector if required

Example: DSP360A-42-P1-60ER

Duragrip Spool On Mig 360A Air-Cooled Torch Package c/w 42V Motor, 1K Potentiometer, Euro End x 6mt

Step 1		Step 2		Step 3		Step 4		Step 5		Step 6	
Torch Model		Motor		Potentiometer		Cable Length		Cable Termination		Gas Connector	
Part No.	Description			Part No.	Description			Part No.	Description		
DSP150A	180A Torch Range			P1	Potentiometer Kit 1K			GS1	Gas Supply Hose c/w 3/8" BSP		
DSP240A	220A Torch Range			P5	Potentiometer Kit 5K			GS8	Gas Supply Hose c/w M12 x 1.0		
DSP250A	230A Torch Range			P10	Potentiometer Kit 10K			GS7	Gas Supply Hose c/w 5/8" UNF RH		
DSP360A	300A Torch Range			P25	Potentiometer Kit 25K						
				N	No Potentiometer						
Part No.	Description			Part No.	Description			Part No.	Description		
24	Motor 24V DC			60ER	Cable Assembly x 6mt			DN	Surelok Connector		
42	Motor 42V DC							ER	Euro Connector		

DSP 150A Duragrip Spool-On Mig/Mag Torch Range

Rating: 180A CO₂, 150A mixed gas, EN60974-7 @ 35% duty cycle. 0.8 to 1.0mm wires

Air-Cooled Mig Welding Torch

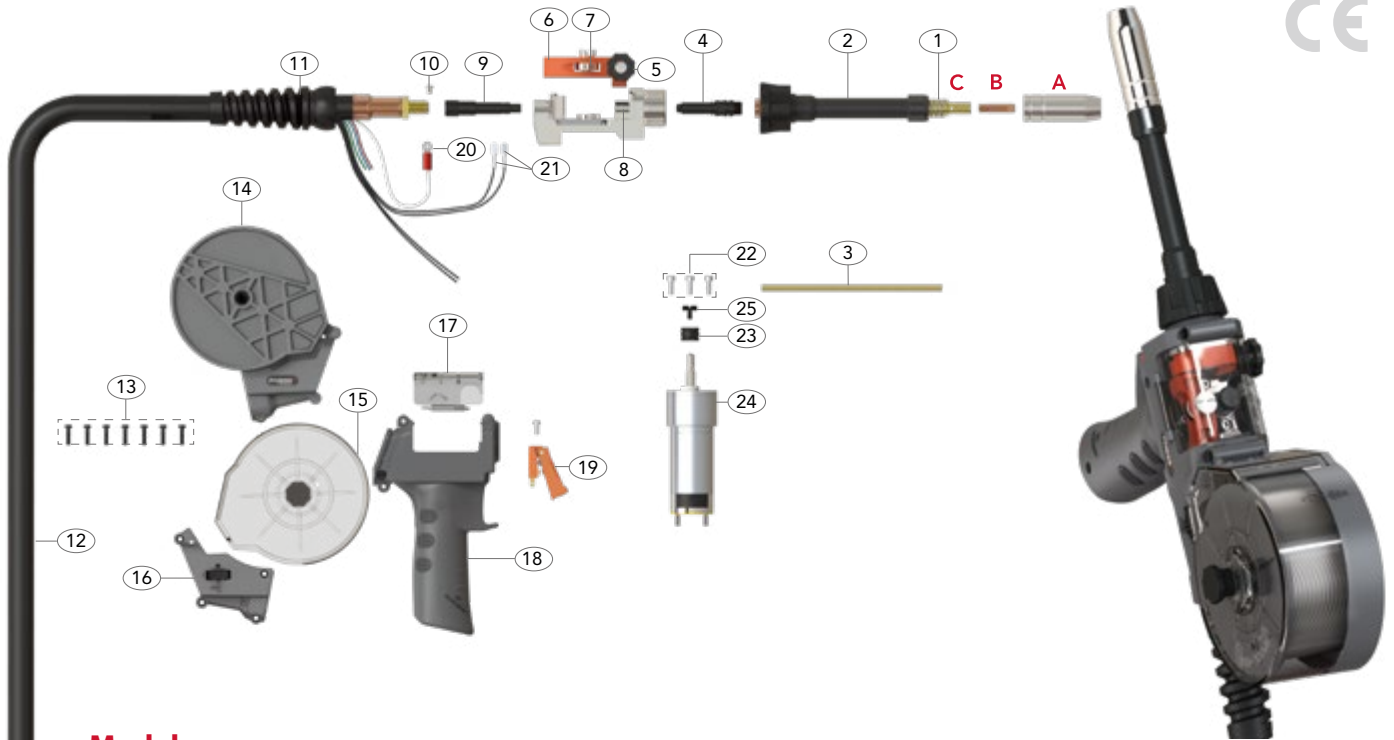

Model

Description	Part No.
	6mt
Spool-On 24V Mig Torch Euro End	DSP150A-24-P1-60ER
Spool-On 42V Mig Torch Euro End	DSP150A-42-P1-60ER
Spool-On 24V Mig Torch Surelok End	DSP150A-24-P1-60DN-GS1
Spool-On 42V Mig Torch Surelok End	DSP150A-42-P1-60DN-GS1

Alternative torch packages can be configured using the configurator on page 9

Wear Parts

A Nozzles

Part No.	Description	Wall	Material	Bore
PB1529	Cylindrical Nozzle	0.9mm	Cu	16.0
*PB1530	Conical Nozzle	0.9mm	Cu	12.0
PB1531	Tapered Nozzle	0.9mm	Cu	10.5
PB1532	Bottle Nozzle	0.9mm	Cu	12.8
PB1533	Spot Welding Nozzle	0.9mm	Cu	16.0

B Contact Tips

Part No.	Description	Material	Wire Size
			mm Inch
*PB1527-08	Contact Tip	Cu	0.8 0.030
PB1527-09	Contact Tip	Cu	0.9 0.035
PB1527-10	Contact Tip	Cu	1.0 0.040

C Tip Adaptors

Part No.	Description	Material
*PB1507L/H	Tip Adaptor Left Hand	Brass

*Denotes torch package standard wear part set-up
For more information please refer to the following sections:
• Master Wear Parts Table Page 18-20
• Rear-End / Cable Parts Page 21

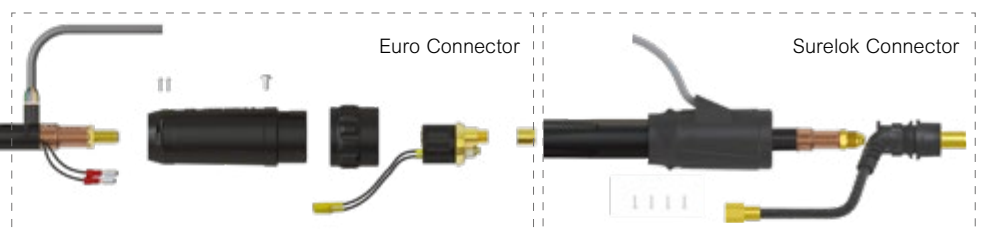

DSP 150A Duragrip Spool-On Mig/Mag Torch Range

Rating: 180A CO₂, 150A mixed gas, EN60974-7 @ 35% duty cycle. 0.8 to 1.0mm wires

Air-Cooled Mig Welding Torch



Spare Parts

Part No.	Description
1	PB1504 Shroud Spring
2	PSP1501 Straight Neck Assembly
3	PSP1502 Jump Liner
4	PGP36006 Jump Liner Nipple
5	PGP36402B Tension Knob
6	PGP36402 Pressure Arm Assembly
7	PGP36402R Pressure Roll
8	PSP36001 Motor Body
9	PSP36006 Wire Guide
10	SCP2563 Screw
11	PMIG8015 Cable Support
12	DSP1517-60ER Coax Cable Assembly Euro Type
	DSP1517-60DN Coax Cable Assembly Dinse Type
13	PKA3X20 Handle Screw Pack
14	PSP2515SP-B Spool Holder
15	PSP2515SP-C Spool Cover
16	PSP2515SP-PT-1K Wire Speed Control 1K Ω
	PSP2515SP-PT-5K Wire Speed Control 5K Ω
	PSP2515SP-PT-10K Wire Speed Control 10K Ω
	PSP2515SP-PT-25K Wire Speed Control 25K Ω
	PSP2515SP-PT0 No Potentiometer

Part No.	Description
17	PGP2514-C Push-Pull Handle Cover
18	PCSP2515-KJ Spool-On Handle
19	PGP2516 Push-Pull Trigger
20	SCP2597 Circular Cable Terminal
21	PB1521 Cable Terminal
22	PGPMS1 Motor Screw Pack
23*	SGP7020W-08 Drive Roll For Steel Wire φ 0.8
	SGP7020W-09 Drive Roll For Steel Wire φ 0.9
	SGP7020W-10 Drive Roll For Steel Wire φ 1.0
	SGP7020W-08U Drive Roll For Al Wire φ 0.8
	SGP7020W-09U Drive Roll For Al Wire φ 0.9
	SGP7020W-10U Drive Roll For Al Wire φ 1.0
24	SGP7020-24 Motor 24V DC
	SGP7020-42 Motor 42V DC
25	PGP7020-24-4 Screw

DSP 240A Duragrip Spool-On Mig/Mag Torch Range

Rating: 250A CO₂, 220A mixed gas, EN60974-7 @ 35% duty cycle. 0.8 to 1.2mm wires

Air-Cooled Mig Welding Torch

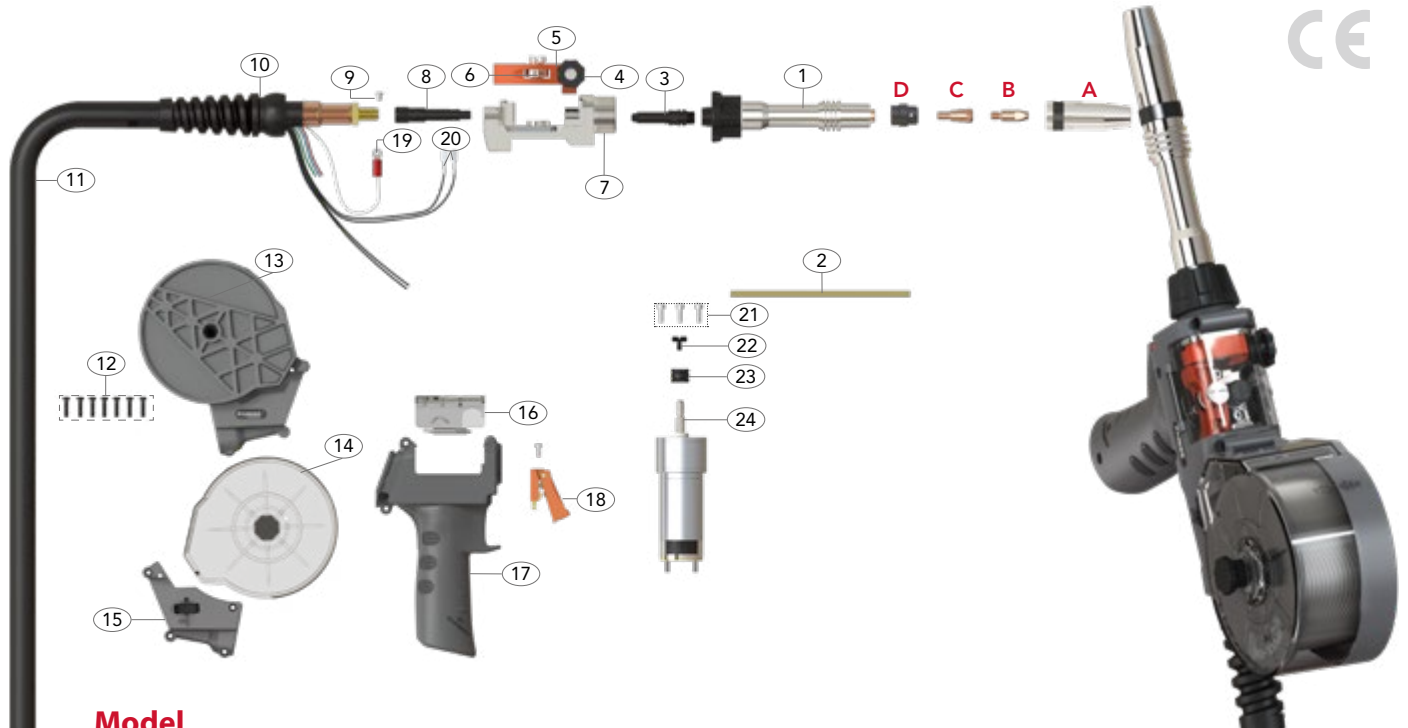

Model

Description	Part No.
	6mt
Spool-On 24V Mig Torch Euro End	DSP240A-24-P1-60ER
Spool-On 42V Mig Torch Euro End	DSP240A-42-P1-60ER
Spool-On 24V Mig Torch Surelok End	DSP240A-24-P1-60DN-GS1
Spool-On 42V Mig Torch Surelok End	DSP240A-42-P1-60DN-GS1

Alternative torch packages can be configured using the configurator on page 9

Wear Parts

A Nozzles

Part No.	Description	Wall	Material	Bore
PB2415	Cylindrical Nozzle	1.40mm	Cu	17.2
*PB2416	Conical Nozzle	1.40mm	Cu	12.6
PB2417	Tapered Nozzle	1.40mm	Cu	10.0

B Contact Tips

Part No.	Description	Material	Wire Size	mm	Inch
PB2504-08	Contact Tip	Cu	0.8	0.030	
PB2504-09	Contact Tip	Cu	0.9	0.035	
PB2504-10	Contact Tip	Cu	1.0	0.040	
PB2504-12	Contact Tip	Cu	1.2	0.045	
*PB2504-10A	Contact Tip	Cu	1.0	0.040	
PB2505-08	Contact Tip	CuCrZr	0.8	0.030	
PB2505-09	Contact Tip	CuCrZr	0.9	0.035	
PB2505-10	Contact Tip	CuCrZr	1.0	0.040	
PB2505-10A	Contact Tip	CuCrZr	1.0	0.040	
PB2505-12A	Contact Tip	CuCrZr	1.2	0.045	

C Tip Adaptors

Part No.	Description	Material
*PB2412	Tip Adaptor	Brass

D Diffusers

Part No.	Description	Material	Colour
*PB2405B	Diffuser	DMC3	Black
PB2405C	Diffuser	Ceramic	White
PB2405W	Diffuser	DMC3	White
PB2405S	Diffuser	Silicon	Red

*Denotes torch package standard wear part set-up
For more information please refer to the following sections:
•Master Wear Parts Table Page 18-20
•Rear-End / Cable Parts Page 21

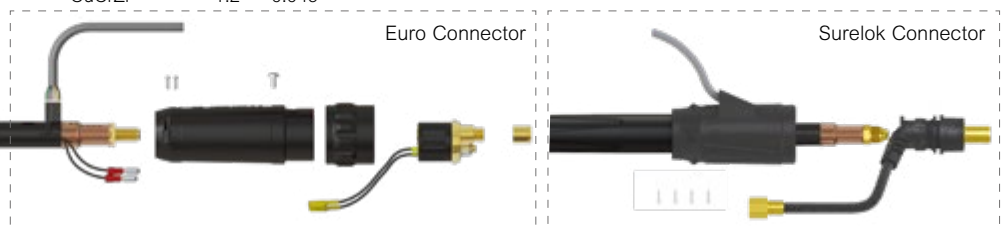

DSP 240A Duragrip Spool-On Mig/Mag Torch Range

Rating: 220A CO₂, 200A mixed gas, EN60974-7 @ 35% duty cycle. 0.8 to 1.2mm wires

Air-Cooled Mig Welding Torch



Spare Parts

Part No.	Description
1	PSP2401A Straight Neck Assembly
2	PGP3602A Jump Liner
3	PGP36006 Jump Liner Nipple
4	PGP36402B Tension Knob
5	PGP36402 Pressure Arm Assembly
6	PGP36402R Pressure Roll
7	PSP36001 Motor Body
8	PSP36006 Wire Guide
9	SCP2563 Screw
10	PMIG8015 Cable Support
11	DSP2403-60ER Coax Cable Assembly, Euro Type
	DSP2403-60DN Coax Cable Assembly, Dinse Type
12	PKA3X20 Handle Screw Pack
13	PSP2515SP-B Spool Holder
14	PSP2515SP-C Spool Cover
15	PSP2515SP-PT-1K Wire Speed Control 1K Ω
	PSP2515SP-PT-5K Wire Speed Control 5K Ω
	PSP2515SP-PT-10K Wire Speed Control 10K Ω
	PSP2515SP-PT-25K Wire Speed Control 25K Ω
	PSP2515SP-PT0 No Potentiometer

Part No.	Description
16	PGP2514-C Push-Pull Handle Cover
17	PCSP2515-KJ Spool-On Handle
18	PGP2516 Push-Pull Trigger
19	SCP2597 Circular Cable Terminal
20	PB1521 Cable Terminal
21	PGPMS1 Motor Screw Pack
22	PGP7020-24-4 Screw
23	SGP7020W-08 Drive Roll For Steel Wire ϕ 0.8
	SGP7020W-09 Drive Roll For Steel Wire ϕ 0.9
	SGP7020W-10 Drive Roll For Steel Wire ϕ 1.0
	SGP7020W-08U Drive Roll For Al Wire ϕ 0.8
	SGP7020W-09U Drive Roll For Al Wire ϕ 0.9
	*SGP7020W-10U Drive Roll For Al Wire ϕ 1.0
	SGP7020W-12U Drive Roll For Al Wire ϕ 1.2
24	SGP7020-24 Motor 24V DC
	SGP7020-42 Motor 42V DC

DSP 250A Duragrip Spool-On Mig/Mag Torch Range

Rating: 230A CO₂, 200A mixed gas, EN60974-7 @ 35% duty cycle. 0.8 to 1.2mm wires

Air-Cooled Mig Welding Torch

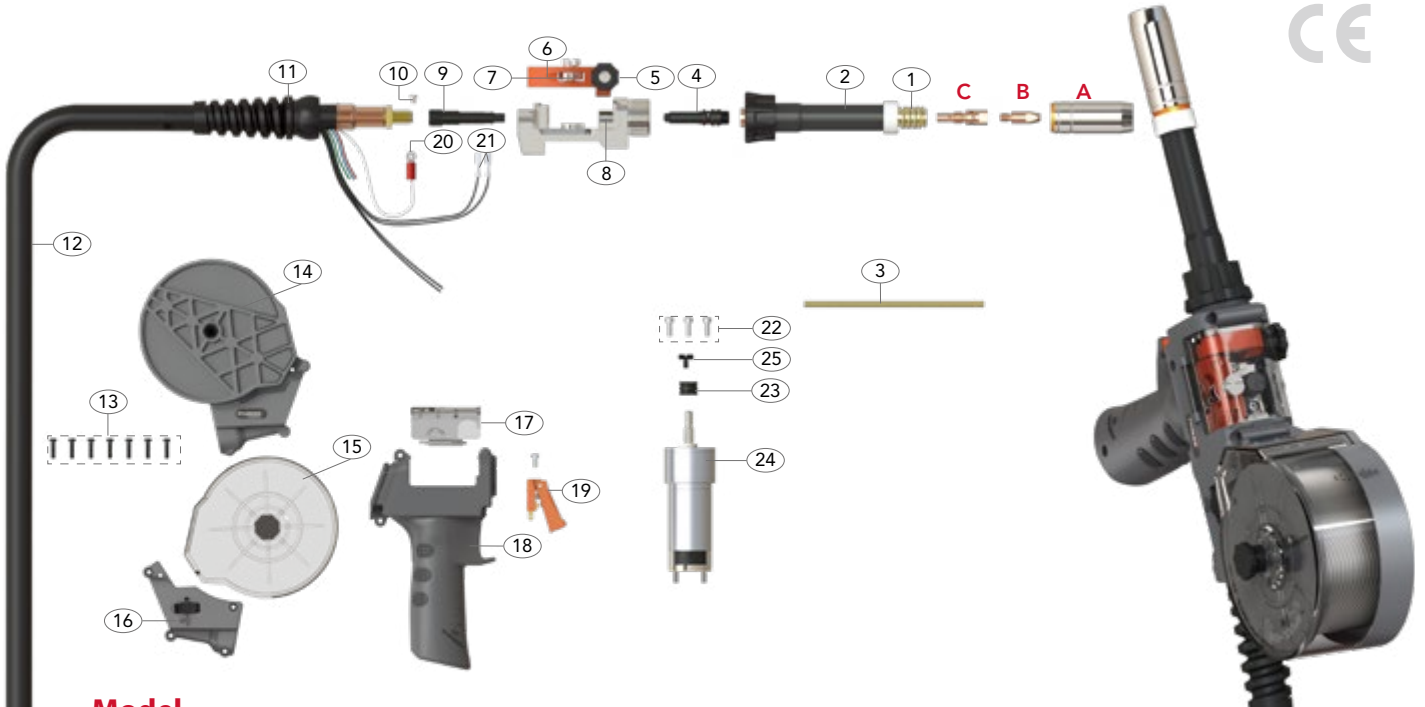

Model

Description	Part No.
	6mt
Spool-On 24V Mig Torch Euro End	DSP250A-24-60ER
Spool-On 42V Mig Torch Euro End	DSP250A-42-60ER
Spool-On 24V Mig Torch Euro End	DSP250A-24-P1-60ER
Spool-On 42V Mig Torch Euro End	DSP250A-42-P1-60ER
Spool-On 24V Mig Torch Surelok End	DSP250A-24-P1-60DN-GS1
Spool-On 42V Mig Torch Surelok End	DSP250A-42-P1-60DN-GS1

Alternative torch packages can be configured using the configurator on page 9

Wear Parts

A Nozzles

Part No.	Description	Wall	Material	Bore
PB2507	Cylindrical Nozzle	1.5mm	Cu	18.0
*PB2508	Conical Nozzle	1.5mm	Cu	15.0
PB2509	Tapered Nozzle	1.5mm	Cu	12.0

C Tip Adaptors

Part No.	Description	Material
*PB2506	Tip Adaptor	Brass
PB2536	Tip Adaptor M8	Brass

B Contact Tips

Part No.	Description	Material	Wire Size	
			mm	Inch
PB2504-08	Contact Tip	Cu	0.8	0.030
PB2504-09	Contact Tip	Cu	0.9	0.035
PB2504-10	Contact Tip	Cu	1.0	0.040
PB2504-12	Contact Tip	Cu	1.2	0.045
*PB2504-10A	Contact Tip	Cu	1.0	0.040
PB2505-08	Contact Tip	CuCrZr	0.8	0.030
PB2505-09	Contact Tip	CuCrZr	0.9	0.035
PB2505-10	Contact Tip	CuCrZr	1.0	0.040
PB2505-10A	Contact Tip	CuCrZr	1.0	0.040
PB2505-12A	Contact Tip	CuCrZr	1.2	0.045

*Denotes torch package standard wear part set-up
For more information please refer to the following sections:
•Master Wear Parts Table Page 18-20
•Rear-End / Cable Parts Page 21

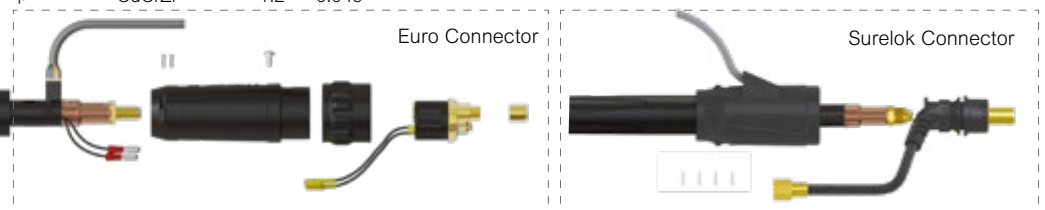

DSP 250A Duragrip Spool-On Mig/Mag Torch Range

Rating: 230A CO₂, 200A mixed gas, EN60974-7 @ 35% duty cycle. 0.8 to 1.2mm wires

Air-Cooled Mig Welding Torch



Spare Parts

Part No.	Description
1	PB2502 Shroud Spring
2	PSP2501 Straight Neck Assembly
3	PGP3602A Jump Liner
4	PGP36006 Jump Liner Nipple
5	PGP36402B Tension Knob
6	PGP36402 Pressure Arm Assembly
7	PGP36402R Pressure Roll
8	PSP36001 Motor Body
9	PSP36006 Wire Guide
10	SCP2563 Screw
11	PMIG8015 Cable Support
12	DSP2503-60ER Coax Cable Assembly Euro Type
	DSP2503-60DN Coax Cable Assembly Dinse Type
13	PKA3X20 Handle Screw Pack
14	PSP2515SP-B Spool Holder
15	PSP2515SP-C Spool Cover
16	PSP2515SP-PT-1K Wire Speed Control 1K Ω
	PSP2515SP-PT-5K Wire Speed Control 5K Ω
	PSP2515SP-PT-10K Wire Speed Control 10K Ω
	PSP2515SP-PT-25K Wire Speed Control 25K Ω
	PSP2515SP-PT0 No Potentiometer

Part No.	Description
17	PGP2514-C Push-Pull Handle Cover
18	PCSP2515-KJ Spool-On Handle
19	PGP2516 Push-Pull Trigger
20	SCP2597 Circular Cable Terminal
21	PM1521 Cable Terminal
22	PGPMS1 Motor Screw Pack
23	SGP7020W-08 Drive Roll For Steel Wire ϕ 0.8
	SGP7020W-09 Drive Roll For Steel Wire ϕ 0.9
	SGP7020W-10 Drive Roll For Al Wire ϕ 1.0
	SGP7020W-08U Drive Roll For Al Wire ϕ 0.8
	SGP7020W-09U Drive Roll For Al Wire ϕ 0.9
	*SGP7020W-10U Drive Roll For Al Wire ϕ 1.0
	SGP7020W-12U Drive Roll For Al Wire ϕ 1.2
24	SGP7020-24 Motor 24V DC
	SGP7020-42 Motor 42V DC
25	PGP7020-24-4 Screw

DSP 360A Duragrip Spool-On Mig/Mag Torch Range

Rating: 300A CO₂, 270A mixed gas, EN60974-7 @ 35% duty cycle. 0.8 to 1.2mm wires

Air-Cooled Mig Welding Torch

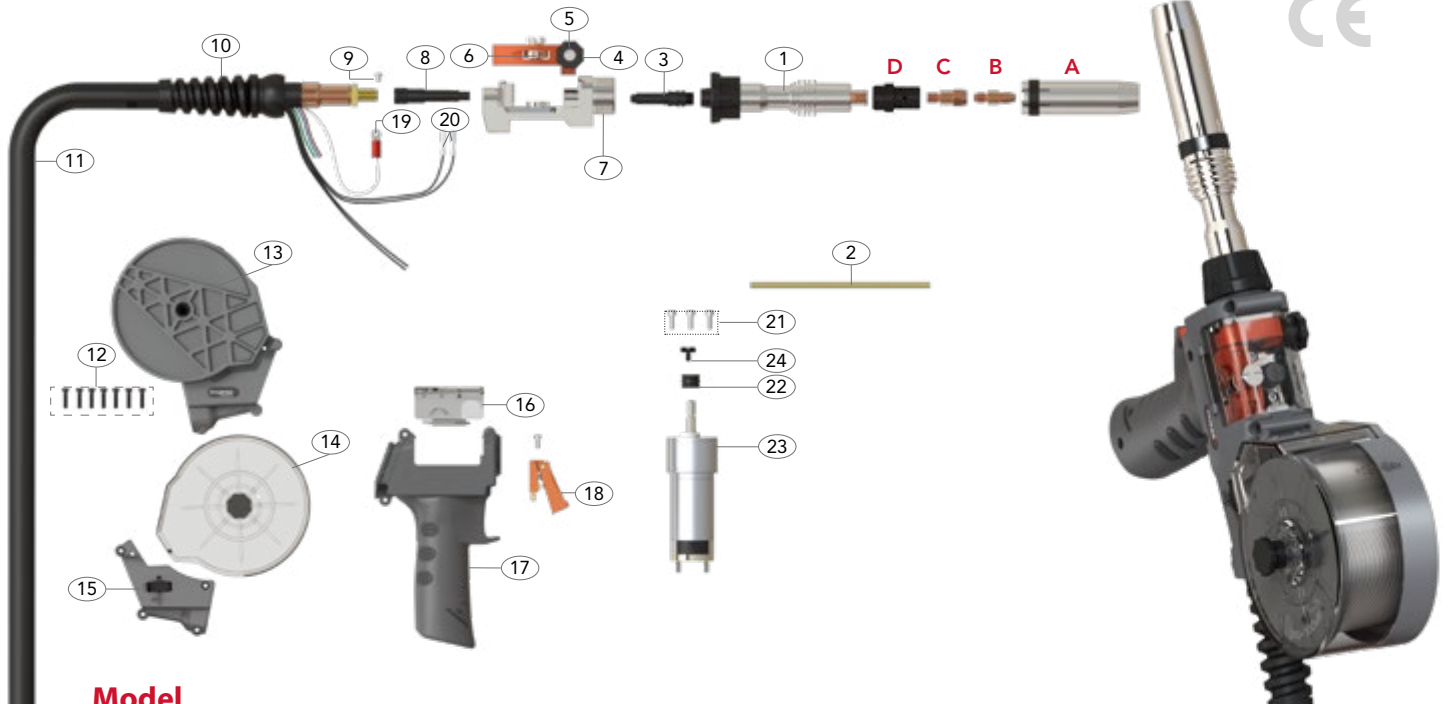

Model

Description	Part No.
	6mt
Spool-On 24V Mig Torch Euro End	DSP360A-24-P1-60ER
Spool-On 42V Mig Torch Euro End	DSP360A-42-P1-60ER
Spool-On 24V Mig Torch Surelok End	DSP360A-24-P1-60DN-GS1
Spool-On 42V Mig Torch Surelok End	DSP360A-42-P1-60DN-GS1

Alternative torch packages can be configured using the configurator on page 9

Wear Parts

A Nozzles

Part No.	Description	Wall	Material	Bore
PB3615	Cylindrical Nozzle	2.25mm	Cu	19.0
*PB3616	Conical Nozzle	2.25mm	Cu	16.1
PB3617	Tapered Nozzle	2.25mm	Cu	12.0

C Tip Adaptors

Part No.	Description	Material
PB3612	Tip Adaptor	Brass
PB3613	Tip Adaptor	Brass
*PB3614	Tip Adaptor	Brass

B Contact Tips

Part No.	Description	Material	Wire Size	mm	Inch
PB4014-08	Contact Tip	Cu	0.8	0.030	
PB4014-09	Contact Tip	Cu	0.9	0.035	
PB4014-10	Contact Tip	Cu	1.0	0.040	
*PB4014-10A	Contact Tip	Cu	1.0	0.040	
PB4014-12A	Contact Tip	Cu	1.2	0.045	
PB4015-08	Contact Tip	CuCrZr	0.8	0.030	
PB4015-09	Contact Tip	CuCrZr	0.9	0.035	
PB4015-10	Contact Tip	CuCrZr	1.0	0.040	
PB4015-10A	Contact Tip	CuCrZr	1.0	0.040	
PB4015-12A	Contact Tip	CuCrZr	1.2	0.045	

D Diffusers

Part No.	Description	Material	Colour
*PB3605B	Diffuser	DMC3	Black
PB3605C	Diffuser	Ceramic	White
PB3605W	Diffuser	DMC3	White

*Denotes torch package standard wear part set-up
For more information please refer to the following sections:
• Master Wear Parts Table Page 18-20
• Rear-End / Cable Parts Page 21

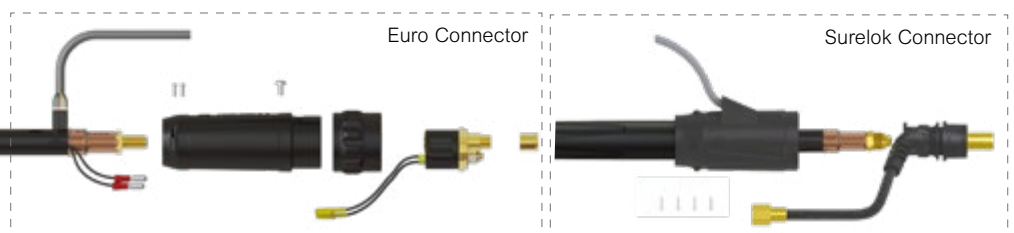

DSP 360A Duragrip Spool-On Mig/Mag Torch Range

Rating: 300A CO₂, 270A mixed gas, EN60974-7 @ 35% duty cycle. 0.8 to 1.2mm wires

Air-Cooled Mig Welding Torch



Spare Parts

Part No.	Description
1	SGP3603A Straight Neck Assembly
2	PGP3602A Jump Liner
3	PGP36006 Jump Liner Nipple
4	PGP36402B Tension Knob
5	PGP36402 Pressure Arm Assembly
6	PGP36402R Pressure Roll
7	PSP36001 Motor Body
8	PSP36006 Wire Guide
9	SCP2563 Screw
10	PMIG8015 Cable Support
11	DSP3617-60ER Coax Cable Assembly Euro Type
	DSP3617-60DN Coax Cable Assembly Dinse Type
12	PKA3X20 Handle Screw Pack
13	PSP2515SP-B Spool Holder
14	PSP2515SP-C Spool Cover
15	PSP2515SP-PT-1K Wire Speed Control 1K Ω
	PSP2515SP-PT-5K Wire Speed Control 5K Ω
	PSP2515SP-PT-10K Wire Speed Control 10K Ω
	PSP2515SP-PT-25K Wire Speed Control 25K Ω

Part No.	Description
16	PGP2514-C Push-Pull Handle Cover
17	PCSP2515-KJ Spool-On Handle
18	PGP2516 Push-Pull Trigger
19	SCP2597 Circular Cable Terminal
20	PB1521 Cable Terminal
21	PGPMS1 Motor Screw Pack
22	SGP7020W-08 Drive Roll For Steel Wire φ 0.8
	SGP7020W-09 Drive Roll For Steel Wire φ 0.9
	SGP7020W-10 Drive Roll For Steel Wire φ 1.0
	SGP7020W-08U Drive Roll For Al Wire φ 0.8
	SGP7020W-09U Drive Roll For Al Wire φ 0.9
	*SGP7020W-10U Drive Roll For Al Wire φ 1.0
	SGP7020W-12U Drive Roll For Al Wire φ 1.2
23	SGP7020-24 Motor 24V DC
	SGP7020-42 Motor 42V DC
24	PGP7020-24-4 Screw

DSP150A

Part No.	Description	Bore	Wall	Material
PC1530	Conical Nozzle	12.0	0.95mm	Brass
PB1529	Cylindrical Nozzle	16.0	0.9mm	Cu
*PB1530	Conical Nozzle	12.0	0.9mm	Cu
PB1531	Tapered Nozzle	10.5	0.9mm	Cu
PB1532	Bottle Nozzle	12.8	0.9mm	Cu
PB1533	Spot Welding Nozzle	16.0	0.9mm	Cu

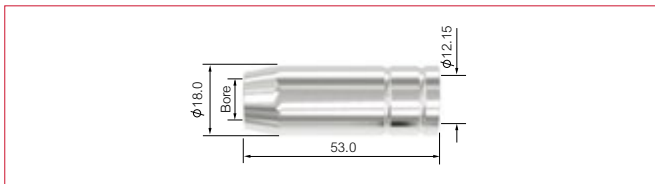

DSP 250A

Part No.	Description	Bore	Wall	Material
PC2507	Cylindrical Nozzle	19.0	1.25mm	Brass
PC2508	Conical Nozzle	15.0	1.25mm	Brass
PC2509	Tapered Nozzle	12.0	1.25mm	Brass
PB2507	Cylindrical Nozzle	18.0	1.5mm	Cu
*PB2508	Conical Nozzle	15.0	1.5mm	Cu
PB2509	Tapered Nozzle	12.0	1.5mm	Cu
PB2510	Bottle Nozzle	14.5	1.5mm	Cu
PB2511	Spot Welding Nozzle	18.0	1.5mm	Cu



DSP240A

Part No.	Description	Bore	Wall	Material
PB2415	Cylindrical Nozzle	17.2	1.4mm	Cu
*PB2416	Conical Nozzle	12.6	1.4mm	Cu
PB2417	Tapered Nozzle	10.0	1.4mm	Cu



DSP 360A

Part No.	Description	Bore	Wall	Material
PC3615	Cylindrical Nozzle	20.1	1.70mm	Cu
PC3616	Conical Nozzle	16.0	1.70mm	Cu
PC3617	Tapered Nozzle	12.0	1.70mm	Cu
PB3615	Cylindrical Nozzle	19.0	2.25mm	Cu
*PB3616	Conical Nozzle	16.1	2.25mm	Cu
PB3617	Tapered Nozzle	12.0	2.25mm	Cu



* Denotes torch package standard wear part set-up

Contact Tips

DSP 150A

Part No.	Description	Material	Wire Size	
			mm	inch
PB1527-06	Contact Tip	Cu	0.6	0.023
*PB1527-08	Contact Tip	Cu	0.8	0.030
PB1527-09	Contact Tip	Cu	0.9	0.035
PB1527-10	Contact Tip	Cu	1.0	0.040
PB1527-08A	Contact Tip	Cu	0.8	0.030
PB1527-09A	Contact Tip	Cu	0.9	0.035
PB1527-10A	Contact Tip	Cu	1.0	0.040

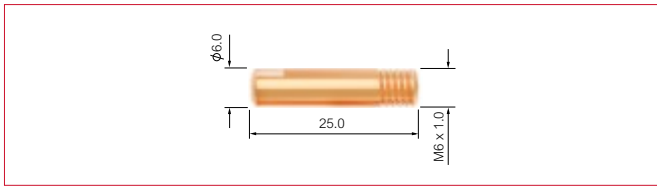

DSP 240A/250A

Part No.	Description	Material	Wire Size	
			mm	inch
PB2504-06	Contact Tip	Cu	0.6	0.023
PB2504-08	Contact Tip	Cu	0.8	0.030
PB2504-09	Contact Tip	Cu	0.9	0.035
PB2504-10	Contact Tip	Cu	1.0	0.040
PB2504-12	Contact Tip	Cu	1.2	0.045
PB2504-14	Contact Tip	Cu	1.4	0.055
PB2504-16	Contact Tip	Cu	1.6	0.063
*PB2504-10A	Contact Tip	Cu	1.0	0.040

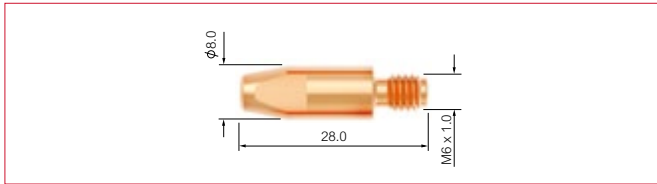

PB2505-08	Contact Tip	CuCrZr	0.8	0.030
PB2505-09	Contact Tip	CuCrZr	0.9	0.035
PB2505-10	Contact Tip	CuCrZr	1.0	0.040
PB2505-10A	Contact Tip	CuCrZr	1.0	0.040
PB2505-12A	Contact Tip	CuCrZr	1.2	0.045

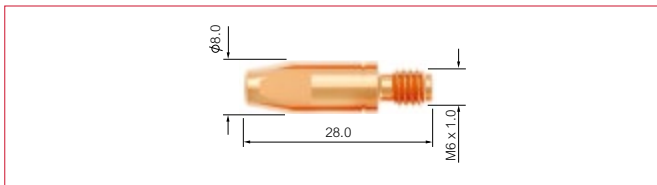

DSP 250A/360A

Part No.	Description	Material	Wire Size	
			mm	inch
PB4014-08	Contact Tip	Cu	0.8	0.030
PB4014-09	Contact Tip	Cu	0.9	0.035
PB4014-10	Contact Tip	Cu	1.0	0.040
*PB4014-10A	Contact Tip	Cu	1.0	0.040
PB4014-12A	Contact Tip	Cu	1.2	0.045

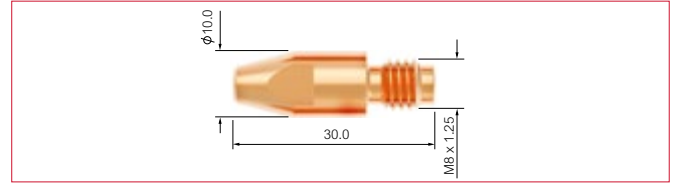

PB4015-08	Contact Tip	CuCrZr	0.8	0.030
PB4015-09	Contact Tip	CuCrZr	0.9	0.035
PB4015-10	Contact Tip	CuCrZr	1.0	0.040
PB4015-10A	Contact Tip	CuCrZr	1.0	0.040
PB4015-12A	Contact Tip	CuCrZr	1.2	0.045

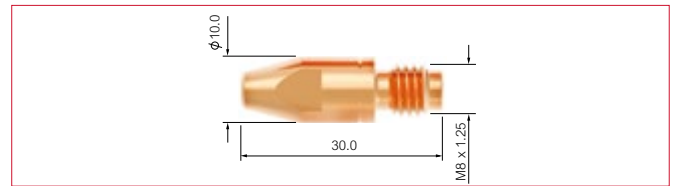

* Denotes torch package standard wear part set-up

Tip Adaptors

DSP 150A

Part No.	Description	Material
* PB1507L/H	Tip Adaptor Left Hand	Brass

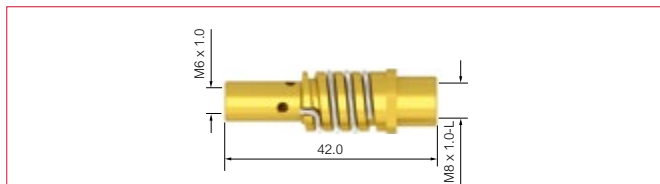

DSP 240A

Part No.	Description	Material
* PB2412	Tip Adaptor	Brass

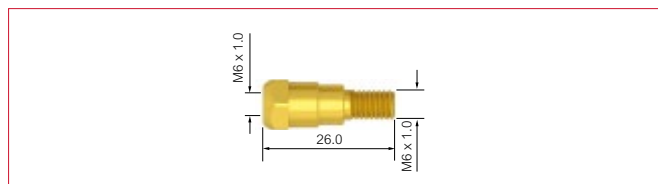

DSP 250A

Part No.	Description	Material
* PB2506	Tip Adaptor	Brass

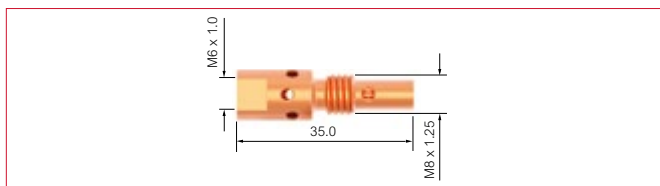

PB2536	Tip Adaptor M8	Brass
--------	----------------	-------

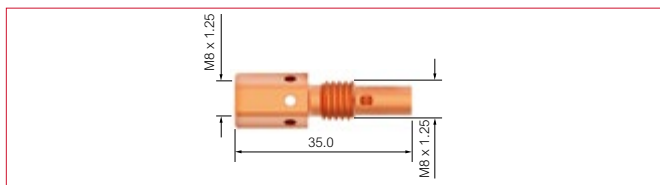

DSP 360A

Part No.	Description	Material
PB3612	Tip Adaptor	Brass
PB3613	Tip Adaptor	Brass
* PB3614	Tip Adaptor	Brass

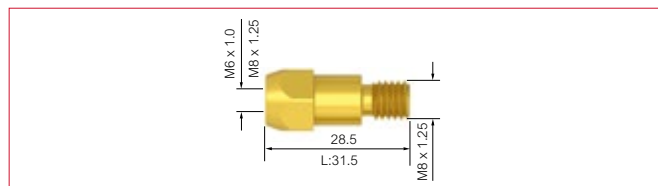

Diffusers

DSP 240A

Part No.	Description	Colour	Material
* PB2405B	Diffuser	Black	DMC3
PB2405C	Diffuser	White	Ceramic
PB2405W	Diffuser	White	DMC3
PB2405S	Diffuser	White	Silicon

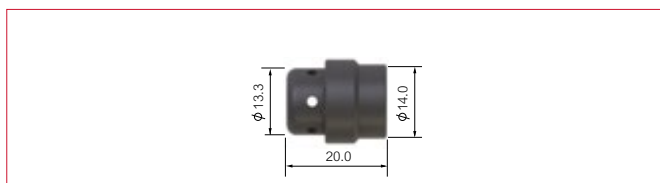

DSP 360A

Part No.	Description	Colour	Material
* PB3605B	Diffuser	Black	DMC3
PB3605C	Diffuser	White	Ceramic
PB3605W	Diffuser	White	DMC3

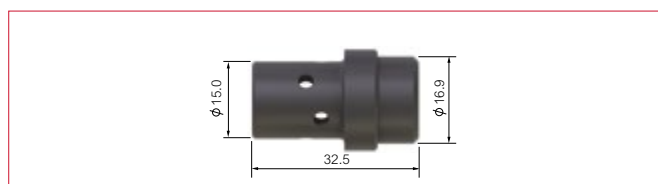

* Denotes torch package standard wear part set-up

Euro Connector

DSP 150A/240A/250A/360A

Part No.	Description
1 PPA2041	Cable Support
2 PB1505	Lock Nut
3 PB1522	Cable Terminal Male
4 SCSP1-1	Gun Plug Housing Screw Pack
5 PBL1541	Gun Plug Screw
6 SCP2578H/L	Gun Plug Housing Assembly
7 PB1523	Gun Plug Terminal Female
8 PC1519/S	Housing Nut
9 PC1528	Hybrid Gun Plug Body c/w Spring Pins
10 PB1525W	Washer
11 PB1525	Liner Nut

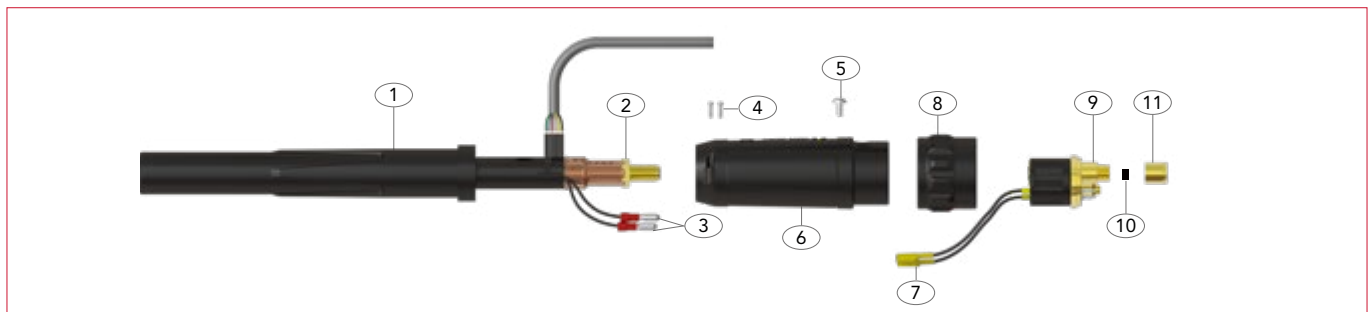

Surelok Connector

DSP 150A/240A/250A/360A

Part No.	Description
1 PPA3541	Cable Support
2 PSLH26-M	Cable Support Large
3 PSLH26-C	Surelok Housing Cover
4 PSLH26-H	Surelok Housing Large
5 PERSP1	Screw Pack
6 *PSL-1-#	Gas Supply Hose
7 PSL3550	Surelok Body and Support

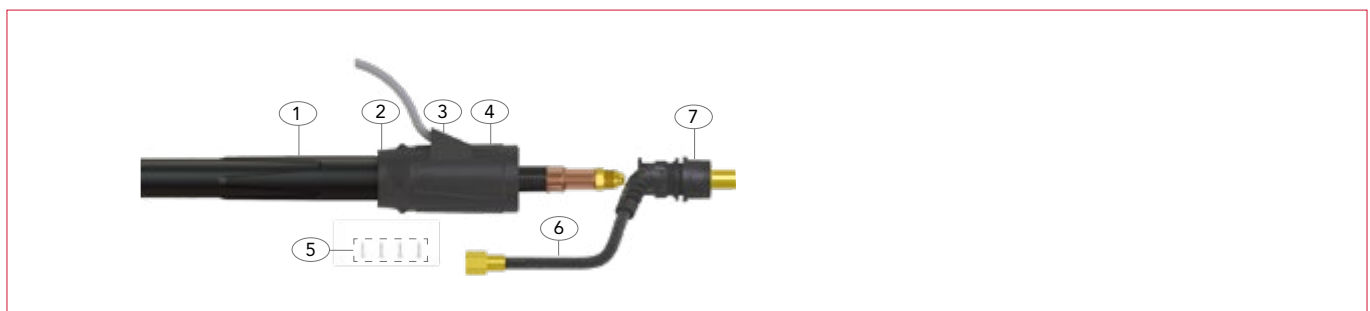

*Note: Gas supply hoses are specified by utilizing the part number and a termination suffix from the gas supply hose table on page 9.

Example: PSL-1-GS1
Gas supply hose c/w 3/8" BSP fitting



JINAN UNIARC WELDING TECHNOLOGY CO., LTD

13A Zhangjin Comprehensive Bonded Zone
33688, Jing Shi Dong Road
Jinan Area of China (Shandong) Pilot Free Trade Zone
Jinan 250102, P.R. China

Tel: +86 531 88239823

Website: www.parkertorchology.com.cn

Email: info@parkertorchology.com

MPP009 / V.2023.10