

STR S25K Suregrip TRF Plasma Cutting Torch Range

Rating: 25A Air/N₂ gas, @ 60% duty cycle.

Air-Cooled Cutting Torch Range

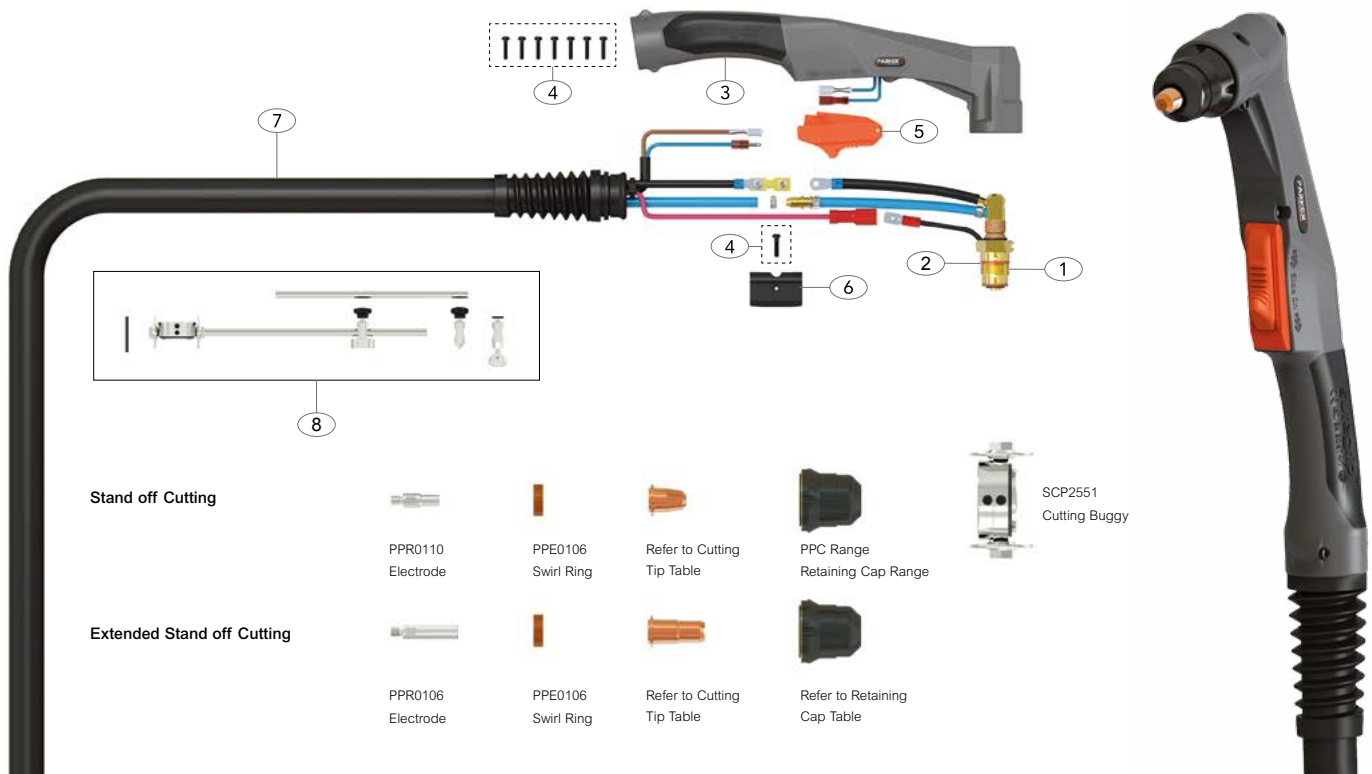

Stand off Cutting

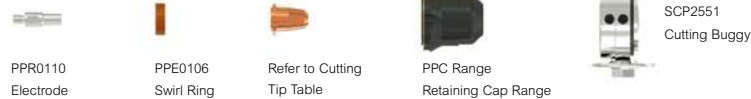

Extended Stand off Cutting



Model

Description	Part No.	
	4mt	6mt
Suregrip TRF Plasma Cutting Torch Package	STR S25K-40-CF1	STR S25K-60-CF1

Alternative torch packages can be configured using the configurator on page 12

Wear Parts

Cutting Tips

Part No.	Description	Bore ϕ A	Amps
*PPD0116-06	Cutting Tip	0.6mm	25A
PPD0103-65	Cutting Tip	0.65mm	25A

Retaining Caps

Part No.	Description
*PPC0117	Retaining Cap, 2 Holes

Spare Parts

Part No.	Description
1 STR2501	STR25 70° Torch Head Kit
2 SCP2508	O Ring
3 SGP2514	Plasma Handle Kit
4 SCPSP1	Screw Pack
5 SCP2516	Plasma Safety Trigger
6 SCP2515	Location Block
7 *SCP2519-40 -#	Cable Assembly Complete x 4mt
*SCP2519-60 -#	Cable Assembly Complete x 6mt
8 SCP2550	Circle Cutting Attachment Kit

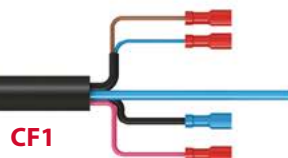

*Denotes torch package standard wear part set-up
For more information please refer to the following sections:
•Cable Terminations Page 10
•Master Wear Parts Table Page 30-37
•Wear Parts Configuration Tables Page 38-41