

DSPA360A Duragrip Spool-On Mig/Mag Torch Range

Rating: Long Neck + M8 Tip 300A CO₂, 270A mixed gas, EN60974-7 @ 35% duty cycle. 0.8 to 1.2mm wires
Short Neck + M8 Tip 270A CO₂, 250A mixed gas, EN60974-7 @ 35% duty cycle. 0.8 to 1.2mm wires

Air-Cooled Mig Welding Torch

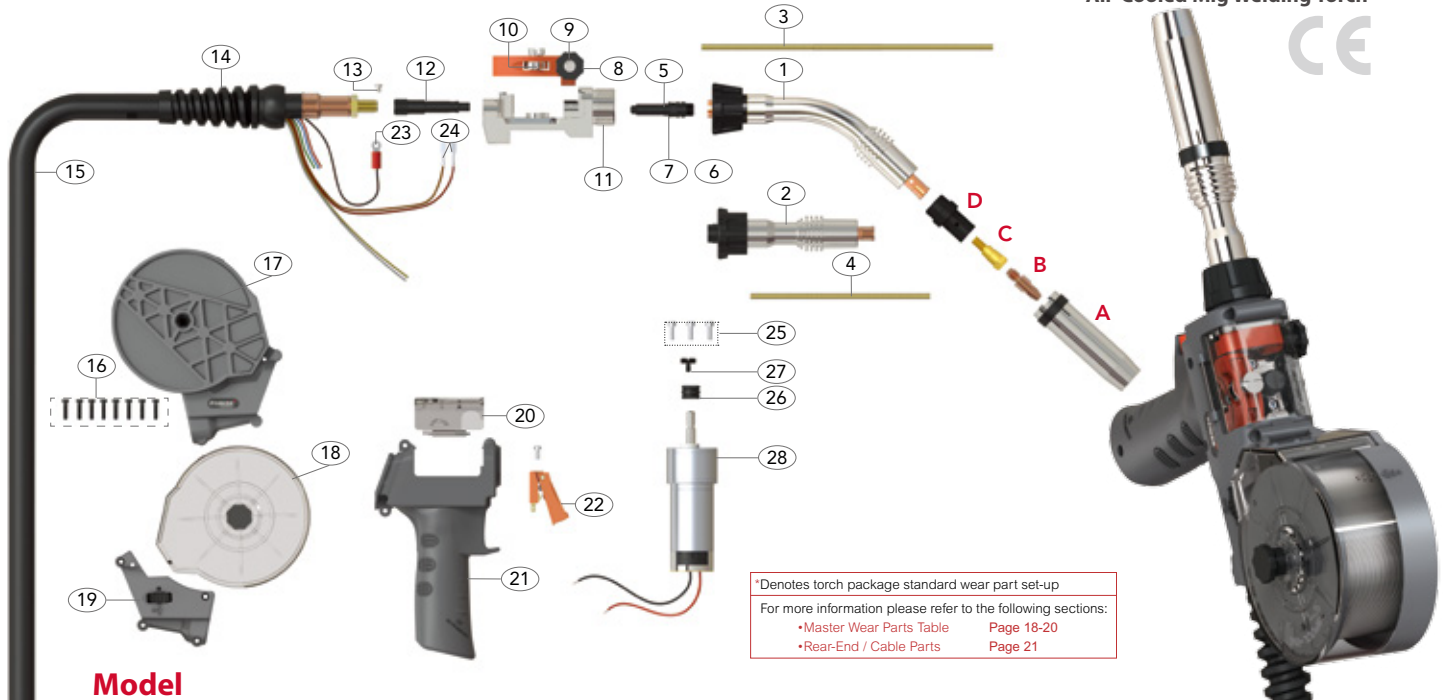

*Denotes torch package standard wear part set-up
For more information please refer to the following sections:
• Master Wear Parts Table Page 18-20
• Rear-End / Cable Parts Page 21

Model

Description	Part No.	
	6mt	8mt
Duragrip AV Spool-On Mig Torch Package 45° Neck, Euro End	DSPA360A-A45-P10-60ER	DSPA360A-A45-P10-80ER
Duragrip AV Spool-On Mig Torch Package Straight Neck, Euro End	DSPA360A-A180-P10-60ER	DSPA360A-A180-P10-80ER

Wear Parts

A Nozzles

Part No.	Description	Wall	Material	Bore
PB3615	Cylindrical Nozzle	2.25mm	Cu	19.0
*PB3616	Conical Nozzle	2.25mm	Cu	16.1
PB3617	Tapered Nozzle	2.25mm	Cu	12.0

B Contact Tips

Part No.	Description	Material	Wire Size	
			mm	Inch
PB4014-08	Contact Tip	Cu	0.8	0.030
PB4014-09	Contact Tip	Cu	0.9	0.035
PB4014-10	Contact Tip	Cu	1.0	0.040
*PB4014-10A	Contact Tip	Cu	1.0	0.040
PB4014-12A	Contact Tip	Cu	1.2	0.045
PB4015-08	Contact Tip	CuCrZr	0.8	0.030
PB4015-09	Contact Tip	CuCrZr	0.9	0.035
PB4015-10	Contact Tip	CuCrZr	1.0	0.040
PB4015-10A	Contact Tip	CuCrZr	1.0	0.040
PB4015-12A	Contact Tip	CuCrZr	1.2	0.045

C Tip Adaptors

Part No.	Description	Material
PB3612	Tip Adaptor	Brass
PB3613	Tip Adaptor	Brass
*PB3614	Tip Adaptor	Brass

D Diffusers

Part No.	Description	Material	Colour
*PB3605B	Diffuser	DMC3	Black
PB3605C	Diffuser	Ceramic	White
PB3605W	Diffuser	DMC3	White

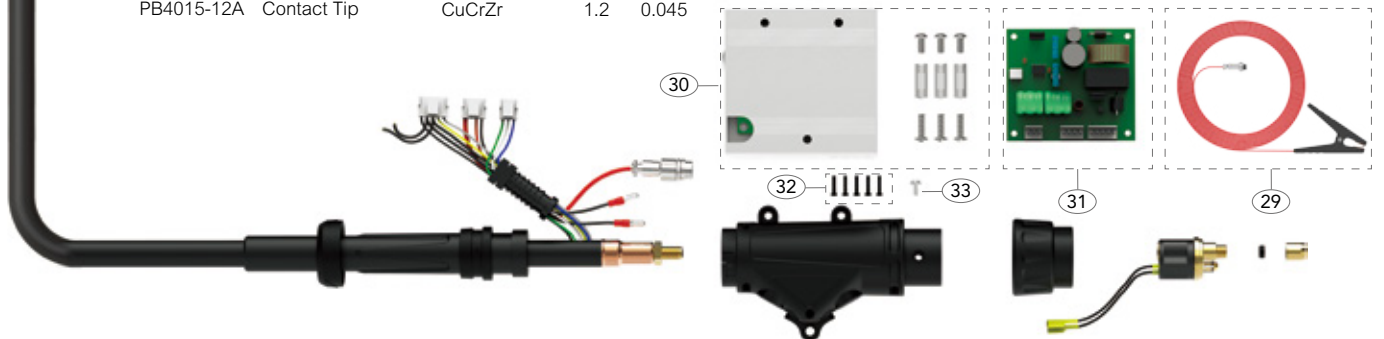

DSPAV 360A Duragrip Spool-On Mig/Mag Torch Range

Rating: Long Neck + M8 Tip 300A CO₂, 270A mixed gas, EN60974-7 @ 35% duty cycle. 0.8 to 1.2mm wires

Short Neck + M8 Tip 270A CO₂, 250A mixed gas, EN60974-7 @ 35% duty cycle. 0.8 to 1.2mm wires

Air-Cooled Mig Welding Torch



Spare Parts

Part No.	Description
1	SGP3603 Swan Neck Assembly 45°
2	SGP3603A Swan Neck Assembly Straight
3	PGP3602 Jump Liner
4	PGP3602A Jump Liner
5	PGP36006 Jump Liner Nipple
6	P9X1.5 'O' Ring
7	P7X1.5 'O' Ring
8	PGP36402B Tension Knob
9	PGP36402 Pressure Arm Assembly
10	PGP36402R Pressure Roll
11	PSP36001 Motor Body
12	PSP36006 Wire Guide Tube
13	SCP2563 Screw
14	PMIG8015 Cable Support
15	DSPCB3617-60ER Coax Cable Assembly Euro Type x 6mt
	DSPCB3617-80ER Coax Cable Assembly Euro Type x 8mt
16	PKA3X20 Handle Screw
17	PSP2515SP-B Wire Spool Holder
18	PSP2515SP-C Wire Spool Cover
19	PSP2515SP-PT-10K Wire Speed Control 10K Ω

Part No.	Description
20	PGP2514-C Push-Pull Handle Cover
21	PCSP2515-KJ Spool-On Handle
22	PGP2516 Straight Trigger Assembly
23	SCP2597 Circular Cable Terminal
24	PB1521 Cable Terminal
25	PGPMS1 Motor Screw
26	SGP7020W-08 Drive Roll For Hard Wire φ 0.8
	SGP7020W-09 Drive Roll For Hard Wire φ 0.9
	SGP7020W-10 Drive Roll For Hard Wire φ 1.0
	SGP7020W-08U Drive Roll For Aluminium Wire φ 0.8
	SGP7020W-09U Drive Roll For Aluminium Wire φ 0.9
	*SGP7020W-10U Drive Roll For Aluminium Wire φ 1.0
	SGP7020W-12U Drive Roll For Aluminium Wire φ 1.2
27	PGP7020-24-4 Drive Roller Retaining Screw
28	SGP7020-24 Motor 24V DC
29	PSP-EL Earth Lead Wire c/w Clamp x 4mt
30	PSPCB-BOX Control Box And Mounting Kit
31	PSPCB-BOX-PCB Control Box PCB Assembly
32	PWN5452-25X12 Housing Screw
33	PBL1541 Gun Plug Screw