

DSPA360A Duragrip Spool-On Mig/Mag Torch Range

Rating: Long Neck + M8 Tip 300A CO₂, 270A mixed gas, EN60974-7 @ 35% duty cycle. 0.8 to 1.2mm wires
 Short Neck + M8 Tip 270A CO₂, 250A mixed gas, EN60974-7 @ 35% duty cycle. 0.8 to 1.2mm wires

Air-Cooled Mig Welding Torch

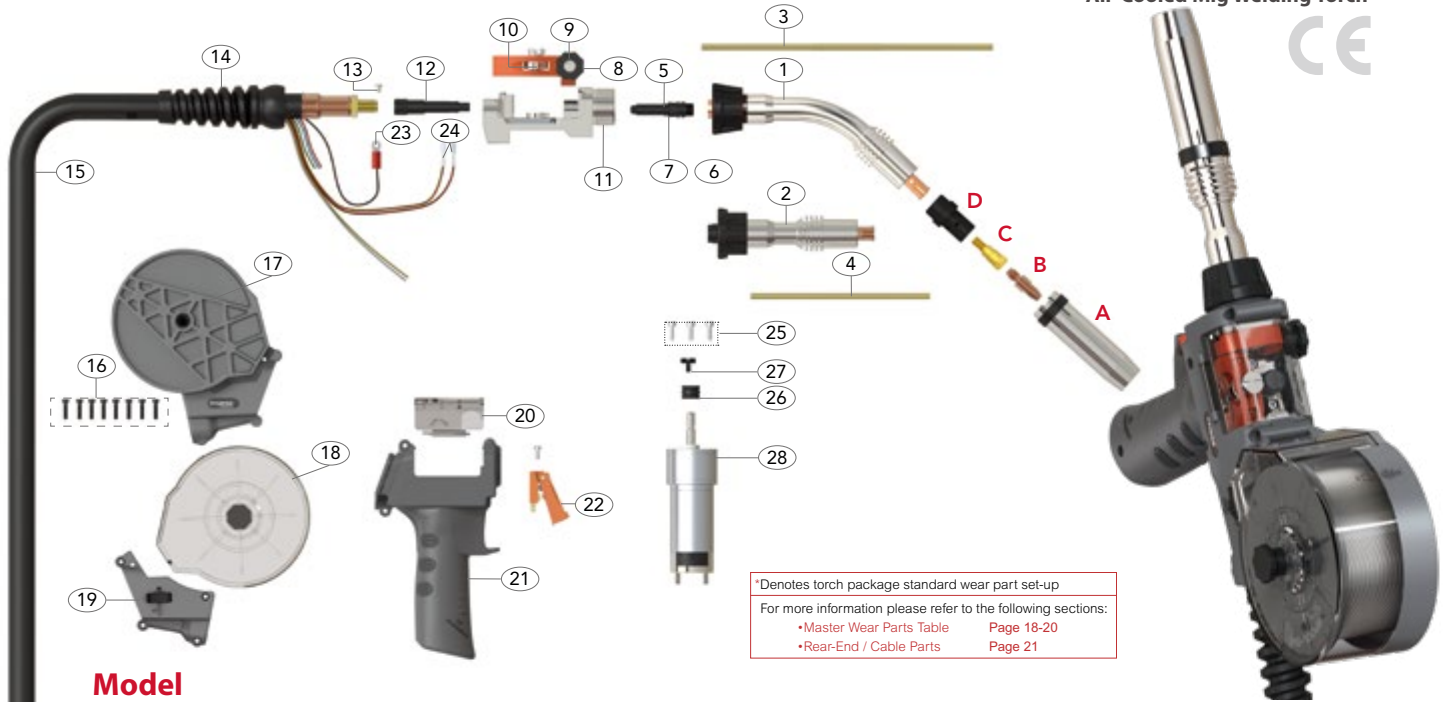

*Denotes torch package standard wear part set-up
 For more information please refer to the following sections:
 •Master Wear Parts Table Page 18-20
 •Rear-End / Cable Parts Page 21

Model

| Description | Part No. | |
|---|------------------------|------------------------|
| | 6mt | 8mt |
| Duragrip AV Spool-On Mig Torch Package 45° Neck,Euro End | DSPA360A-A45-P10-60ER | DSPA360A-A45-P10-80ER |
| Duragrip AV Spool-On Mig Torch Package Straight Neck,Euro End | DSPA360A-A180-P10-60ER | DSPA360A-A180-P10-80ER |

Wear Parts

A Nozzles

| Part No. | Description | Wall | Material | Bore |
|----------|--------------------|--------|----------|------|
| PB3615 | Cylindrical Nozzle | 2.25mm | Cu | 19.0 |
| *PB3616 | Conical Nozzle | 2.25mm | Cu | 16.1 |
| PB3617 | Tapered Nozzle | 2.25mm | Cu | 12.0 |

C Tip Adaptors

| Part No. | Description | Material |
|----------|-------------|----------|
| PB3612 | Tip Adaptor | Brass |
| PB3613 | Tip Adaptor | Brass |
| *PB3614 | Tip Adaptor | Brass |

B Contact Tips

| Part No. | Description | Material | Wire Size | |
|-------------|-------------|----------|-----------|-------|
| | | | mm | Inch |
| PB4014-08 | Contact Tip | Cu | 0.8 | 0.030 |
| PB4014-09 | Contact Tip | Cu | 0.9 | 0.035 |
| PB4014-10 | Contact Tip | Cu | 1.0 | 0.040 |
| *PB4014-10A | Contact Tip | Cu | 1.0 | 0.040 |
| PB4014-12A | Contact Tip | Cu | 1.2 | 0.045 |
| PB4015-08 | Contact Tip | CuCrZr | 0.8 | 0.030 |
| PB4015-09 | Contact Tip | CuCrZr | 0.9 | 0.035 |
| PB4015-10 | Contact Tip | CuCrZr | 1.0 | 0.040 |
| PB4015-10A | Contact Tip | CuCrZr | 1.0 | 0.040 |
| PB4015-12A | Contact Tip | CuCrZr | 1.2 | 0.045 |

D Diffusers

| Part No. | Description | Material | Colour |
|----------|-------------|----------|--------|
| *PB3605B | Diffuser | DMC3 | Black |
| PB3605C | Diffuser | Ceramic | White |
| PB3605W | Diffuser | DMC3 | White |

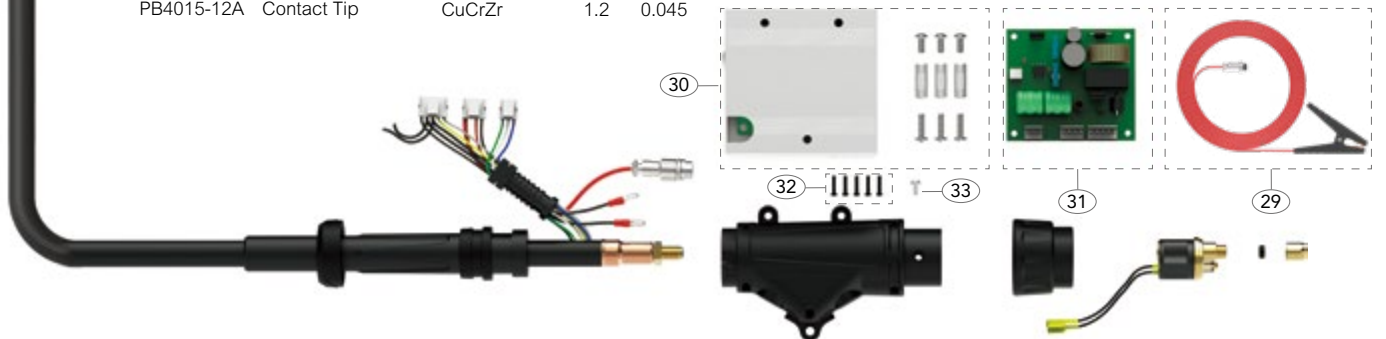

DSPAV 360A Duragrip Spool-On Mig/Mag Torch Range

Rating: Long Neck + M8 Tip 300A CO₂, 270A mixed gas, EN60974-7 @ 35% duty cycle. 0.8 to 1.2mm wires

Short Neck + M8 Tip 270A CO₂, 250A mixed gas, EN60974-7 @ 35% duty cycle. 0.8 to 1.2mm wires

Air-Cooled Mig Welding Torch



Spare Parts

| Part No. | Description |
|----------|--|
| 1 | SGP3603 Swan Neck Assembly 45° |
| 2 | SGP3603A Swan Neck Assembly Straight |
| 3 | PGP3602 Jump Liner |
| 4 | PGP3602A Jump Liner |
| 5 | PGP36006 Jump Liner Nipple |
| 6 | P9X1.5 'O' Ring |
| 7 | P7X1.5 'O' Ring |
| 8 | PGP36402B Tension Knob |
| 9 | PGP36402 Pressure Arm Assembly |
| 10 | PGP36402R Pressure Roll |
| 11 | PSP36001 Motor Body |
| 12 | PSP36006 Wire Guide Tube |
| 13 | SCP2563 Screw |
| 14 | PMIG8015 Cable Support |
| 15 | DSPCB3617-60ER Coax Cable Assembly Euro Type x 6mt |
| | DSPCB3617-80ER Coax Cable Assembly Euro Type x 8mt |
| 16 | PKA3X20 Handle Screw |
| 17 | PSP2515SP-B Wire Spool Holder |
| 18 | PSP2515SP-C Wire Spool Cover |
| 19 | PSP2515SP-PT-10K Wire Speed Control 10K Ω |

| Part No. | Description |
|----------|---|
| 20 | PGP2514-C Push-Pull Handle Cover |
| 21 | PCSP2515-KJ Spool-On Handle |
| 22 | PGP2516 Straight Trigger Assembly |
| 23 | SCP2597 Circular Cable Terminal |
| 24 | PB1521 Cable Terminal |
| 25 | PGPMS1 Motor Screw |
| 26 | SGP7020W-08 Drive Roll For Hard Wire φ 0.8 |
| | SGP7020W-09 Drive Roll For Hard Wire φ 0.9 |
| | SGP7020W-10 Drive Roll For Hard Wire φ 1.0 |
| | SGP7020W-08U Drive Roll For Aluminium Wire φ 0.8 |
| | SGP7020W-09U Drive Roll For Aluminium Wire φ 0.9 |
| | *SGP7020W-10U Drive Roll For Aluminium Wire φ 1.0 |
| | SGP7020W-12U Drive Roll For Aluminium Wire φ 1.2 |
| 27 | PGP7020-24-4 Drive Roller Retaining Screw |
| 28 | SGP7020-24 Motor 24V DC |
| 29 | PSP-EL Earth Lead Wire c/w Clamp x 4mt |
| 30 | PSPCB-BOX Control Box And Mounting Kit |
| 31 | PSPCB-BOX-PCB Control Box PCB Assembly |
| 32 | PWN5452-25X12 Housing Screw |
| 33 | PBL1541 Gun Plug Screw |