

*Denotes torch package standard wear part set-up
For more information please refer to the following sections:
•Master Wear Parts Table Page 18-20
•Rear-End / Cable Parts Page 21

Model

Description	Part No.	
Duragrip AV Spool-On Mig Torch Package Straight Neck, Euro End	6mt	8mt
	DSPAV150A-A180-P10-60ER	DSPAV150A-A180-P10-80ER

Wear Parts

A Nozzles

Part No.	Description	Wall	Material	Bore
PB1529	Cylindrical Nozzle	0.9mm	Cu	16.0
*PB1530	Conical Nozzle	0.9mm	Cu	12.0
PB1531	Tapered Nozzle	0.9mm	Cu	10.5
PB1532	Bottle Nozzle	0.9mm	Cu	12.8
PB1533	Spot Welding Nozzle	0.9mm	Cu	16.0

C Tip Adaptors

Part No.	Description	Material
*PB1507L/H	Tip Adaptor Left Hand	Brass

B Contact Tips

Part No.	Description	Material	Wire Size	
			mm	Inch
*PB1527-08	Contact Tip	Cu	0.8	0.030
PB1527-09	Contact Tip	Cu	0.9	0.035
PB1527-10	Contact Tip	Cu	1.0	0.040

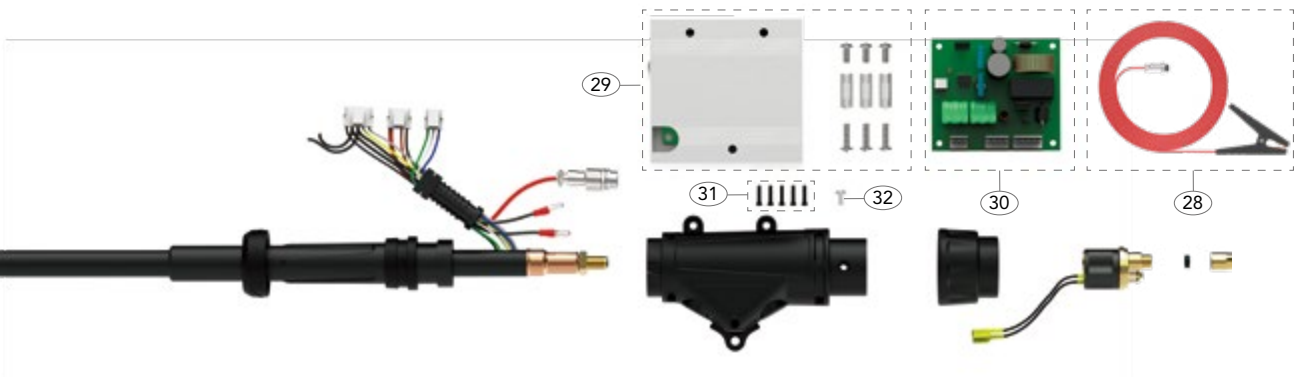

DSPAV 150A Duragrip Spool-On Mig/Mag Torch Range

Rating: 180A CO₂, 150A mixed gas, EN60974-7 @ 35% duty cycle. 0.8 to 1.0mm wires

Air-Cooled Mig Welding Torch



Spare Parts

Part No.	Description
1	PB1504 Shroud Spring
2	PSP1501 Straight Neck Assembly
3	PSP1502 Jump Liner
4	PGP36006 Jump Liner Nipple
5	P9X1.5 'O' Ring
6	P7X1.5 'O' Ring
7	PGP36402B Tension Knob
8	PGP36402 Pressure Arm Assembly
9	PGP36402R Pressure Roll
10	PSP36001 Motor Body
11	PSP36006 Wire Guide Tube
12	SCP2563 Screw
13	PMIG8015 Cable Support
14	DSPCB1517-60ER Coax Cable Assemblby Euro Type x 6mt
	DSPCB1517-80ER Coax Cable Assemblby Euro Type x 8mt
15	PKA3X20 Handle Screw
16	PCSP2515SP-B Wire Spool Holder
17	PSP2515SP-C Wire Spool Cover
18	PSP2515SP-PT-10K Wire Speed Control 10K Ω
19	PGP2514-C Push-Pull Handle Cover
20	PCSP2515-KJ Spool-On Handle

Part No.	Description
21	PGP2516 Standard Trigger Assembly
22	SCP2597 Circular Cable Terminal
23	PB1521 Cable Terminal
24	PGPMS1 Motor Screw
25*	SGP7020W-08 Drive Roll For Hard Wire φ 0.8
	SGP7020W-09 Drive Roll For Hard Wire φ 0.9
	SGP7020W-10 Drive Roll For Hard Wire φ 1.0
	SGP7020W-08U Drive Roll For Aluminium Wire φ 0.8
	SGP7020W-09U Drive Roll For Aluminium Wire φ 0.9
	SGP7020W-10U Drive Roll For Aluminium Wire φ 1.0
26	PGP7020-24-4 Drive Roller Retaining Screw
27	SGP7020-24 Motor 24V DC
28	PSP-EL Earth Lead Wire c/w Clamp x 4mt
29	PSPCB-BOX Control Box And Mounting Kit
30	PSPCB-BOX-PCB Control Box PCB Assembly
31	PWN5452-25X12 Housing Screw
32	PBL1541 Gun Plug Screw