



SUREGRIP ST HYBRID
MIG/MAG SERIES



Welding Tools for the Professional

A Smart Approach

Parker Torchology is shaped by people with vision, a passion for improvement and a belief in delivering the very best Welding and Cutting Torch Range in the World.

We expect a great deal from our products, so we ask a lot of ourselves and our engineers.

Our mantra: **Innovation, Technology, Performance.**



DNA

Design and Engineering excellence are at the core of everything we do.

Every torch we build is driven by our relentless pursuit of perfection.

Premium Features

At Parker Torchology we do things differently, we strive to solve your problems with the perfect product to suit your needs. We create smart product features encased in cutting-edge design to ensure you always have the best tools to hand.





Production

A fusion of precision production engineering, our bespoke processing techniques and a fanatical attention to detail ensures every welding torch we produce is worthy of the Parker Torchology name.

Testing, Testing, Testing

It takes patience to develop a new product, it's a lot more than a great idea.

Product development is an iterative process, trying something over and over, changing one small variable at a time.

We build endless prototypes and test pieces that undergo months of rigorous testing. Only once a product has passed up to 88 different test procedures, with every single part tested separately do we consider our latest designs ready for market.

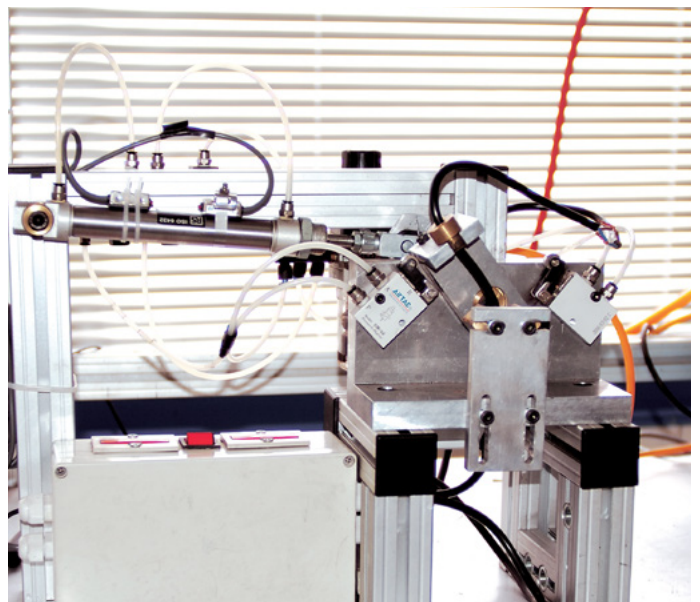

Partners

Our customers and business partners play a vital role in our development. With the core aim to strive together, we work with end-users, distributors and academic institutions alike.

As a result we share fundamental values in order to succeed in our respective market places, supporting economic growth and collaborative opportunities with others.

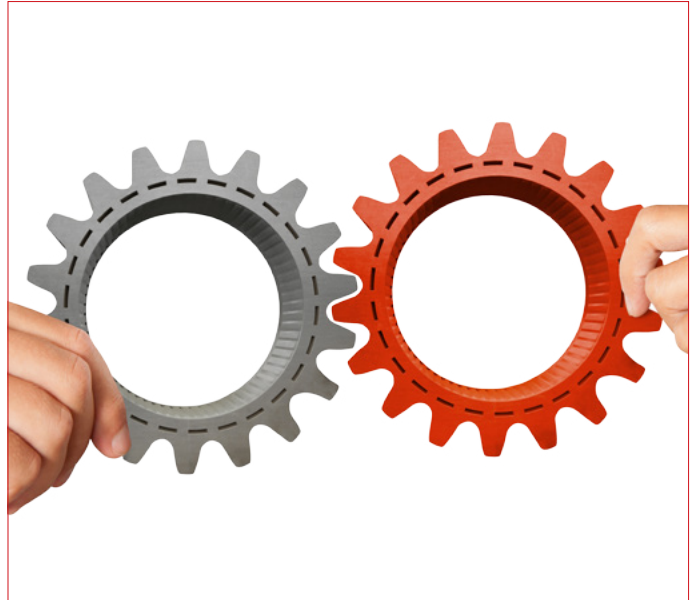

A Bright Future

Technology doesn't stand still, which is why we are constantly innovating to bring you the best products on the market.

Our strong vision and focused innovation strategy, not to mention our passion to revolutionize the industry, ensure that Parker Torchology is a byword for excellence.

We Talk Torches

Contents

Suregrip ST Hybrid Mig/Mag Torch Range Features Focus 6

Suregrip ST Hybrid Mig/Mag Torch Range Overview and Ratings 8

Torch Range

Air-Cooled

Suregrip ST Hybrid STH 150AE 9

Suregrip ST Hybrid STH 240AE 10

Wear Parts

Nozzles 11

Contact Tips 11

Tip Adaptors 12

Diffusers 12

Liners 13

Rear-End Spare Parts 14

Suregrip ST Hybrid Mig/Mag Torch Range

Air-Cooled Features Focus

Air-Cooled

A Tig style torch for continuous wire welding. Ideal for positional, overhead welding and pulse Mig applications in Aluminium.

Preset Programme Control



100% Binzel® Wear Parts Compatibility Guaranteed

Quality Wear Parts

All wear parts are manufactured to the same specification as the original manufacturer ensuring reliability, longevity and superior performance

- Contact tips are manufactured using high quality copper alloys

Ergonomics – For Comfort and Handleability

Every detail has been considered to ensure the welder has the very best handling in all positions

- Patented handle sets with large surface area soft grips for improved balance and positionability
- Knuckle joints enables small movements of the torch independently of the cable assembly



Positionability

- The fully rotating neck allows for multi-positional welding
- Difficult to access areas can be reached whatever the position

Features Focus

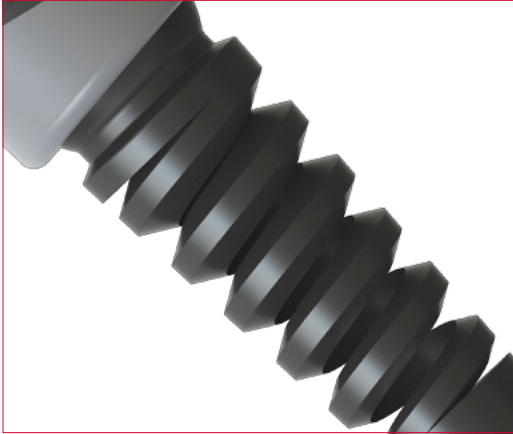

High Performance Power Cables

- Cable sets offer the ultimate in heat and brazing resistance. Fused by an electron beam process maximizes flexibility and durability
- Knuckle Joint enables small movements of the handle and neck independently of the cable assembly
- Cable supports are designed to offer the greatest flexibility
- High performance power cables

Ease Of Maintenance

Functionality and ease of repair

- Screwless design solutions and euro housing sets ensure minimum downtime and productivity – No tools required!
- Euro bodies utilize the industry standard (thanks to us!) spring pins
- Optional rear-end terminations ensure worldwide compatibility

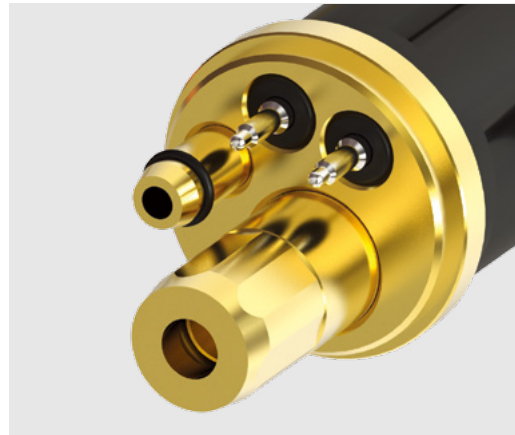

The Smart way to buy welding and cutting tools.

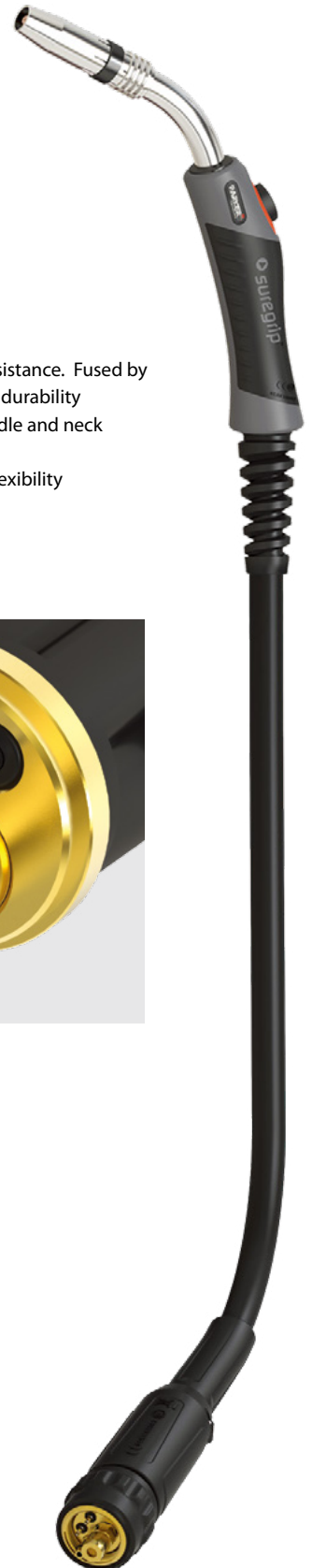

Suregrip ST Hybrid Mig/Mag Torch Range

Ratings: 150 Amp to 220 Amp, Mixed Gas



Model	STH 150AE	STH 240AE
Technical Data		
Cooling Method	Air-Cooled	Air-Cooled
Rating: CO ₂	180A	250A
Rating: Mixed Gas	150A	220A
Duty Cycle	35%	35%
Wire Size	0.6-1.0mm	0.8-1.2mm
Order Codes		
3mt	STH150E-30ER	STH240E-30ER
4mt	STH150E-40ER	STH240E-40ER
5mt	STH150E-50ER	STH240E-50ER

STH 150AE Suregrip ST Hybrid Mig/Mag Torch Range

Rating: 180A CO₂, 150A mixed gas, EN60974-7 @ 35% duty cycle. 0.6 to 1.0mm wires

Air-Cooled Mig Welding Torch

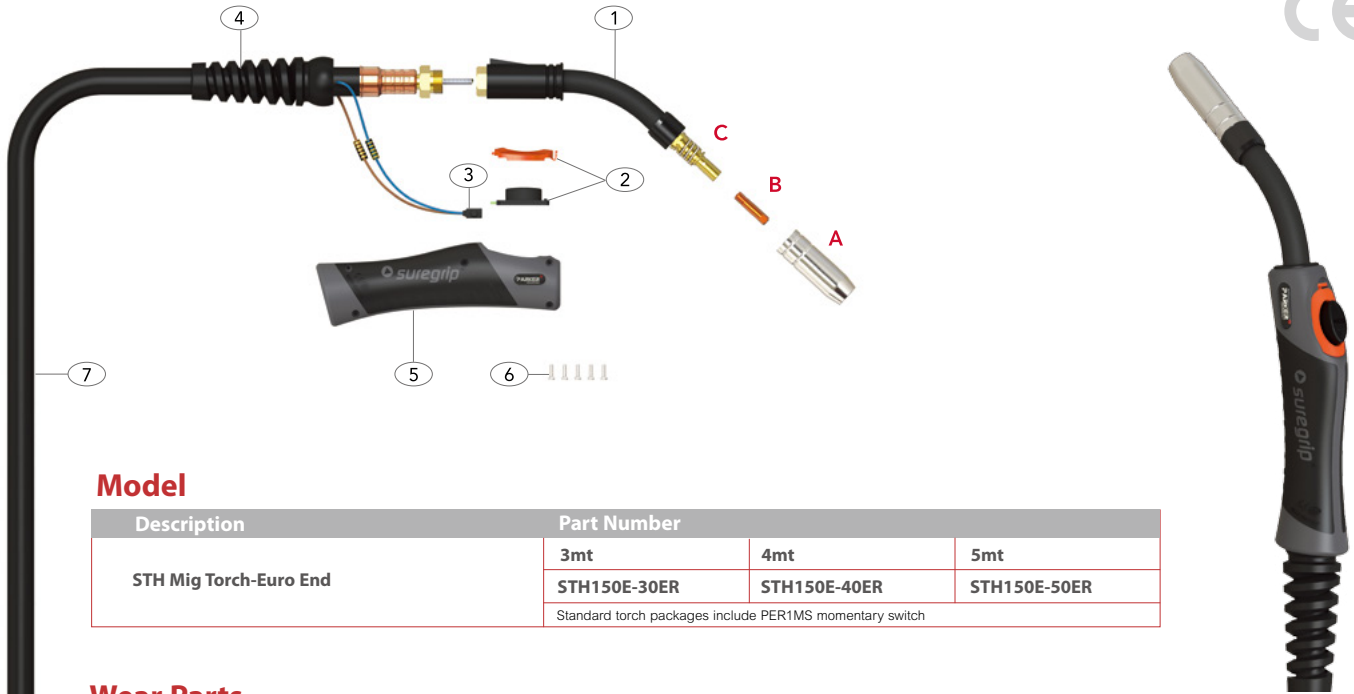

Model

Description	Part Number		
	3mt	4mt	5mt
STH Mig Torch-Euro End	STH150E-30ER	STH150E-40ER	STH150E-50ER
Standard torch packages include PER1MS momentary switch			

Wear Parts

A Nozzles

Part No.	Description	Bore	Wall	Material
PB1529	Cylindrical Nozzle	16.2	0.9mm	Cu
*PB1530	Conical Nozzle	12.0	0.9mm	Cu
PB1531	Tapered Nozzle	10.5	0.9mm	Cu
PB1532	Bottle Nozzle	12.8	0.9mm	Cu
PB1533	Spot Welding Nozzle	16.2	0.9mm	Cu

B Contact Tips

Part No.	Description	Material	Wire Size	
			mm	Inch
PB1527-06	Contact Tip	Cu	0.6	0.023"
*PB1527-08	Contact Tip	Cu	0.8	0.030"
PB1527-09	Contact Tip	Cu	0.9	0.035"
PB1527-10	Contact Tip	Cu	1.0	0.040"

C Tip Adaptors

Part No.	Description	Material
*PB1507L/H	Tip Adaptor Left Hand	Brass

D Liner

Part No.	Description	Length	Wire Size
*PB1535-30	Steel Liner x 3mt	3.4mt	0.6-0.9 mm
*PB1535-40	Steel Liner x 4mt	4.4mt	0.6-0.9
*PB1535-50	Steel Liner x 5mt	5.4mt	0.6-0.9

Spare Parts

Part Number	Description
1	PMIG1501 Swan Neck Assembly
2	PER1MS Momentary Switch Kit PER1MT Maintained Switch Kit
3	PERSW-P Switch Wire Socket Kit
4	PMIG8015 Handle Cable Support c/w Ball Joint
5	PERH200M Suregrip Handle
6	PERSP1 Screw Pack
7	PML1537-30E Power Cable Assembly x 3mt PML1537-40E Power Cable Assembly x 4mt PML1537-50E Power Cable Assembly x 5mt

*Denotes torch package standard wear part set-up

For more information please refer to the following sections:

- Master Wear Parts Table Page 11-13
- Rear-End / Cable Parts Page 14

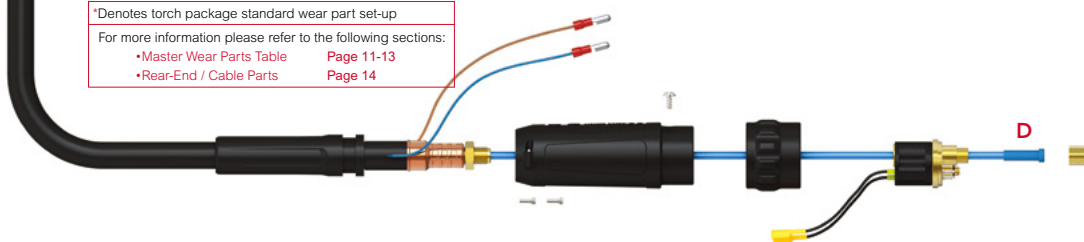

STH 240AE Suregrip ST Hybrid Mig/Mag Torch Range

Rating: 250A CO₂, 220A mixed gas, EN60974-7 @ 35% duty cycle. 0.8 to 1.2mm wires

Air-Cooled Mig Welding Torch

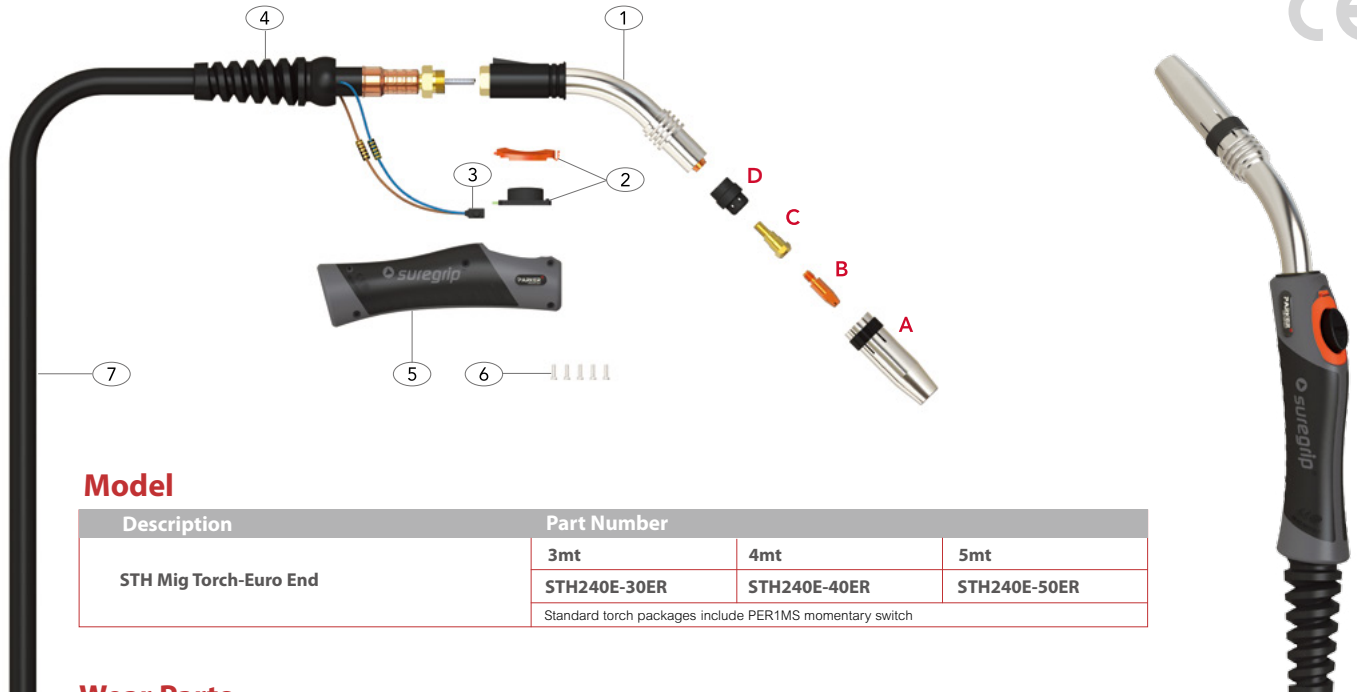

Model

Description	Part Number		
	3mt	4mt	5mt
STH Mig Torch-Euro End	STH240E-30ER	STH240E-40ER	STH240E-50ER
Standard torch packages include PER1MS momentary switch			

Wear Parts

A Nozzles

Part No.	Description	Bore	Wall	Material
PB2415	Cylindrical Nozzle	17.2	1.40mm	Cu
*PB2416	Conical Nozzle	12.6	1.40mm	Cu
PB2417	Tapered Nozzle	10.0	1.40mm	Cu

B Contact Tips

Part No.	Description	Material	Wire Size	
			mm	Inch
PB2504-08	Contact Tip	Cu	0.8	0.030"
PB2504-09	Contact Tip	Cu	0.9	0.035"
*PB2504-10	Contact Tip	Cu	1.0	0.040"
PB2504-12	Contact Tip	Cu	1.2	0.045"
PB2504-10A	Contact Tip	Cu	1.0	0.040"
PB2504-12A	Contact Tip	Cu	1.2	0.045"
PB2505-08	Contact Tip	CuCrZr	0.8	0.030"
PB2505-09	Contact Tip	CuCrZr	0.9	0.035"
PB2505-10	Contact Tip	CuCrZr	1.0	0.040"
PB2505-12	Contact Tip	CuCrZr	1.2	0.045"
PB2505-10A	Contact Tip	CuCrZr	1.0	0.040"
PB2505-12A	Contact Tip	CuCrZr	1.2	0.045"

C Tip Adaptors

Part No.	Description	Material
*PB2412	Tip Adaptor	Brass

D Diffusers

Part No.	Description	Colour	Material
*PB2405B	Diffuser	Black	DMC3
PB2405C	Diffuser	White	Ceramic
PB2405W	Diffuser	White	DMC3
PB2405S	Diffuser	Red	Silicon

E Liner

Part No.	Description	Length	Wire Size
			mm
*PB2524-30	Steel Liner x 3mt	3.4mt	1.0-1.2
*PB2524-40	Steel Liner x 4mt	4.4mt	1.0-1.2
*PB2524-50	Steel Liner x 5mt	5.4mt	1.0-1.2

Spare Parts

Part Number	Description
1	PMIG2401 Swan Neck Assembly
2	PER1MS Momentary Switch Kit
	PER1MT Maintained Switch Kit
3	PERSW-P Switch Wire Socket Kit
4	PMIG8015 Handle Cable Support c/w Ball Joint
5	PERH200M Suregrip Handle
6	PERSP1 Screw Pack
7	PML2603-30E Power Cable Assembly x 3mt
	PML2603-40E Power Cable Assembly x 4mt
	PML2603-50E Power Cable Assembly x 5mt

*Denotes torch package standard wear part set-up
For more information please refer to the following sections:
•Master Wear Parts Table Page 11-13
•Rear-End / Cable Parts Page 14

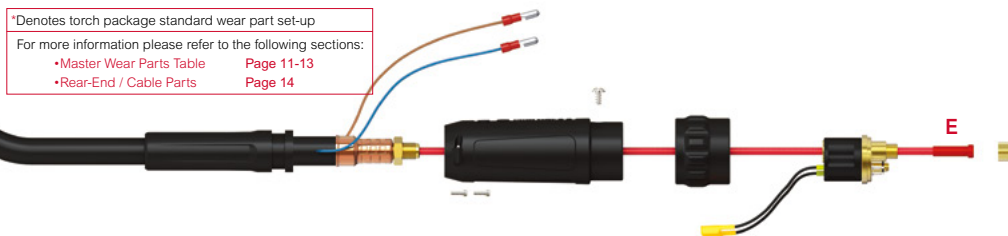

Nozzles

STH150A

Part No.	Description	Bore	Wall	Material
PB1529	Cylindrical Nozzle	16.2	0.9mm	Cu
* PB1530	Conical Nozzle	12.0	0.9mm	Cu
PB1531	Tapered Nozzle	10.5	0.9mm	Cu
PB1532	Bottle Nozzle	12.8	0.9mm	Cu
PB1533	Spot Welding Nozzle	16.2	0.9mm	Cu

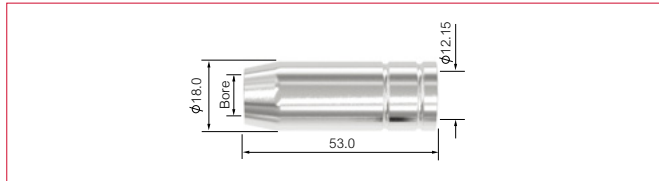

STH240A

Part No.	Description	Bore	Wall	Material
PB2415	Cylindrical Nozzle	17.2	1.40mm	Cu
* PB2416	Conical Nozzle	12.6	1.40mm	Cu
PB2417	Tapered Nozzle	10.0	1.40mm	Cu

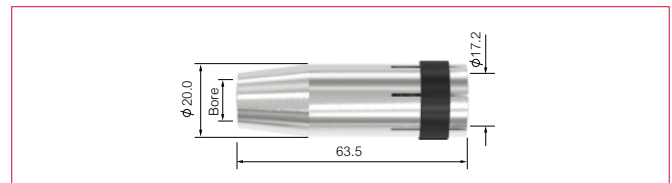

Contact Tips

STH150A

Part No.	Description	Material	Wire Size	
			mm	inch
PB1527-06	Contact Tip	Cu	0.6	0.023"
* PB1527-08	Contact Tip	Cu	0.8	0.030"
PB1527-09	Contact Tip	Cu	0.9	0.035"
PB1527-10	Contact Tip	Cu	1.0	0.040"
PB1527-12	Contact Tip	Cu	1.2	0.045"

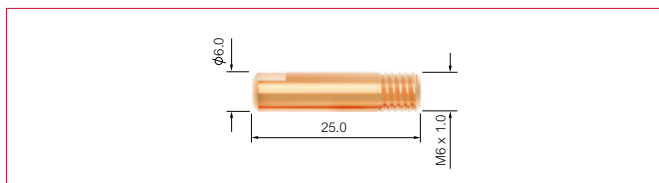

STH240A

Part No.	Description	Material	Wire Size	
			mm	inch
PB2504-06	Contact Tip	Cu	0.6	0.023"
PB2504-08	Contact Tip	Cu	0.8	0.030"
PB2504-09	Contact Tip	Cu	0.9	0.035"
* PB2504-10	Contact Tip	Cu	1.0	0.040"
PB2504-12	Contact Tip	Cu	1.2	0.045"
PB2504-10A	Contact Tip	Cu	1.0	0.040"
PB2504-12A	Contact Tip	Cu	1.2	0.045"

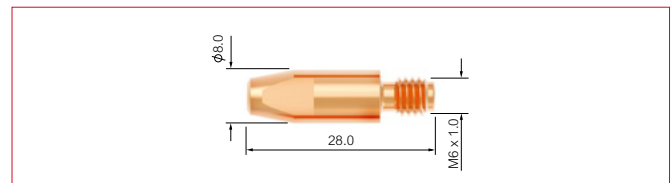

PB2505-08	Contact Tip	CuCrZr	0.8	0.030"
PB2505-09	Contact Tip	CuCrZr	0.9	0.035"
PB2505-10	Contact Tip	CuCrZr	1.0	0.040"
PB2505-12	Contact Tip	CuCrZr	1.2	0.045"
PB2505-10A	Contact Tip	CuCrZr	1.0	0.040"
PB2505-12A	Contact Tip	CuCrZr	1.2	0.045"

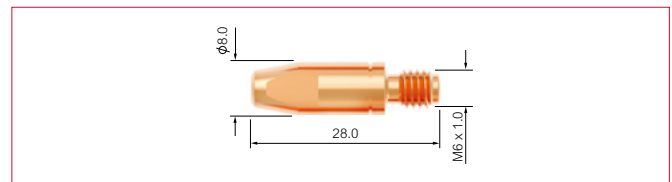

STH150A

Part No.	Description	Material
* PB1507L/H	Tip Adaptor Left Hand	Brass

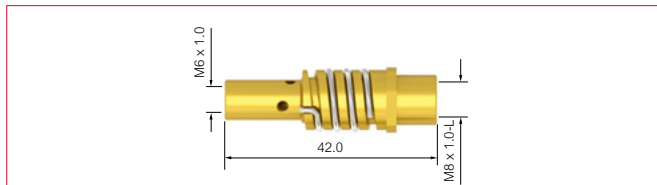

STH240A

Part No.	Description	Material
* PB2412	Tip Adaptor	Brass

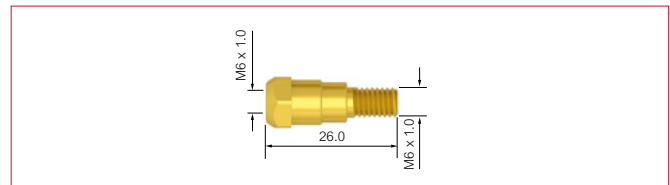

Diffusers

STH240A

Part No.	Description	Colour	Material
* PB2405B	Diffuser	Black	DMC3
PB2405C	Diffuser	White	Ceramic
PB2405W	Diffuser	White	DMC3
PB2405S	Diffuser	Red	Silicon

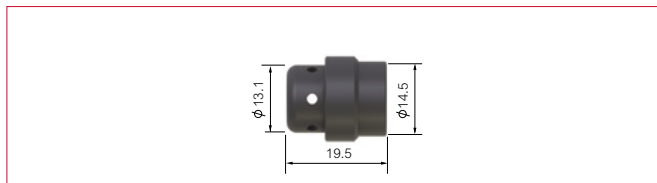

Liner Options 0.6-0.9mm

STH150A

Part No.	Description	Length	Nipple	Wire Size mm
* PB1535-30	Steel Liner x 3mt	3.4mt	Moulded Nipple	0.6-0.9
* PB1535-40	Steel Liner x 4mt	4.4mt	Moulded Nipple	0.6-0.9
* PB1535-50	Steel Liner x 5mt	5.4mt	Moulded Nipple	0.6-0.9

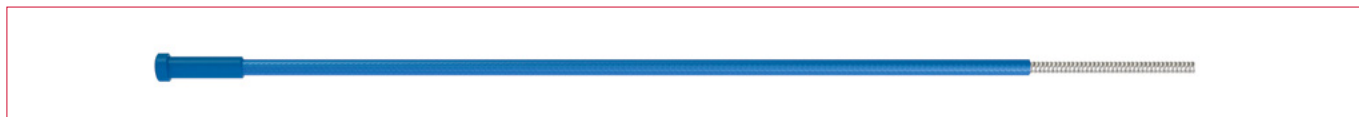

Liner Options 1.0-1.2mm

STH240A

Part No.	Description	Length	Nipple	Wire Size mm
* PB2524-30	Steel Liner x 3mt	3.4mt	Moulded Nipple	1.0-1.2
* PB2524-40	Steel Liner x 4mt	4.4mt	Moulded Nipple	1.0-1.2
* PB2524-50	Steel Liner x 5mt	5.4mt	Moulded Nipple	1.0-1.2



STH 150AE

Part No.	Description	
1	PC2841	Cable Support
2	PB1505	Lock Nut
3	PB1522	Cable Terminal Male
4	SCSP1-1	Gun Plug Housing Screw
5	SC2578/S	Gun Plug Housing c/w Nut
6	PBL1541	Gun Plug Screw
7	PC1519/P	Gun Plug Nut
8	PB1523	Gun Plug Terminal Female
9	PC1528	Hybrid Gun Plug Body c/w Spring Pins
10	PB1524	Gun Plug 'O' Ring
11	PB1525	Liner Nut

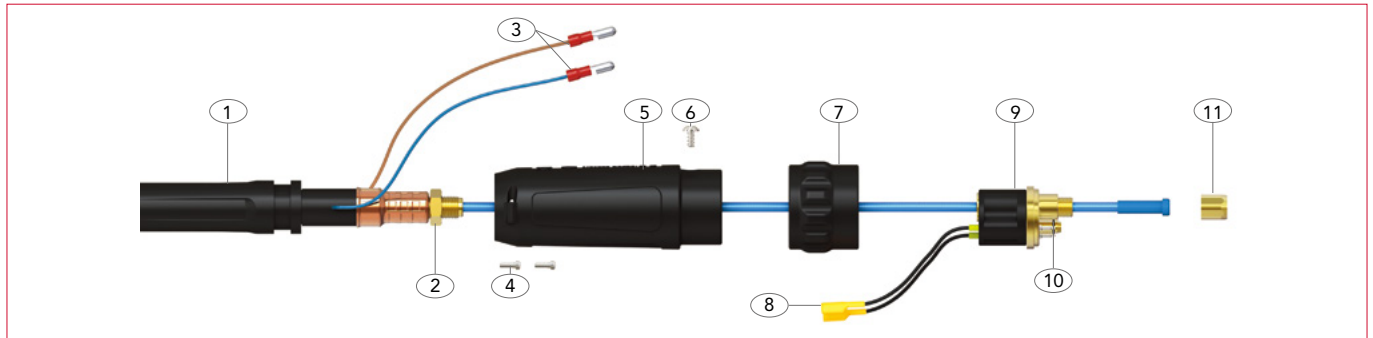

STH 240AE

Part No.	Description	
1	PC2841	Cable Support
2	PB1505	Lock Nut
3	PB1522	Cable Terminal Male
4	SCSP1-1	Gun Plug Housing Screw
5	SC2578/S	Gun Plug Housing c/w Nut
6	PBL1541	Gun Plug Screw
7	PC1519/S	Gun Plug Nut
8	PB1523	Gun Plug Terminal Female
9	PC1528	Hybrid Gun Plug Body c/w Spring Pins
10	PB1524	Gun Plug 'O' Ring
11	PB1525	Liner Nut

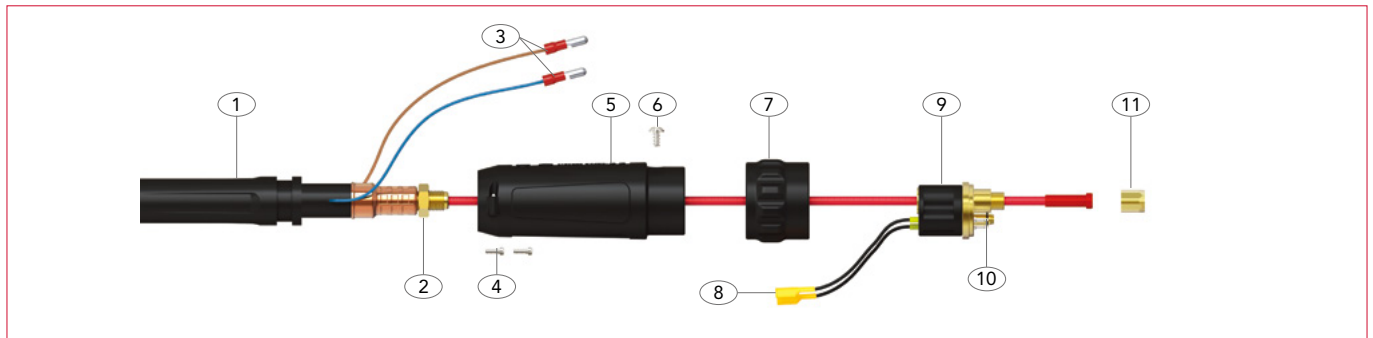



Jinan Export Processing Zone
The East End of Jing Shi Dong Road
Jinan 250102
P.R. China

Tel: +86 531 88239823
Fax: +86 531 88239398
Website: www.parkertorchology.com
Email: info@parkertorchology.com
MPP017 / V.2019.10