

# SCP 60 Suregrip Surecut Plasma Cutting Torch Range

Rating: 60A Air/N<sub>2</sub> gas, @ 60% duty cycle.

Air-Cooled Cutting Torch Range

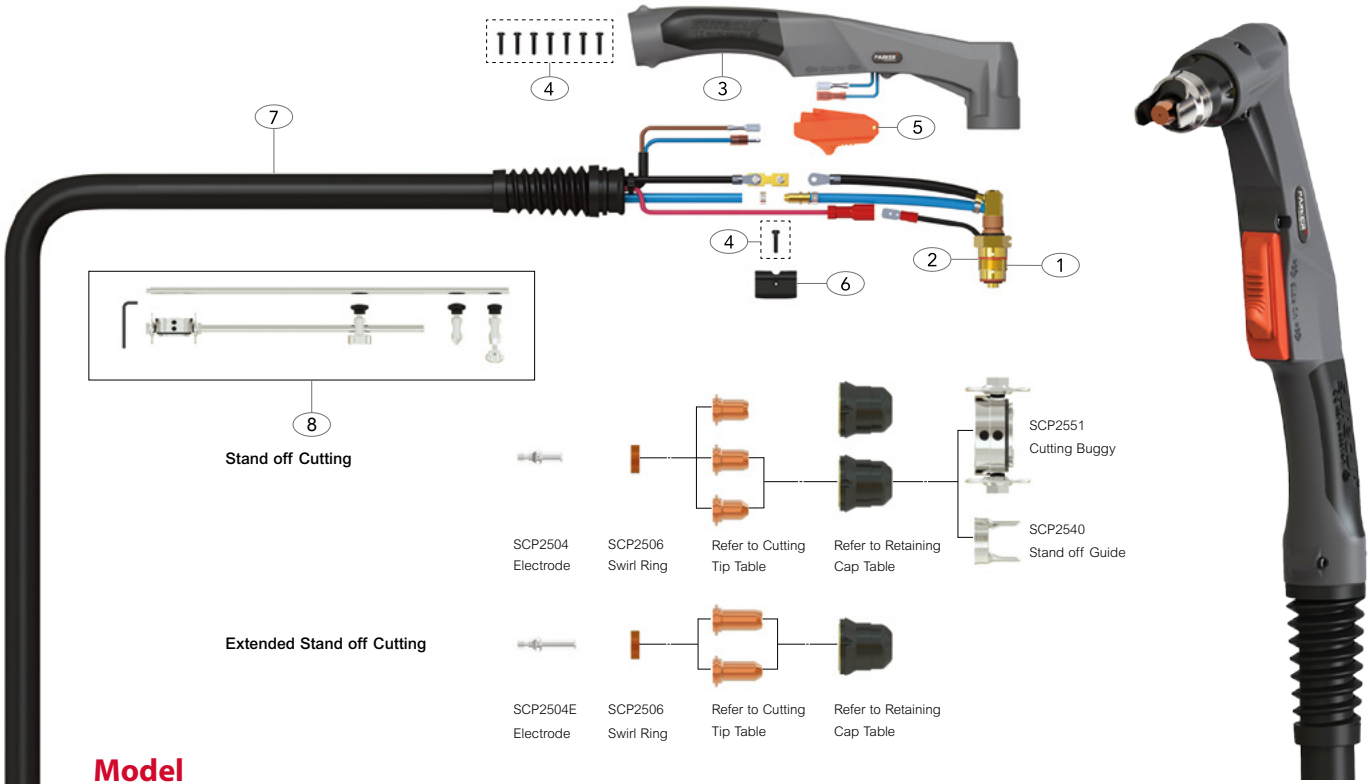

## Model

Description	Part No.	
Suregrip Plasma Cutting Torch Package	4mt	6mt
	SCP60-40-CF2	SCP60-60-CF2

Alternative torch packages can be configured using the configurator on page 12

## Wear Parts

### Cutting Tips

Part No.	Description	Bore $\phi$ A	Amps
SCP2520-06	Cutting Tip	0.65mm	10-20A
*SCP2520-08	Cutting Tip	0.8mm	20-30A
SCP2520-06E	Cutting Tip Extended	0.65mm	10-20A
SCP2520-08E	Cutting Tip Extended	0.8mm	20-30A
SCP2522-09	Cutting Tip Cross Groove	0.9mm	30-40A
SCP2522-09E	Cutting Tip Extended	0.9mm	30-40A
SCP2524-10	Cutting Tip Flat	1.0mm	40-50A
SCP2524-11	Cutting Tip	1.1mm	50-60A

### Retaining Caps

Part No.	Description
*SCP2530-6	Retaining Cap, 6 holes
SCP2530-6L	Retaining Cap, 6 holes Maximum Life

## Spare Parts

Part No.	Description
1	SCP6001 SCP60 70° Torch Head Kit
2	SCP2508 O Ring
3	SCP2514 Plasma Handle Kit
4	SCPSP1 Screw Pack
5	SCP2516 Plasma Safety Trigger
6	SCP2515 Location Block
7	*SCP6019-40-# Cable Assembly Complete x 4mt
	*SCP6019-60-# Cable Assembly Complete x 6mt
8	SCP2550 Circle Cutting Attachment Kit

CF2

\*Denotes torch package standard wear part set-up  
 For more information please refer to the following sections:  
 •Cable Terminations Page 10  
 •Master Wear Parts Table Page 24-30  
 •Wear Parts Configuration Tables Page 31-33