

SCB 90 Suregrip CBR Plasma Cutting Torch Range

Rating: 90A Air/N₂ gas, @ 60% duty cycle.

Air-Cooled Cutting Torch Range

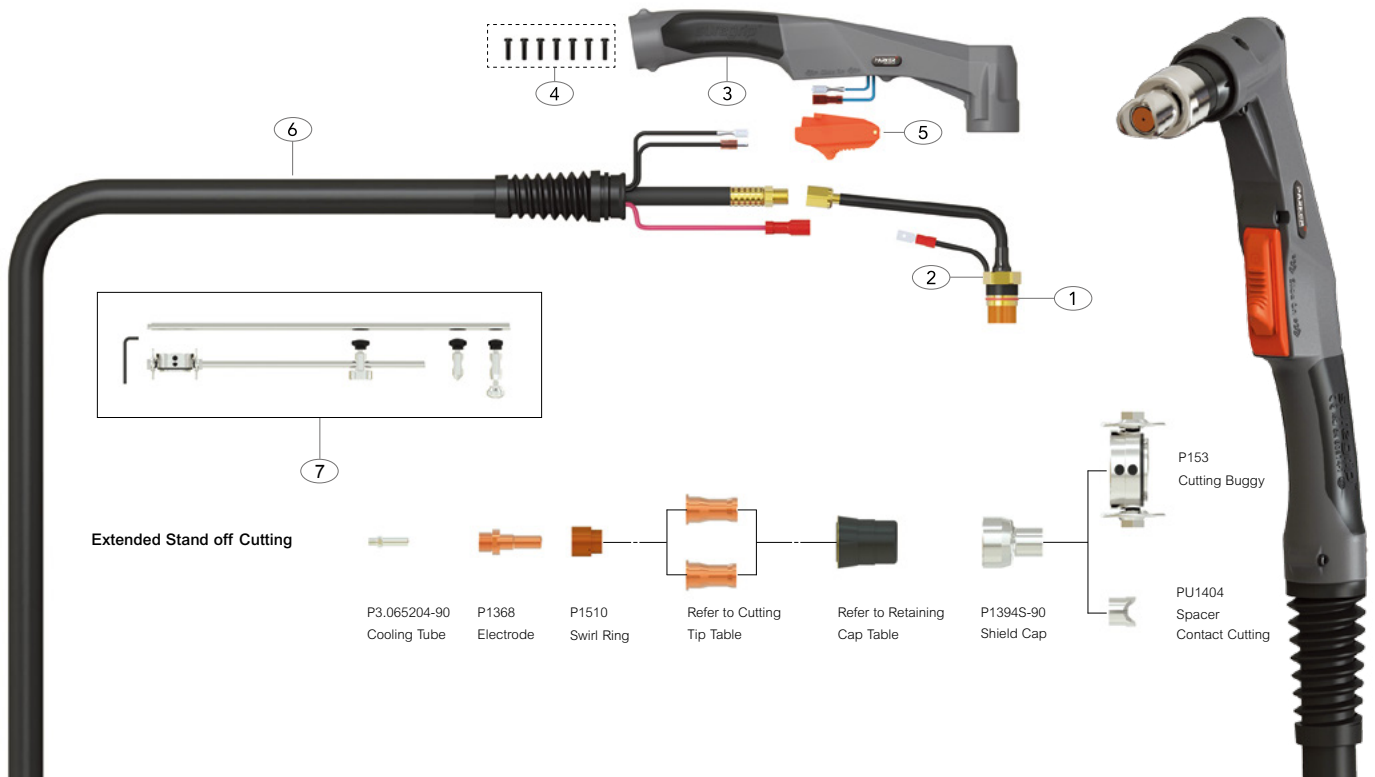

Model

Description	Part No.	
	4mt	6mt
Suregrip CBR Plasma Cutting Torch Package	SCB90-40-CF6	SCB90-60-CF6

Alternative torch packages can be configured using the configurator on page 10

Wear Parts

Cutting Tips

Part No.	Description	Bore Ø A	Amps
SCP9020-10	Cutting Tip Long Life	1.0mm	20-50A
SCP9020-12	Cutting Tip Long Life	1.2mm	50-70A
*SCP9020-13	Cutting Tip Long Life	1.3mm	70-90A

Retaining Caps

Part No.	Description
*P5.710.171-90	Retaining Cap

Spare Parts

Part No.	Description
1	SCP5008 O Ring
2	SCB1358 SCB90 70° Torch Head Kit
3	SCP5014/HF Plasma Handle Kit
4	SCPSP1 Screw Pack
5	SCP2516 Plasma Safety Trigger
6	*SCP9019-40-# Cable Assembly Complete x 4mt
6	*SCP9019-60-# Cable Assembly Complete x 6mt
7	P163 Circle Cutting Attachment Kit

CF6

*Denotes torch package standard wear part set-up
 For more information please refer to the following sections:
 • Cable Terminations Page 9
 • Master Wear Parts Table Page 18-26
 • Wear Parts Configuration Tables Page 27-28