

DSP 250A Duragrip Spool-On Mig/Mag Torch Range

Rating: 230A CO₂, 200A mixed gas, EN60974-7 @ 35% duty cycle. 0.8 to 1.2mm wires

Air-Cooled Mig Welding Torch

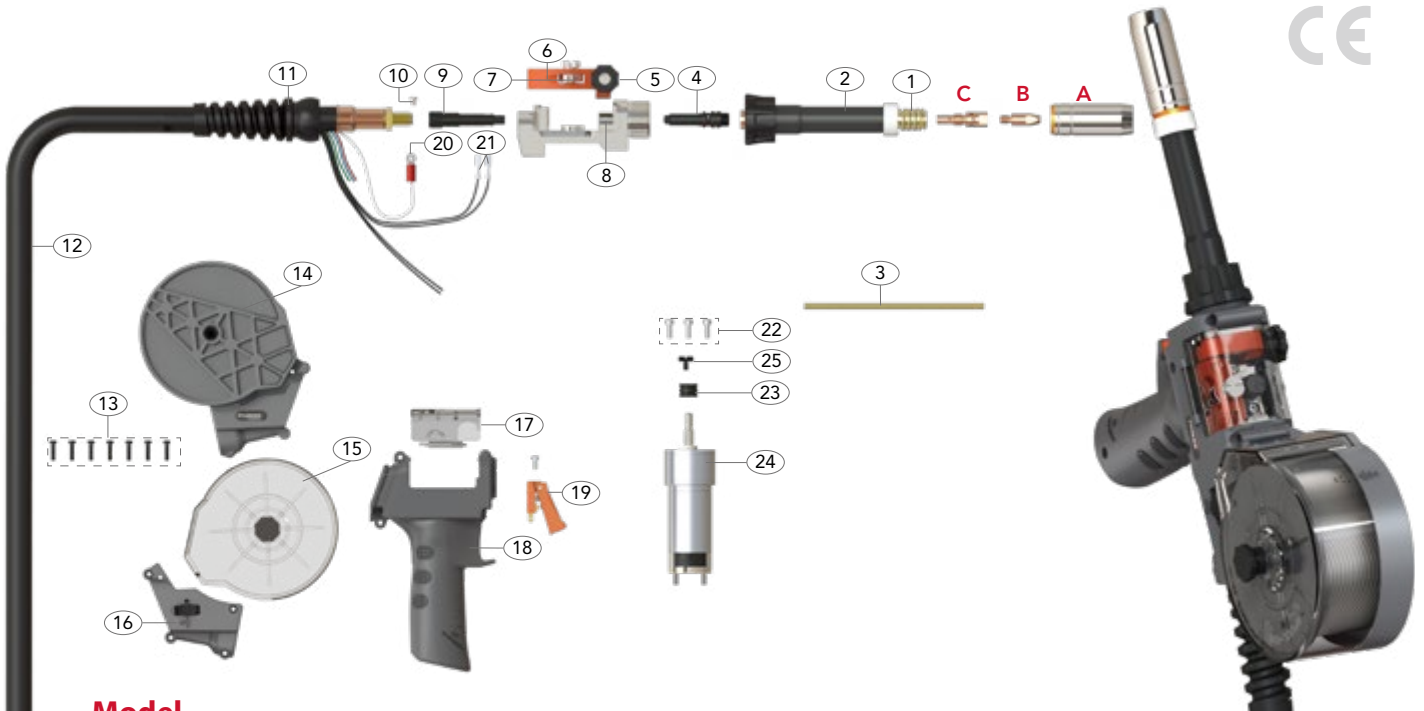

Model

Description	Part No.
	6mt
Spool-On 24V Mig Torch Euro End	DSP250A-24-60ER
Spool-On 42V Mig Torch Euro End	DSP250A-42-60ER
Spool-On 24V Mig Torch Euro End	DSP250A-24-P1-60ER
Spool-On 42V Mig Torch Euro End	DSP250A-42-P1-60ER
Spool-On 24V Mig Torch Surelok End	DSP250A-24-P1-60DN-GS1
Spool-On 42V Mig Torch Surelok End	DSP250A-42-P1-60DN-GS1

Alternative torch packages can be configured using the configurator on page 9

Wear Parts

A Nozzles

Part No.	Description	Wall	Material	Bore
PB2507	Cylindrical Nozzle	1.5mm	Cu	18.0
*PB2508	Conical Nozzle	1.5mm	Cu	15.0
PB2509	Tapered Nozzle	1.5mm	Cu	12.0

B Contact Tips

Part No.	Description	Material	Wire Size	
			mm	Inch
PB2504-08	Contact Tip	Cu	0.8	0.030
PB2504-09	Contact Tip	Cu	0.9	0.035
PB2504-10	Contact Tip	Cu	1.0	0.040
PB2504-12	Contact Tip	Cu	1.2	0.045
*PB2504-10A	Contact Tip	Cu	1.0	0.040
PB2505-08	Contact Tip	CuCrZr	0.8	0.030
PB2505-09	Contact Tip	CuCrZr	0.9	0.035
PB2505-10	Contact Tip	CuCrZr	1.0	0.040
PB2505-10A	Contact Tip	CuCrZr	1.0	0.040
PB2505-12A	Contact Tip	CuCrZr	1.2	0.045

C Tip Adaptors

Part No.	Description	Material
*PB2506	Tip Adaptor	Brass
PB2536	Tip Adaptor M8	Brass

*Denotes torch package standard wear part set-up
For more information please refer to the following sections:
•Master Wear Parts Table Page 18-20
•Rear-End / Cable Parts Page 21

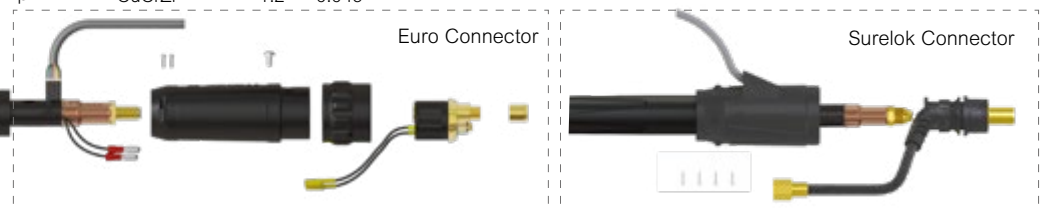

DSP 250A Duragrip Spool-On Mig/Mag Torch Range

Rating: 230A CO₂, 200A mixed gas, EN60974-7 @ 35% duty cycle. 0.8 to 1.2mm wires

Air-Cooled Mig Welding Torch



Spare Parts

Part No.	Description
1	PB2502 Shroud Spring
2	PSP2501 Straight Neck Assembly
3	PGP3602A Jump Liner
4	PGP36006 Jump Liner Nipple
5	PGP36402B Tension Knob
6	PGP36402 Pressure Arm Assembly
7	PGP36402R Pressure Roll
8	PSP36001 Motor Body
9	PSP36006 Wire Guide
10	SCP2563 Screw
11	PMIG8015 Cable Support
12	DSP2503-60ER Coax Cable Assembly Euro Type
	DSP2503-60DN Coax Cable Assembly Dinse Type
13	PKA3X20 Handle Screw Pack
14	PSP2515SP-B Spool Holder
15	PSP2515SP-C Spool Cover
16	PSP2515SP-PT-1K Wire Speed Control 1K Ω
	PSP2515SP-PT-5K Wire Speed Control 5K Ω
	PSP2515SP-PT-10K Wire Speed Control 10K Ω
	PSP2515SP-PT-25K Wire Speed Control 25K Ω
	PSP2515SP-PT0 No Potentiometer

Part No.	Description
17	PGP2514-C Push-Pull Handle Cover
18	PCSP2515-KJ Spool-On Handle
19	PGP2516 Push-Pull Trigger
20	SCP2597 Circular Cable Terminal
21	PM1521 Cable Terminal
22	PGPMS1 Motor Screw Pack
23	SGP7020W-08 Drive Roll For Steel Wire ϕ 0.8
	SGP7020W-09 Drive Roll For Steel Wire ϕ 0.9
	SGP7020W-10 Drive Roll For Al Wire ϕ 1.0
	SGP7020W-08U Drive Roll For Al Wire ϕ 0.8
	SGP7020W-09U Drive Roll For Al Wire ϕ 0.9
	*SGP7020W-10U Drive Roll For Al Wire ϕ 1.0
	SGP7020W-12U Drive Roll For Al Wire ϕ 1.2
24	SGP7020-24 Motor 24V DC
	SGP7020-42 Motor 42V DC
25	PGP7020-24-4 Screw