

DSP 150A Duragrip Spool-On Mig/Mag Torch Range

Rating: 180A CO₂, 150A mixed gas, EN60974-7 @ 35% duty cycle. 0.8 to 1.0mm wires

Air-Cooled Mig Welding Torch

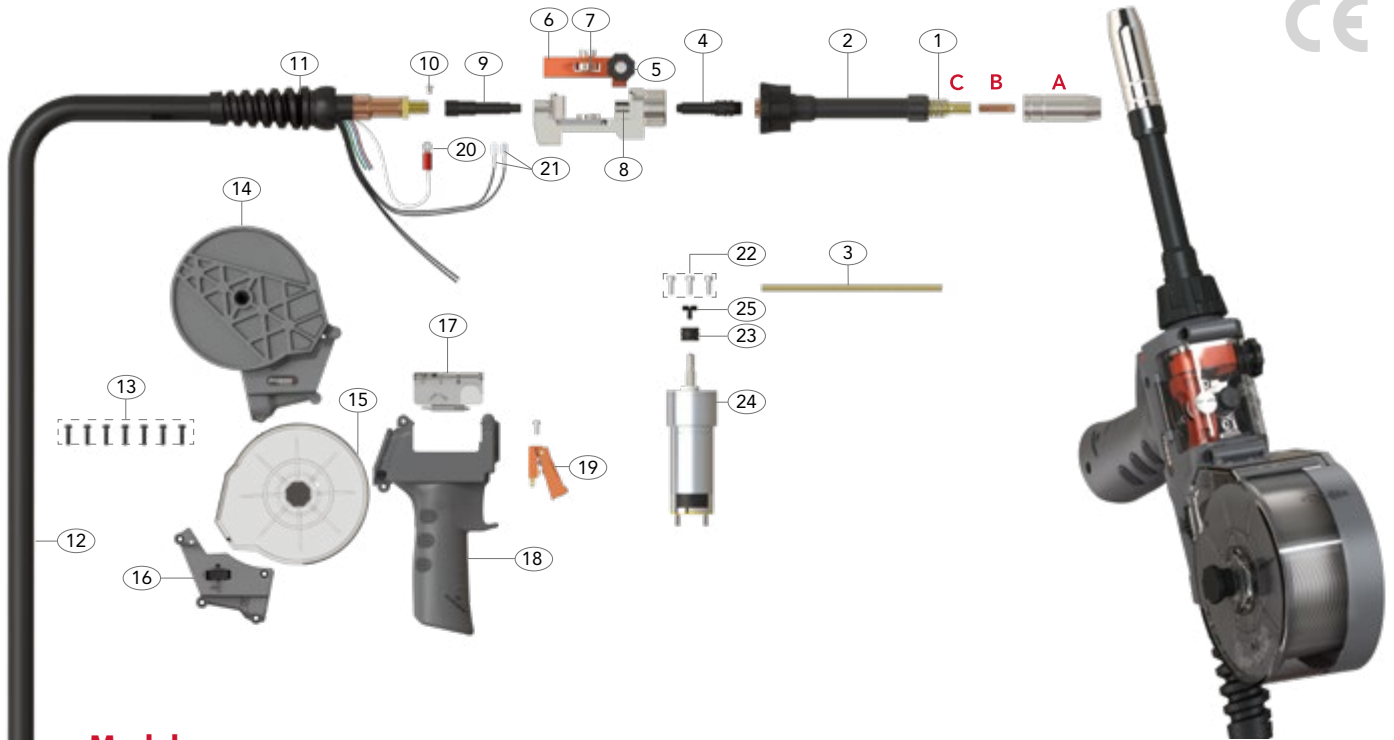

Model

Description	Part No.
	6mt
Spool-On 24V Mig Torch Euro End	DSP150A-24-P1-60ER
Spool-On 42V Mig Torch Euro End	DSP150A-42-P1-60ER
Spool-On 24V Mig Torch Surelok End	DSP150A-24-P1-60DN-GS1
Spool-On 42V Mig Torch Surelok End	DSP150A-42-P1-60DN-GS1

Alternative torch packages can be configured using the configurator on page 9

Wear Parts

A Nozzles

Part No.	Description	Wall	Material	Bore
PB1529	Cylindrical Nozzle	0.9mm	Cu	16.0
*PB1530	Conical Nozzle	0.9mm	Cu	12.0
PB1531	Tapered Nozzle	0.9mm	Cu	10.5
PB1532	Bottle Nozzle	0.9mm	Cu	12.8
PB1533	Spot Welding Nozzle	0.9mm	Cu	16.0

B Contact Tips

Part No.	Description	Material	Wire Size
			mm Inch
*PB1527-08	Contact Tip	Cu	0.8 0.030
PB1527-09	Contact Tip	Cu	0.9 0.035
PB1527-10	Contact Tip	Cu	1.0 0.040

C Tip Adaptors

Part No.	Description	Material
*PB1507L/H	Tip Adaptor Left Hand	Brass

*Denotes torch package standard wear part set-up
For more information please refer to the following sections:
• Master Wear Parts Table Page 18-20
• Rear-End / Cable Parts Page 21

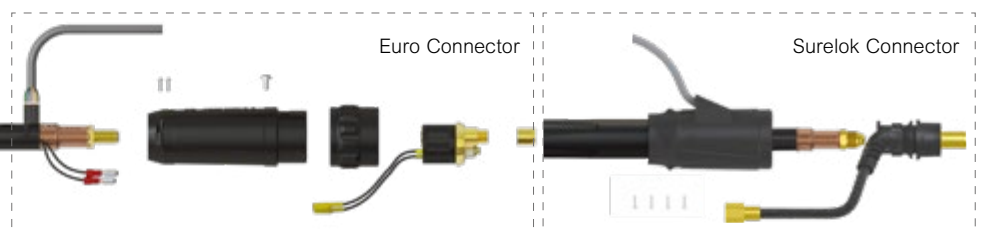

DSP 150A Duragrip Spool-On Mig/Mag Torch Range

Rating: 180A CO₂, 150A mixed gas, EN60974-7 @ 35% duty cycle. 0.8 to 1.0mm wires

Air-Cooled Mig Welding Torch



Spare Parts

Part No.	Description
1	PB1504 Shroud Spring
2	PSP1501 Straight Neck Assembly
3	PSP1502 Jump Liner
4	PGP36006 Jump Liner Nipple
5	PGP36402B Tension Knob
6	PGP36402 Pressure Arm Assembly
7	PGP36402R Pressure Roll
8	PSP36001 Motor Body
9	PSP36006 Wire Guide
10	SCP2563 Screw
11	PMIG8015 Cable Support
12	DSP1517-60ER Coax Cable Assembly Euro Type
	DSP1517-60DN Coax Cable Assembly Dinse Type
13	PKA3X20 Handle Screw Pack
14	PSP2515SP-B Spool Holder
15	PSP2515SP-C Spool Cover
16	PSP2515SP-PT-1K Wire Speed Control 1K Ω
	PSP2515SP-PT-5K Wire Speed Control 5K Ω
	PSP2515SP-PT-10K Wire Speed Control 10K Ω
	PSP2515SP-PT-25K Wire Speed Control 25K Ω
	PSP2515SP-PT0 No Potentiometer

Part No.	Description
17	PGP2514-C Push-Pull Handle Cover
18	PCSP2515-KJ Spool-On Handle
19	PGP2516 Push-Pull Trigger
20	SCP2597 Circular Cable Terminal
21	PB1521 Cable Terminal
22	PGPMS1 Motor Screw Pack
23*	SGP7020W-08 Drive Roll For Steel Wire ϕ 0.8
	SGP7020W-09 Drive Roll For Steel Wire ϕ 0.9
	SGP7020W-10 Drive Roll For Steel Wire ϕ 1.0
	SGP7020W-08U Drive Roll For Al Wire ϕ 0.8
	SGP7020W-09U Drive Roll For Al Wire ϕ 0.9
	SGP7020W-10U Drive Roll For Al Wire ϕ 1.0
24	SGP7020-24 Motor 24V DC
	SGP7020-42 Motor 42V DC
25	PGP7020-24-4 Screw