

DMBP 401W Suregrip Digi-Pull Mig/Mag Torch Range

Rating: 400A CO₂ 350A mixed gas, EN60974-7 @ 100% duty cycle. 1.0 to 1.6mm wires

Liquid-Cooled Mig Welding Torch

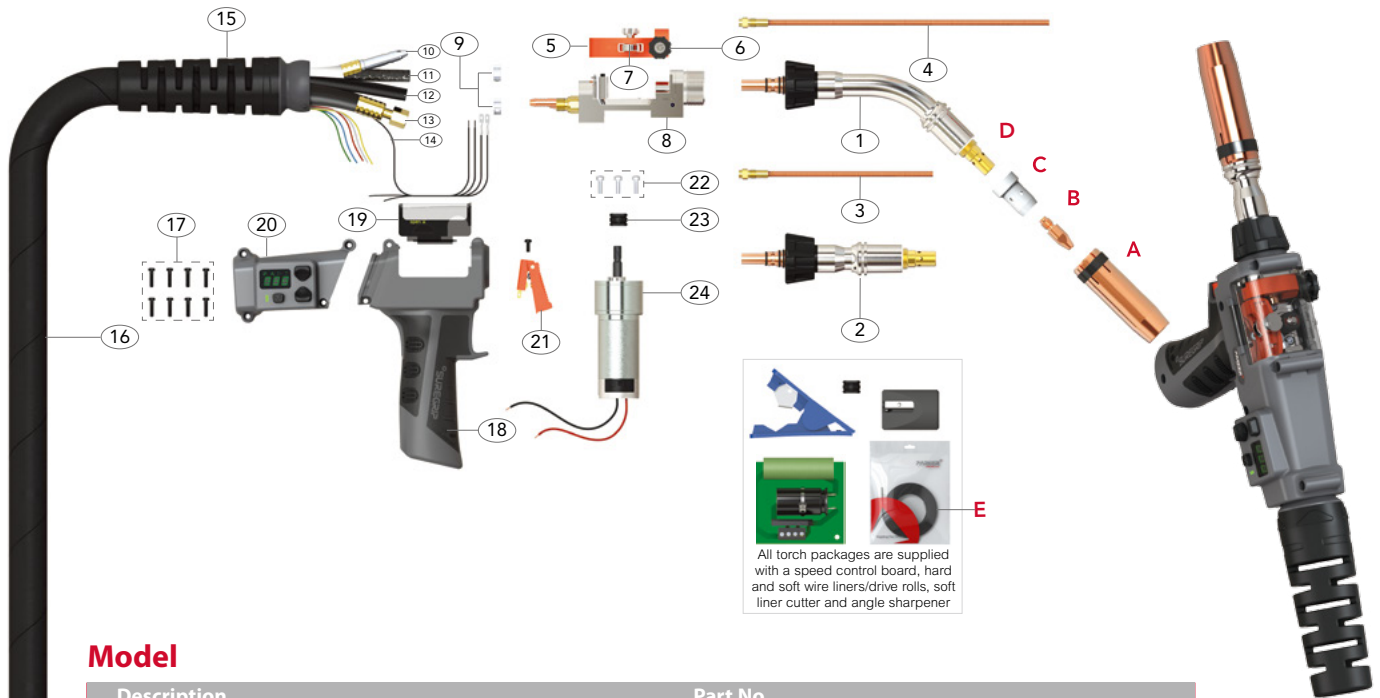

Model

Description	Part No.
	8mt
Suregrip 42V Digi-Pull Mig Torch Package 45° Neck x 8mt	DMBP4001-42-W45-DM3-80ER
Suregrip 42V Digi-Pull Mig Torch Package Straight Neck x 8mt	DMBP4001-42-W180-DM3-80ER
Torch packages can be fitted with an optional wire speed control Potentiometer	

Alternative torch packages can be configured using the configurator on page 11

Wear Parts

A Nozzles

Part No.	Description	Bore	Wall	Material
PB5027	Cylindrical Nozzle	19.0	2.50mm	Cu
*PB5028	Conical Nozzle	16.0	2.50mm	Cu
PB5028HD	Conical Nozzle	16.0	3.20mm	Cu
PB5029	Tapered Nozzle	14.0	2.50mm	Cu

B Contact Tips

Part No.	Description	Material	Wire Size	
			mm	Inch
PB4014-08	Contact Tip	Cu	0.8	0.030
PB4014-10	Contact Tip	Cu	1.0	0.040
PB4014-12	Contact Tip	Cu	1.2	0.045
*PB4014-12A	Contact Tip	Cu	1.2	0.045

C Diffusers

Part No.	Description	Colour	Material
PB5005B	Diffuser	Black	DMC3
*PB5005C	Diffuser	White	Ceramic
PB5005W	Diffuser	White	DMC3
PB5005H	Diffuser High Performance	Black	HPP

D Tip Adaptors

Part No.	Description	Material
*PB5001	Tip Adaptor	Brass
PB5001C-R	Tip Adaptor	CuCrZr

E Liner

Part No.	Description	Length	Wire Size
			mm
*PB2564-80	Polyamide Liner x 8mt	8.6mt	1.0-1.2

Cable Parts

Description	Part No.
	8mt
10 Outer Liner Assembly	PGP4008-80
11 Gas Hose Assembly	PGP36413-80
12 Water Inlet Hose Assembly	PGP40112-80
13 Power Cable Assembly	PGP40115-80
14 Switch Lead Assembly	PGP36410-80
25 Water Outlet Hose	PS5017

*Denotes torch package standard wear part set-up
For more information please refer to the following sections:
• Master Wear Parts Table Page 20-25
• Rear-End / Cable Parts Page 26

DMBP 401W Suregrip Digi-Pull Mig Torch Range

Rating: 400A CO₂, 350A mixed gas, EN60974-7 @ 100% duty cycle. 1.0 to 1.6mm wires

Liquid-Cooled Mig Welding Torch



Spare Parts

Part No.	Description
1	SGP4011 Swan Neck Assembly 45°
2	SGP4011A Straight Neck Assembly
3	PGP4002A Jump Liner c/w Nipple
4	PGP4002 Jump Liner c/w Nipple
5	PGP36402 Pressure Arm Assembly
6	PGP36402B Tension Knob
7	PGP36402R Pressure Roll
8	PGP40101 Motor Body
9	PB5041 Water Hose Clamp 8.7mm
15	PPG3208 Handle Cable Support
16	PGP36419-80 Canvas Cover Assembly
17	PKA3X20 Handle Screw Pack
18	PGP2515/KJ Logi Push Pull Handle
19	PGP2514/C Push Pull Handle Cover
20	PGP2515DM3 Digi Push Pull Handle / Control Module

Part No.	Description
21	PGP2516 Trigger
22	PGPMS1 Motor Screw Pack
23	SGP8224W-08 Drive Roll For Steel Wire ϕ 0.8
	SGP8224W-09 Drive Roll For Steel Wire ϕ 0.9
	SGP8224W-10 Drive Roll For Steel Wire ϕ 1.0
	SGP8224W-12 Drive Roll For Steel Wire ϕ 1.2
	SGP8224W-16 Drive Roll For Steel Wire ϕ 1.6
	SGP8224W-08U Drive Roll For Aluminium Wire ϕ 0.8
	SGP8224W-09U Drive Roll For Aluminium Wire ϕ 0.9
	SGP8224W-10U Drive Roll For Aluminium Wire ϕ 1.0
	* SGP8224W-12U Drive Roll For Aluminium Wire ϕ 1.2
	SGP8224W-16U Drive Roll For Aluminium Wire ϕ 1.6
24	SGP8224-24 Motor 24V DC
	SGP8224-42 Motor 42V DC