

SGTCW 17 Suregrip Ergo Tig Torch Range

Rating: 150A DC, 105A AC @ 35% duty cycle. Electrode Size: 1.0-3.2mm / 0.040"-1/8"

Air-Cooled Tig Welding Torch

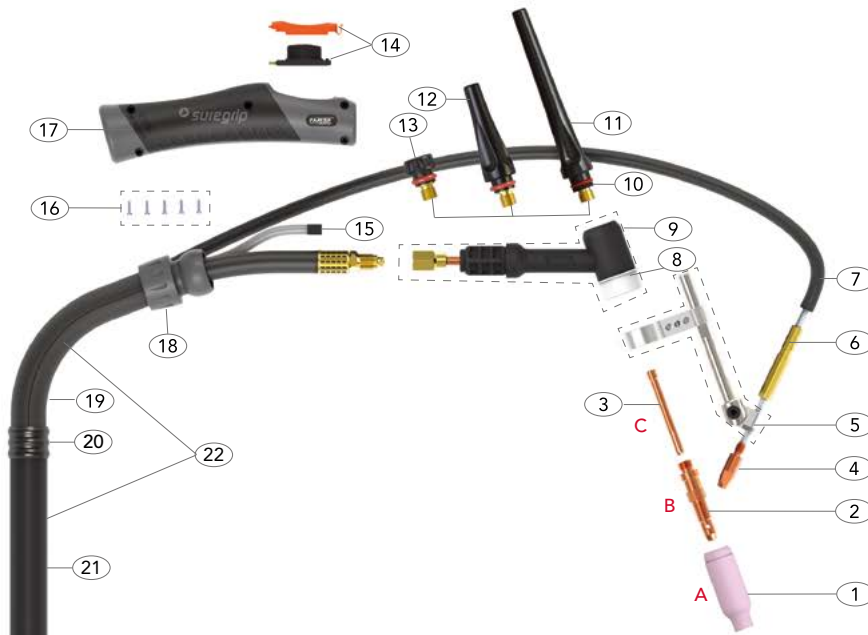

Model

Description	Part No.
Suregrip Ergo Torch Package	4mt
	SGTCW17-S1-12-SL-GS1

Alternative torch packages can be configured using the configurator on page 21

Spare Parts

Part No.	Description
1	P10N47 Standard Ceramic Cup
2	P10N31M Standard Collet Body
3	P10N23M Standard Collet
4	PB2504-10 Ecu Connect Tip 1.0mm
5	PCWT171826-SP Cold Wire Adaptor Assembly
6	PHWT-SP03 Tip Adaptor
7	PPA6X8BK-40 Outer Liner Assembly x 12.5ft
	PPA6X8BK-80 Outer Liner Assembly x 25ft
8	PCW18CG CWT Nozzle Gasket
9	PCW17 Torch Body CWT
10	P98W18 Back Cap 'O' Ring
11	P57Y02 Back Cap Long
12	P300M Back Cap Medium
13	P57Y04 Back Cap Short

Part No.	Description
14	PER1MS Momentary Kit
15	PERSWL4 Trigger Lead 12.5ft
	PERSWL8 Trigger Lead 25ft
16	PERSP1 Screw Pack
17	PERH100 Suregrip Small Ergo Tig Handle
18	PERKJ100 Small Knuckle Joint and Lock Nut
19	PERLC100-08 Leather Cover x 0.8mt
20	PCWJK 100 Jointing Repair Kit
21	PERNCS-32 Neoprene Cover x 3.2m
	PERNCS-72 Neoprene Cover x 7.2m
22	PERCO100-40 Sheath x 12.5ft inc Leather Cover
	PERCO100-80 Sheath x 25ft inc Leather Cover

For more information please refer to the following sections:

- Master Wear Parts Table Pages 51-57
- Wear Parts Configuration Table Pages 58-63
- Rear-End / Cable Parts Pages 64-66



SGTCW 17 Suregrip Ergo Tig Torch Range

Rating: 150A DC, 105A AC @ 35% duty cycle. Electrode Size: 1.0-3.2mm / 0.040"-1/8"

Air-Cooled Tig Welding Torch

Wear Parts

A Standard Ceramic Cups

Part No.	Description	Size	BoreA	
			mm	inch
P10N44	Standard Ceramic Cup	12	19	3/4
P10N45	Standard Ceramic Cup	10	16	5/8
P10N46	Standard Ceramic Cup	8	12.5	1/2
P10N47	Standard Ceramic Cup	7	11	7/16
P10N48	Standard Ceramic Cup	6	10	3/8
P10N49	Standard Ceramic Cup	5	8	5/16
P10N50	Standard Ceramic Cup	4	6	1/4

B Standard Collet Bodies

Part No.	Description	Electrode Size	
		mm	inch
P10N30	Standard Collet Body	1.0	0.040
P10N31	Standard Collet Body	1.6	1/16
P10N31M	Standard Collet Body	2.0	5/64
P10N32	Standard Collet Body	2.4	3/32
P10N28	Standard Collet Body	3.2	1/8

C Standard Collets

Part No.	Description	Electrode Size	
		mm	inch
P10N22	Standard Collet	1.0	0.040
P10N23	Standard Collet	1.6	1/16
P10N23M	Standard Collet	2.0	5/64
P10N24	Standard Collet	2.4	3/32
P10N25	Standard Collet	3.2	1/8