

MMB 360A Suregrip Multi-Mig/Mag Torch Range

Rating: 320A CO₂, 290A mixed gas, EN60974-7 @ 60% duty cycle. 1.0 to 1.2mm wires

Air-Cooled Mig Welding Torch

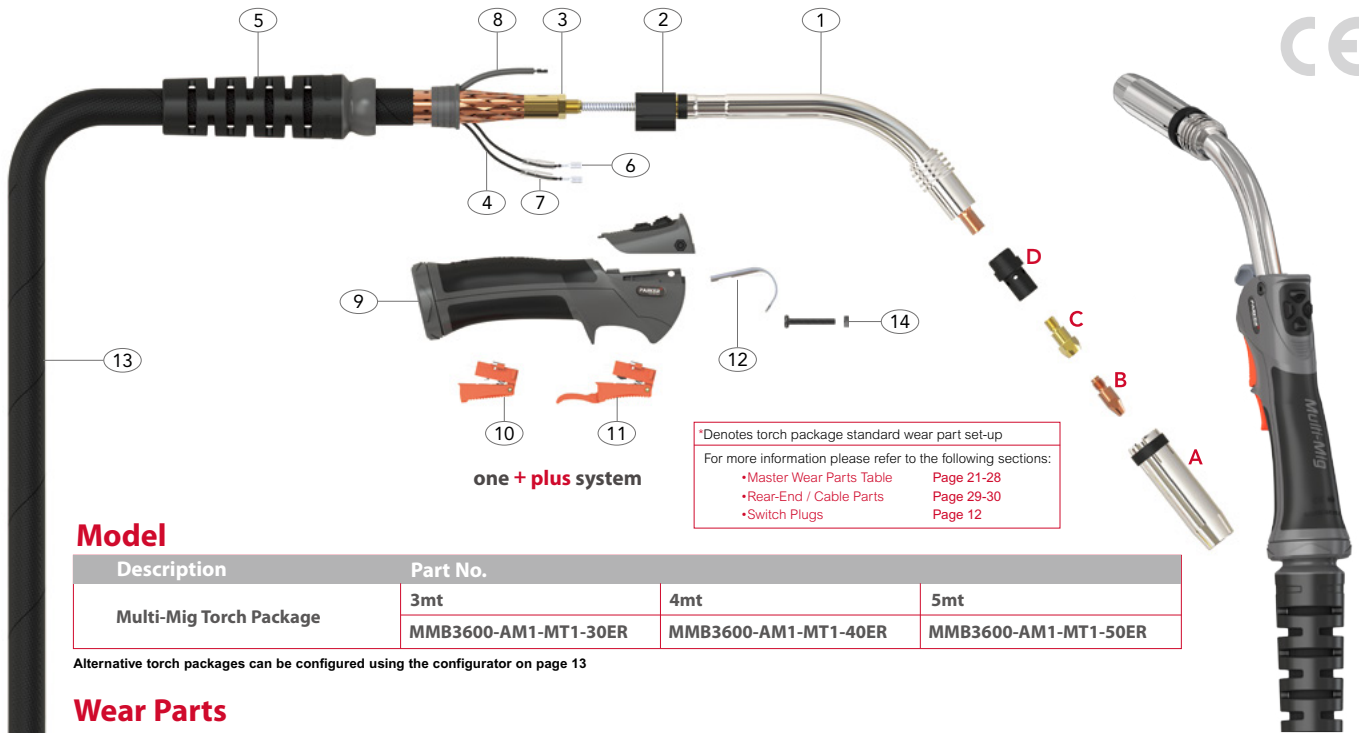

*Denotes torch package standard wear part set-up
For more information please refer to the following sections:

- Master Wear Parts Table Page 21-28
- Rear-End / Cable Parts Page 29-30
- Switch Plugs Page 12

Model

Description	Part No.		
	3mt	4mt	5mt
Multi-Mig Torch Package	MMB3600-AM1-MT1-30ER	MMB3600-AM1-MT1-40ER	MMB3600-AM1-MT1-50ER

Alternative torch packages can be configured using the configurator on page 13

Wear Parts

A Nozzles

Part No.	Description	Bore	Wall	Material
PB3615	Cylindrical Nozzle	19.0	2.25mm	Cu
*PB3616	Conical Nozzle	16.1	2.25mm	Cu
PB3617	Tapered Nozzle	12.0	2.25mm	Cu

B Contact Tips

Part No.	Description	Material	Wire Size	
			mm	Inch
PB2504-10	Contact Tip	Cu	1.0	0.040"
PB2504-12	Contact Tip	Cu	1.2	0.045"
PB2504-10A	Contact Tip	Cu	1.0	0.040"
PB2505-10	Contact Tip	CuCrZr	1.0	0.040"
PB2505-12	Contact Tip	CuCrZr	1.2	0.045"
PB4014-08	Contact Tip	Cu	0.8	0.030
PB4014-10	Contact Tip	Cu	1.0	0.040
*PB4014-12	Contact Tip	Cu	1.2	0.045

C Tip Adaptors

Part No.	Description	Material
PB3612	Tip Adaptor	Brass
PB3613	Tip Adaptor	Brass
*PB3614	Tip Adaptor	Brass

D Diffusers

Part No.	Description	Colour	Material
*PB3605B	Diffuser	Black	DMC3
PB3605C	Diffuser	White	Ceramic
PB3605W	Diffuser	White	DMC3

E Liner

Part No.	Description	Length	Wire Size
			mm
*PB2524-30	Steel Liner x 3mt	3.4mt	1.0-1.2
*PB2524-40	Steel Liner x 4mt	4.4mt	1.0-1.2
*PB2524-50	Steel Liner x 5mt	5.4mt	1.0-1.2

Spare Parts

Part No.	Description
1	PG3603 Swan Neck Assembly
2	PG1515 Ergo Handle Location Body
3	PB1505 Lock Nut
4	PS5010-30 Switch Lead Assembly x 3mt
	PS5010-40 Switch Lead Assembly x 4mt
	PS5010-50 Switch Lead Assembly x 5mt
5	PG3208 Handle Cable Support
6	PB1521 Cable Terminal
7	PB1521-C Cable Terminal Cover
8	UMSWL3 Control Wire Assembly x 3mt
	UMSWL4 Control Wire Assembly x 4mt
	UMSWL5 Control Wire Assembly x 5mt
9	MT2514/KJ Multi-Mig Handle Kit
10	DGB2516 Standard Trigger Assembly
11	DGB2516L Extended Trigger Assembly
12	PB2517 Hanger Hook
13	PM3609-30 Canvas Cover Assembly x 3mt
	PM3609-40 Canvas Cover Assembly x 4mt
	PM3609-50 Canvas Cover Assembly x 5mt
14	PDMNS Module Retaining Screw