

SGP 360A Suregrip Pull-Mig/Mag Torch Range

Rating: Long Neck+M8 Tip: 300A CO₂ 270A mixed gas, EN60974-7 @ 60% duty cycle. 0.8 to 1.2mm wires
Short Neck+M8 Tip: 270A CO₂ 250A mixed gas, EN60974-7 @ 60% duty cycle. 0.8 to 1.2mm wires

Air-Cooled Mig Welding Torch

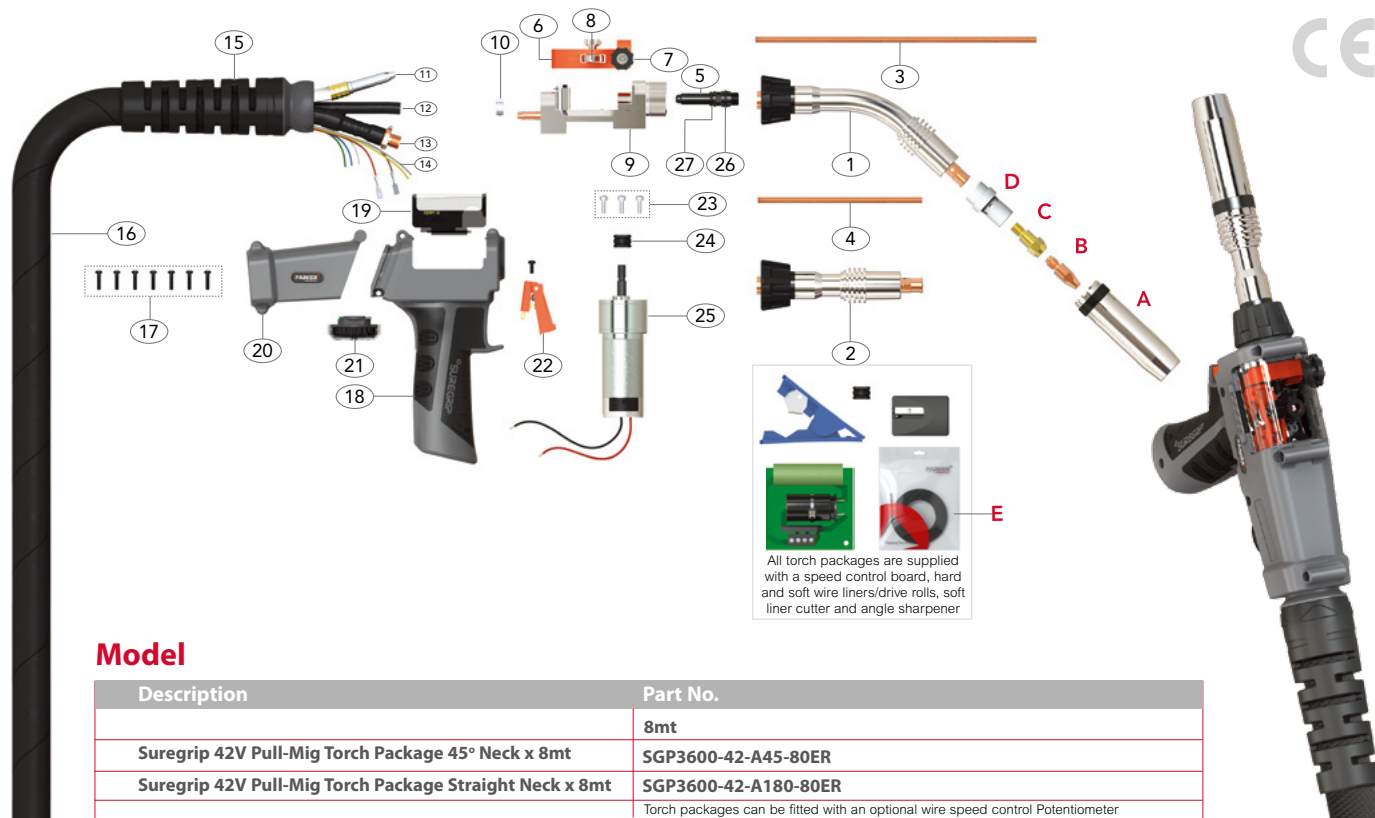

All torch packages are supplied with a speed control board, hard and soft wire liners/drive rolls, soft liner cutter and angle sharpener

Model

Description	Part No.
	8mt
Suregrip 42V Pull-Mig Torch Package 45° Neck x 8mt	SGP3600-42-A45-80ER
Suregrip 42V Pull-Mig Torch Package Straight Neck x 8mt	SGP3600-42-A180-80ER
Torch packages can be fitted with an optional wire speed control Potentiometer	

Alternative torch packages can be configured using the configurator on page 11

Wear Parts

A Nozzles

Part No.	Description	Bore	Wall	Material
PB3615	Cylindrical Nozzle	19.0	2.25mm	Cu
*PB3616	Conical Nozzle	16.1	2.25mm	Cu
PB3617	Tapered Nozzle	12.0	2.25mm	Cu

D Diffusers

Part No.	Description	Colour	Material
PB3605B	Diffuser	Black	DMC3
*PB3605C	Diffuser	White	Ceramic
PB3605W	Diffuser	White	DMC3

B Contact Tips

Part No.	Description	Material	Wire Size
			mm Inch
PB2504-08	Contact Tip	Cu	0.8 0.030
PB2504-10	Contact Tip	Cu	1.0 0.040
PB2504-12	Contact Tip	Cu	1.2 0.045
PB2504-10A	Contact Tip	Cu	1.0 0.040
PB4014-08	Contact Tip	Cu	0.8 0.030
PB4014-10	Contact Tip	Cu	1.0 0.040
PB4014-12	Contact Tip	Cu	1.2 0.045
*PB4014-12A	Contact Tip	Cu	1.2 0.045

E Liner

Part No.	Description	Length	Wire Size
			mm
*PB2564-80	Polyamide Liner x 8mt	8.6mt	1.0-1.2

C Tip Adaptors

Part No.	Description	Material
PB3612	Tip Adaptor	Brass
PB3613	Tip Adaptor	Brass
*PB3614	Tip Adaptor	Brass

Cable Parts

Description	Part No.
	8mt
11 Outer Liner Assembly	PGP3608-80
12 Gas Hose Assembly	PGP36413-80
13 Power Cable Assembly	PGP36015-80
14 Switch Lead Assembly	PGP36410-80

*Denotes torch package standard wear part set-up
For more information please refer to the following sections:
•Master Wear Parts Table Page 20-24
•Rear-End / Cable Parts Page 25

SGP 360A Suregrip Pull-Mig/Mag Torch Range

Rating: Long Neck+M8 Tip: 300A CO₂ 270A mixed gas, EN60974-7 @ 60% duty cycle. 0.8 to 1.2mm wires

Short Neck+M8 Tip: 270A CO₂ 250A mixed gas, EN60974-7 @ 60% duty cycle. 0.8 to 1.2mm wires

Air-Cooled Mig Welding Torch

Spare Parts

Part No.	Description
1	SGP3603 Swan Neck Assembly 45°
2	SGP3603A Straight Neck Assembly
3	PGP3602 Jump Liner
4	PGP3602A Jump Liner
5	PGP36006 Jump Liner Nipple
6	PGP36402 Pressure Arm Assembly
7	PGP36402B Tension Knob
8	PGP36402R Pressure Roll
9	PGP36001 Motor Body
10	PB5041 Water Hose Clamp 8.7mm
15	PGP3208 Handle Cable Support
16	PGP36419-80 Canvas Cover Assembly
17	PKA3X20 Handle Screw Pack
18	PGP2515/KJ Push Pull Handle Assembly
19	PGP2514/C Push Pull Handle Cover
20	PGP2515DM0 Push Pull Handle Connector Module
21	PGP0807-1 Potentiometer Kit 1K
	PGP0807-5 Potentiometer Kit 5K
	PGP0807-10 Potentiometer Kit 10K
	PGP0807-25 Potentiometer Kit 25K

Part No.	Description
22	PGP2516 Trigger
23	PGPMS1 Motor Screw Pack
24	SGP8224W-08 Drive Roll For Steel Wire ϕ 0.8
	SGP8224W-09 Drive Roll For Steel Wire ϕ 0.9
	SGP8224W-10 Drive Roll For Steel Wire ϕ 1.0
	SGP8224W-12 Drive Roll For Steel Wire ϕ 1.2
	SGP8224W-16 Drive Roll For Steel Wire ϕ 1.6
	SGP8224W-08U Drive Roll For Aluminium Wire ϕ 0.8
	SGP8224W-09U Drive Roll For Aluminium Wire ϕ 0.9
	SGP8224W-10U Drive Roll For Aluminium Wire ϕ 1.0
	*SGP8224W-12U Drive Roll For Aluminium Wire ϕ 1.2
	SGP8224W-16U Drive Roll For Aluminium Wire ϕ 1.6
25	SGP8224-24 Motor 24V DC
	SGP8224-42 Motor 42V DC
26	9×1.5 O ring
27	7×1.5 O ring

*Note: Rating: 270A CO₂ 250A mixed gas @60% duty cycle when using SG3603A neck